

SF2473D

**435 MHz
SAW Filter**

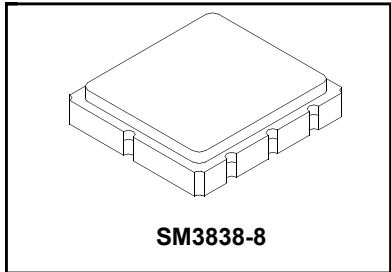

MAXIMUM RATING:

- Input Power Level: 10 dBm
- DC Voltage : 3 V
- Operating Temperature: -40 °C to +85 °C
- Storage Temperature: -40 °C to +85 °C
- Moisture Sensitivity Level: 1

ELECTRICAL CHARACTERISTICS:

Item	Unit	Min.	Typ.	Max.
Center frequency Fc	MHz	-	435	-
Insertion Loss (433~437 MHz) IL	dB	-	2.1	4.2
Amplitude Variation (433~437 MHz)	dB	-	0.2	2.8
Bandwidth BW_{-3dB}	MHz	4	8	10
Group delay variation (433~437 MHz)	ns	-	77	180
Return loss (433~437 MHz)	dB	6.5	16	-
Attenuation (Reference level from 0 dB)				
10 ~ 385 MHz	dB	45	65	-
385 ~ 425 MHz	dB	22	45	-
445 ~ 485 MHz	dB	22	36	-
485 ~ 1000 MHz	dB	45	53	-
Temperature coefficient of frequency	ppm/k	-	-36	-

MEASUREMENT CIRCUIT:

HP Network analyzer

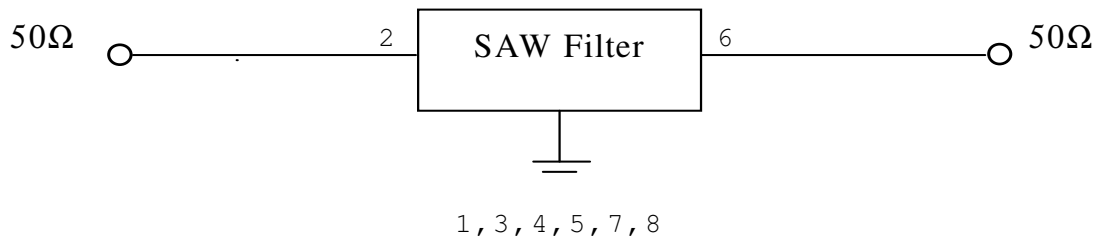

OUTLINE DRAWING:

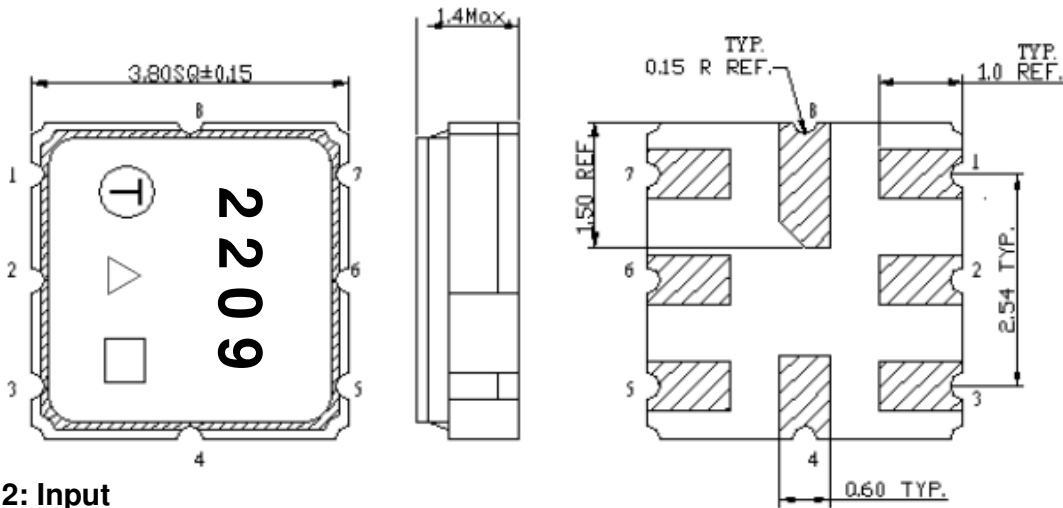

2: Input

6: Output

1, 3, 4, 5, 7, 8: Ground

△ : Year Code

□ : Date Code

Unit: mm

△ Product Year Code

Year	2011	2012
	2013	2014
	2015	2016
	2017	2018
	Product Code	A

Date Code Table:

WK01	WK02	WK03	WK04	WK05	WK06	WK07	WK08	WK09	WK10	WK11	WK12	WK13
A	B	C	D	E	F	G	H	I	J	K	L	M
WK14	WK15	WK16	WK17	WK18	WK19	WK20	WK21	WK22	WK23	WK24	WK25	WK26
N	O	P	Q	R	S	T	U	V	W	X	Y	Z
WK27	WK28	WK29	WK30	WK31	WK32	WK33	WK34	WK35	WK36	WK37	WK38	WK39
a	b	c	d	e	f	g	h	i	j	k	l	m
WK40	WK41	WK42	WK43	WK44	WK45	WK46	WK47	WK48	WK49	WK50	WK51	WK52
n	o	p	q	r	s	t	u	v	w	x	y	z

PCB Footprint:

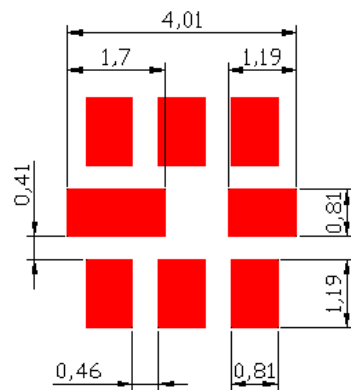

F. Frequency Characteristics:

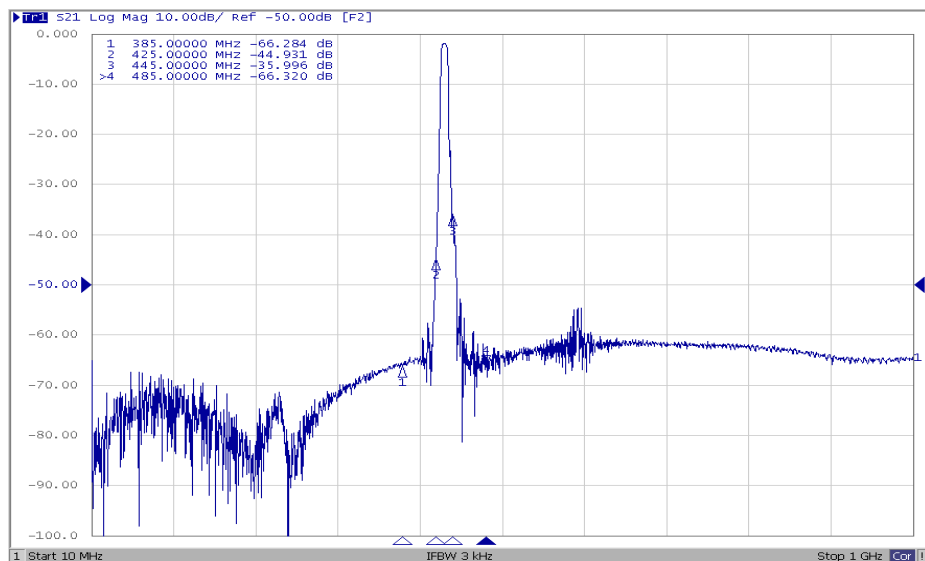
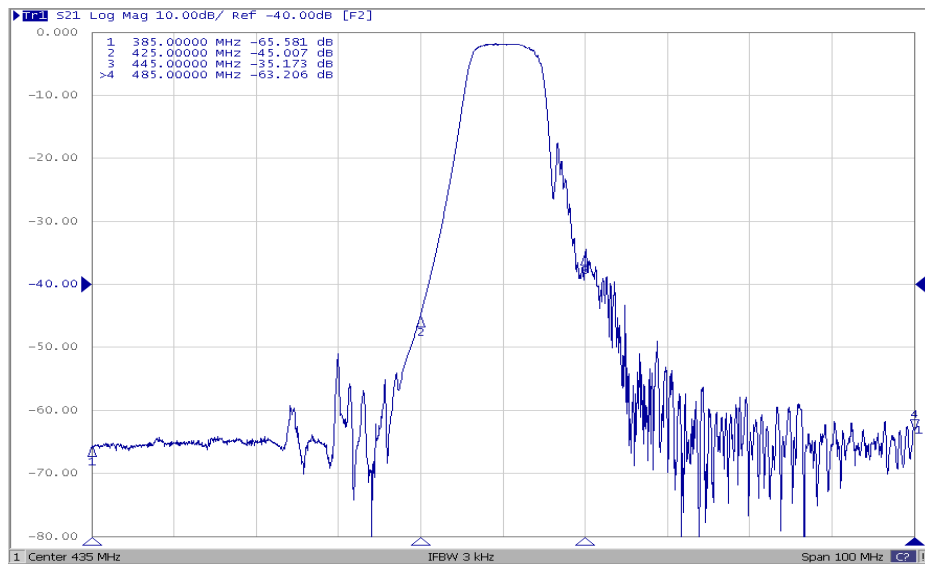
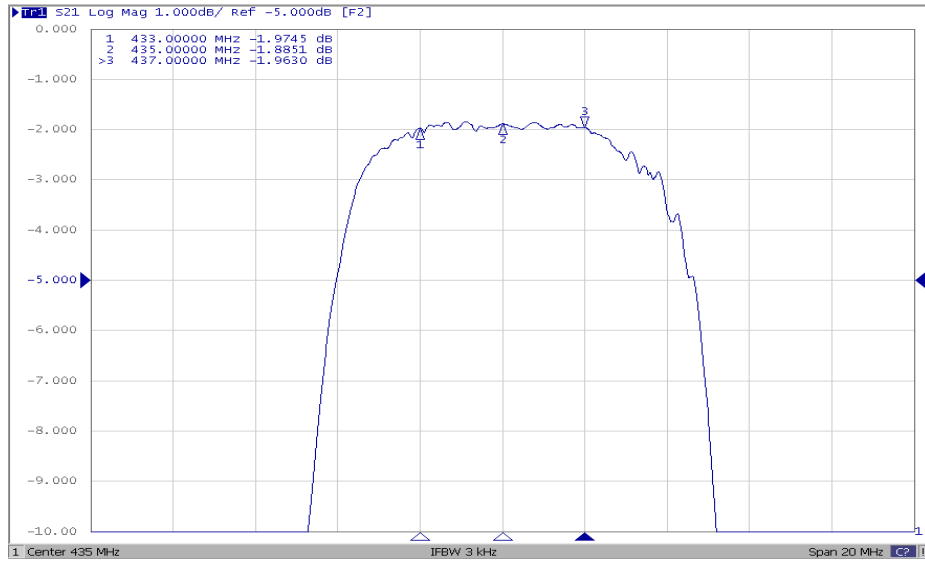

Reflection Functions:

S11

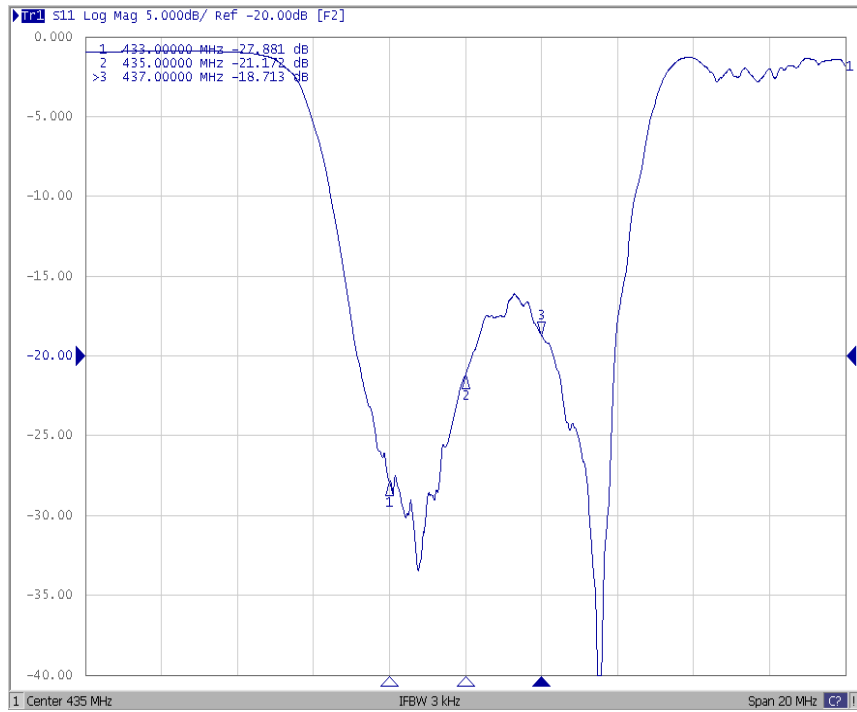

S22

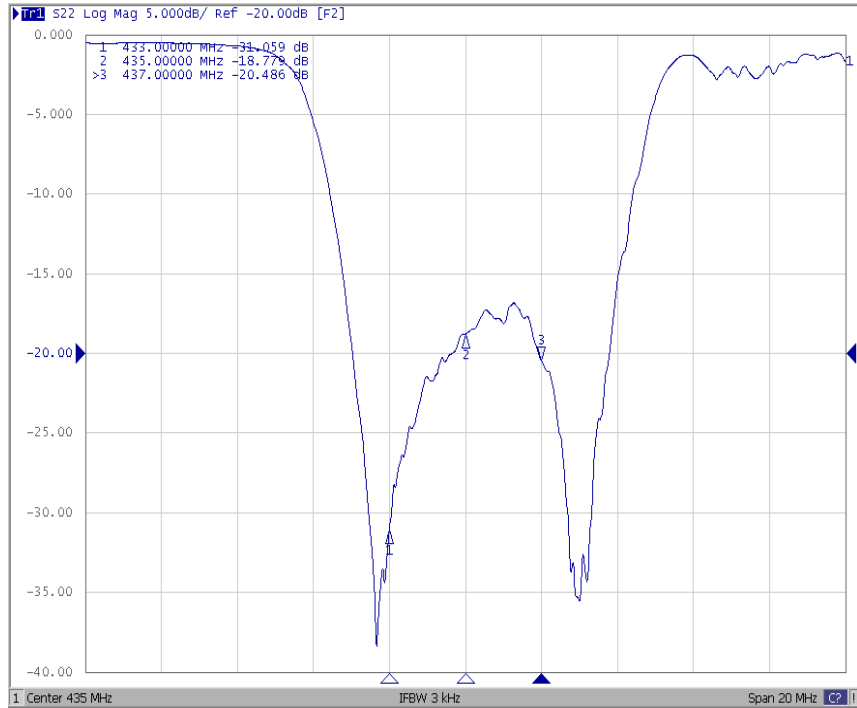

PACKING:

REEL DIMENSION

7" = 500

13" = 1000

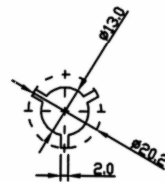
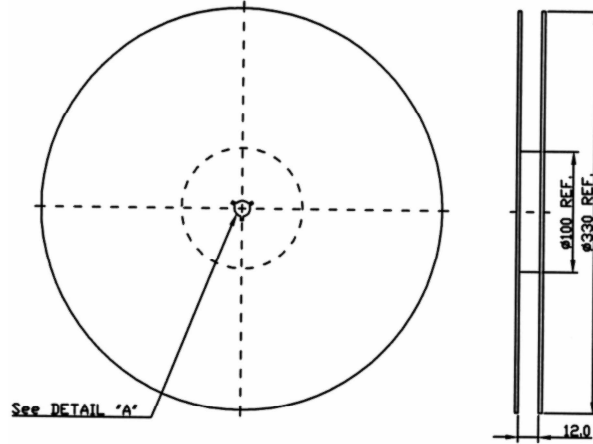

2. TAPE DIMENSION

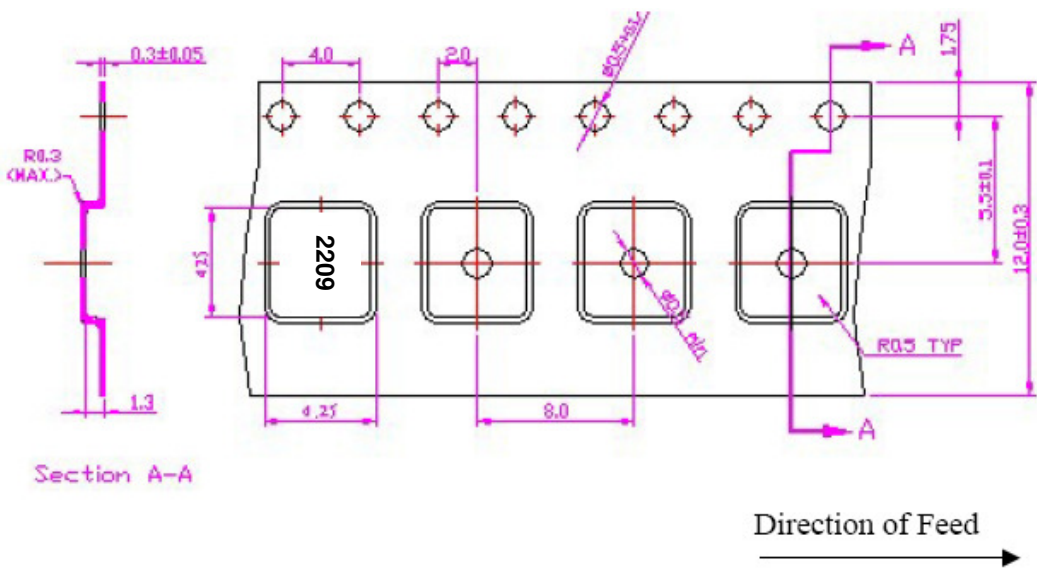

Recommended Reflow Profile:

1. Preheating shall be fixed at 150~180°C for 60~90 seconds.
2. Ascending time to preheating temperature 150°C shall be 30 seconds min.
3. Heating shall be fixed at 220°C for 50~80 seconds and at 260°C+0/-5°C peak (20~40sec).
4. Time: 2 times.

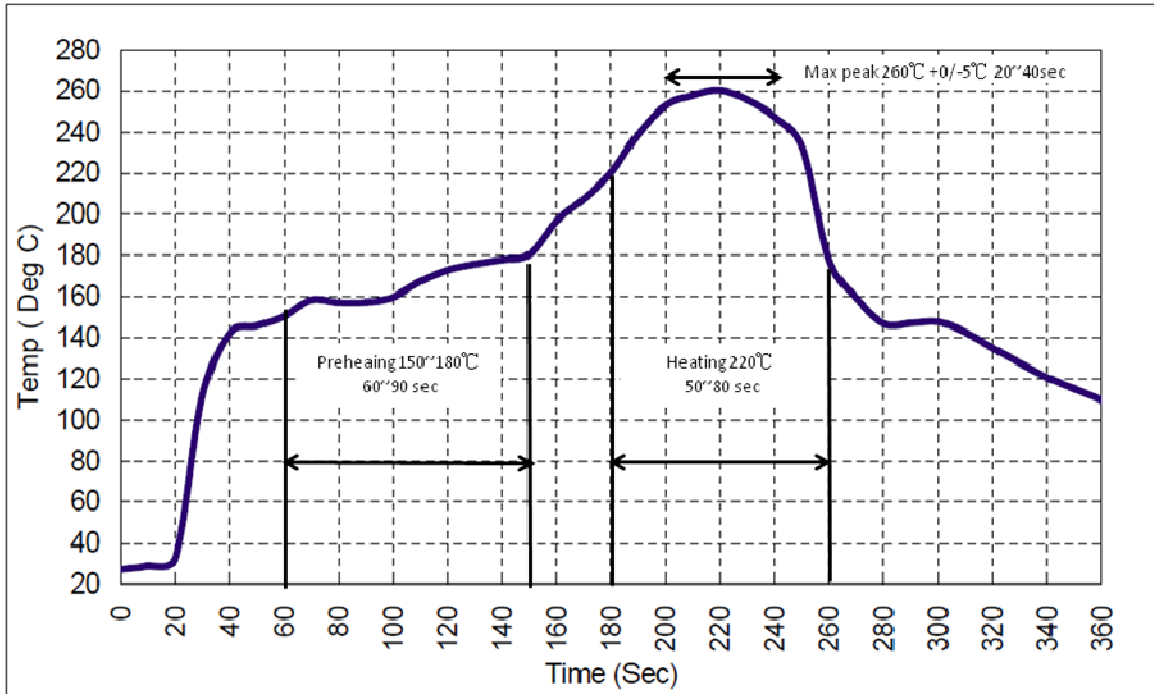

CAUTION: Electrostatic Sensitive Device. Observe precautions for handling.

NOTES:

1. The design, manufacturing process, and specifications of this device are subject to change.
2. US or International patents may apply.
3. RoHS compliant from the first date of manufacture.