

SF2543LA

**1732.5 MHz
SAW Filter**

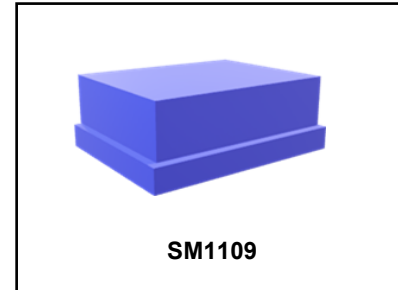

MAXIMUM RATING:

- Maximum Input Power: 10 dBm
- DC voltage: +/-5 V
- Operating Temperature: -40 °C to +85 °C
- Storage Temperature: -40 °C to +85 °C
- Moisture Sensitivity Level: Level 1 (MSL 1)
- ESD: 50 V(MM), 100 V(HBM)
- AEC-Q200 Qualified

ELECTRICAL CHARACTERISTICS:

Terminating source impedance: $Z_s = 50 \Omega$ (Single-ended)

Terminating load impedance: $Z_L = 50 \Omega$ (Single-ended)

Parameters Description	Unit	Min.	Typ.	Max.
Center Frequency Fc	MHz	-	1732.5	-
Insertion Loss (1710~1755 MHz) IL	dB(*1)	-	1.7	2.2
Amplitude Ripple (1710~1755 MHz)	dB _{p-p}	-	0.7	1.4
VSWR (1710~1755 MHz)	-	-	1.7	2.2
Attenuation (Reference level from 0 dB)				
50 ~ 1355 MHz	dB	30	35	-
1574 ~ 1577 MHz	dB	30	40	-
1600 ~ 1680 MHz	dB	18	26	-
1805 ~ 1880 MHz	dB	19	24	-
1930 ~ 1990 MHz	dB	25	35	-
2110 ~ 2170 MHz	dB	34	37	-
2200 ~ 2700 MHz	dB	20	33	-
2700 ~ 3800 MHz	dB	20	29	-
3800 ~ 6000 MHz	dB	10	21	-

(*1) Specification of insertion loss includes loss that comes from the test board.



CAUTION: Electrostatic Sensitive Device. Observe precautions for handling.

NOTES:

1. The design, manufacturing process, and specifications of this device are subject to change.
2. US or International patents may apply.
3. RoHS compliant from the first date of manufacture.

FREQUENCY CHARACTERISTIC:

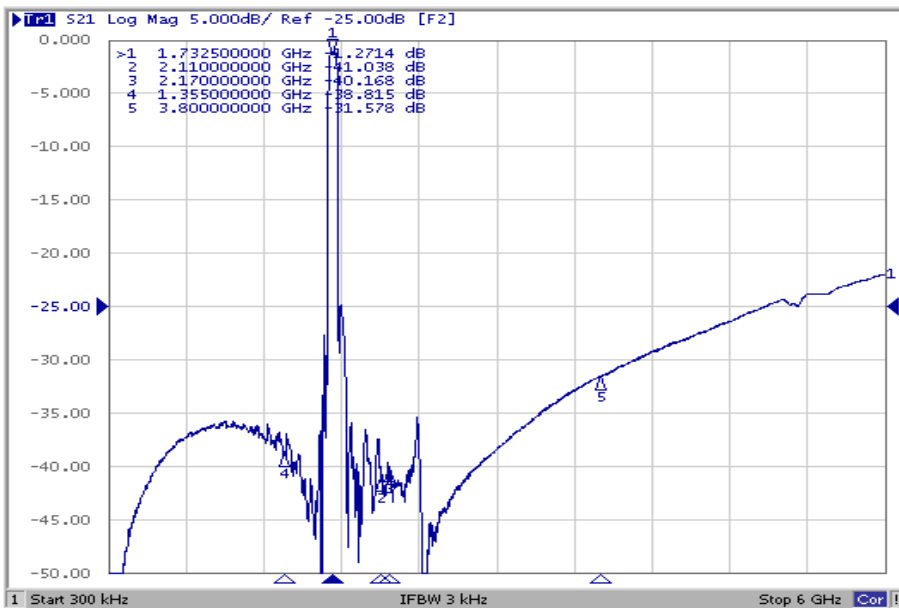
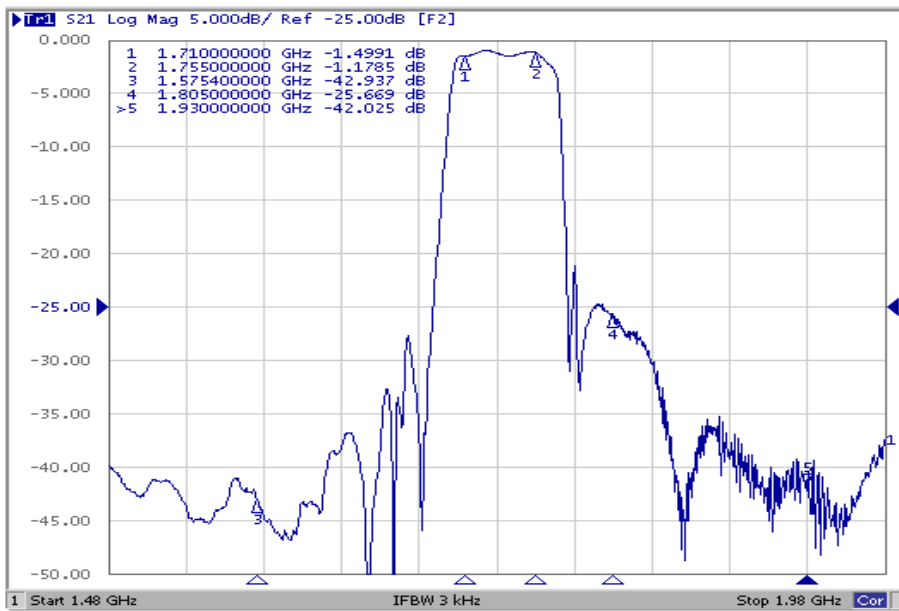
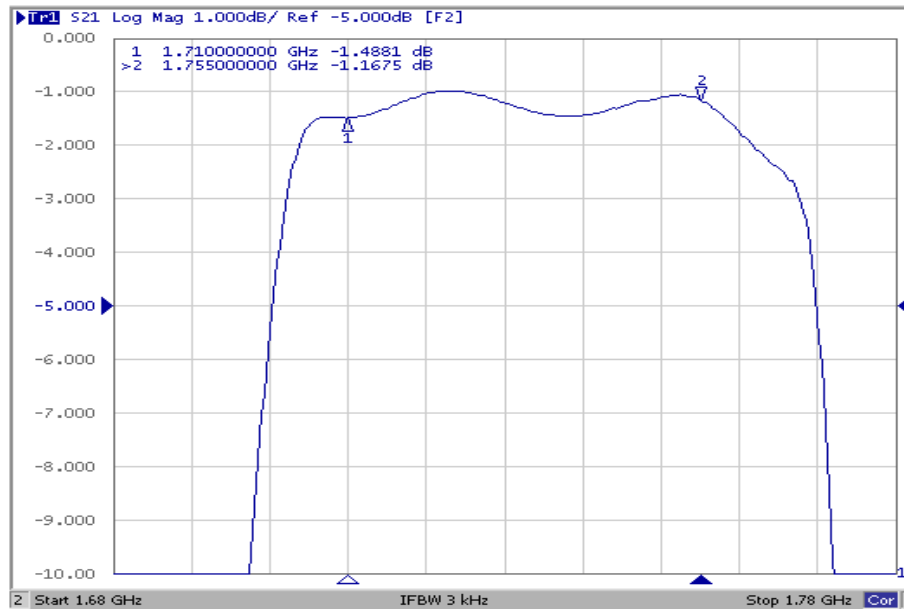

Reflection Functions:

VSWR

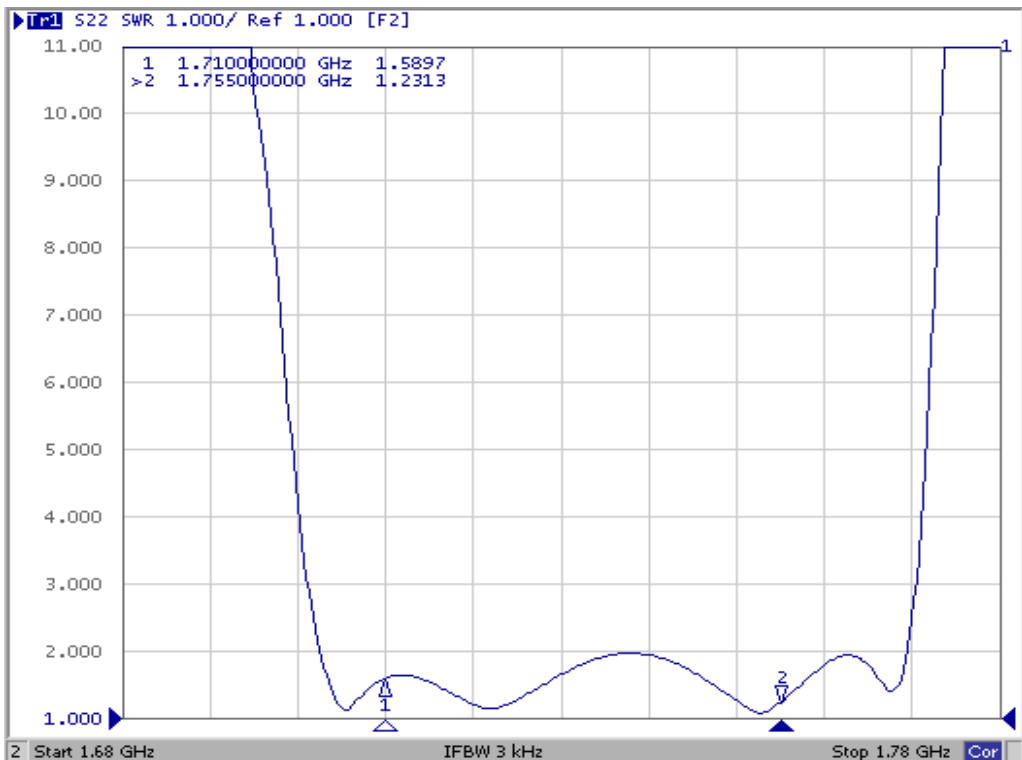
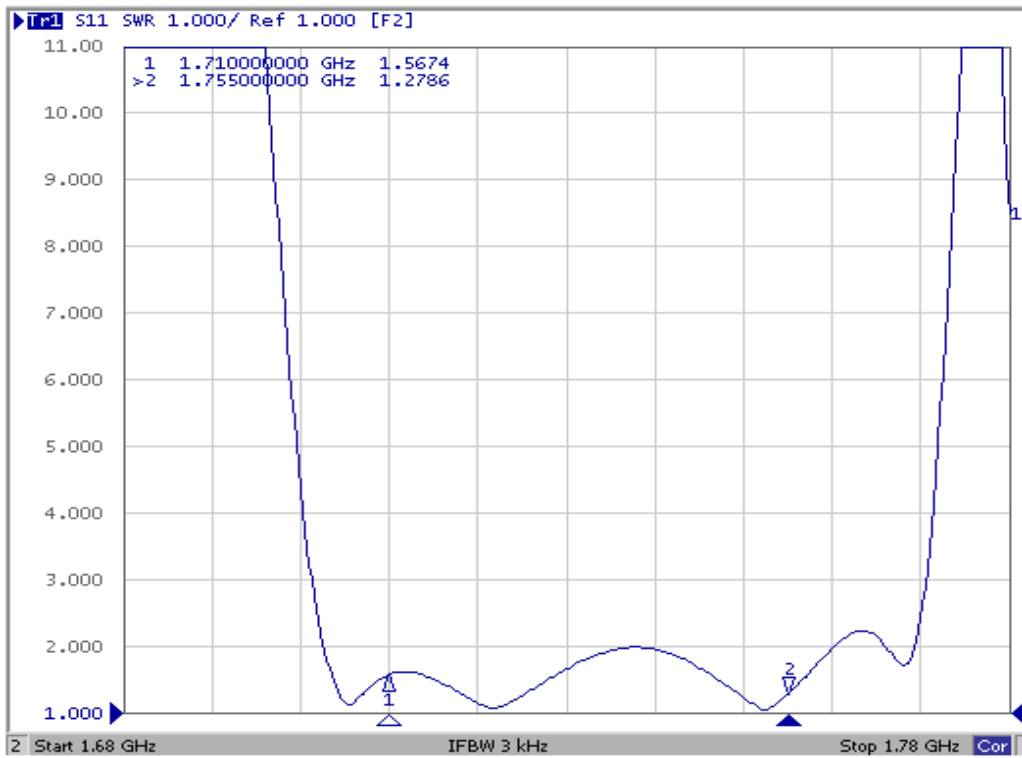

Smith Chart

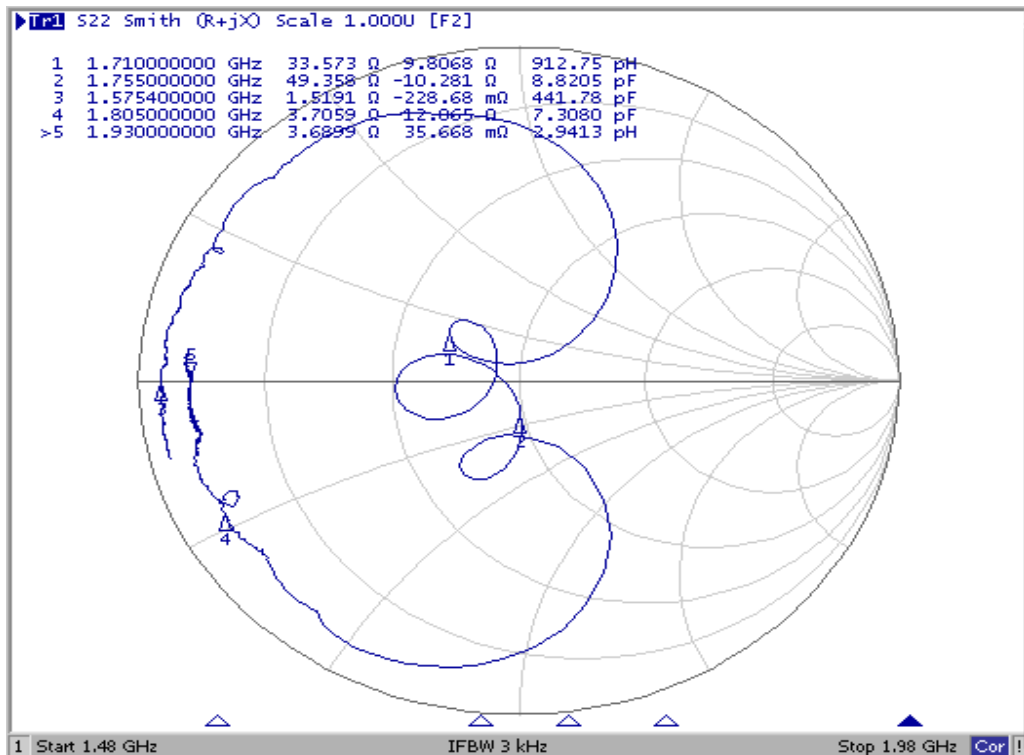
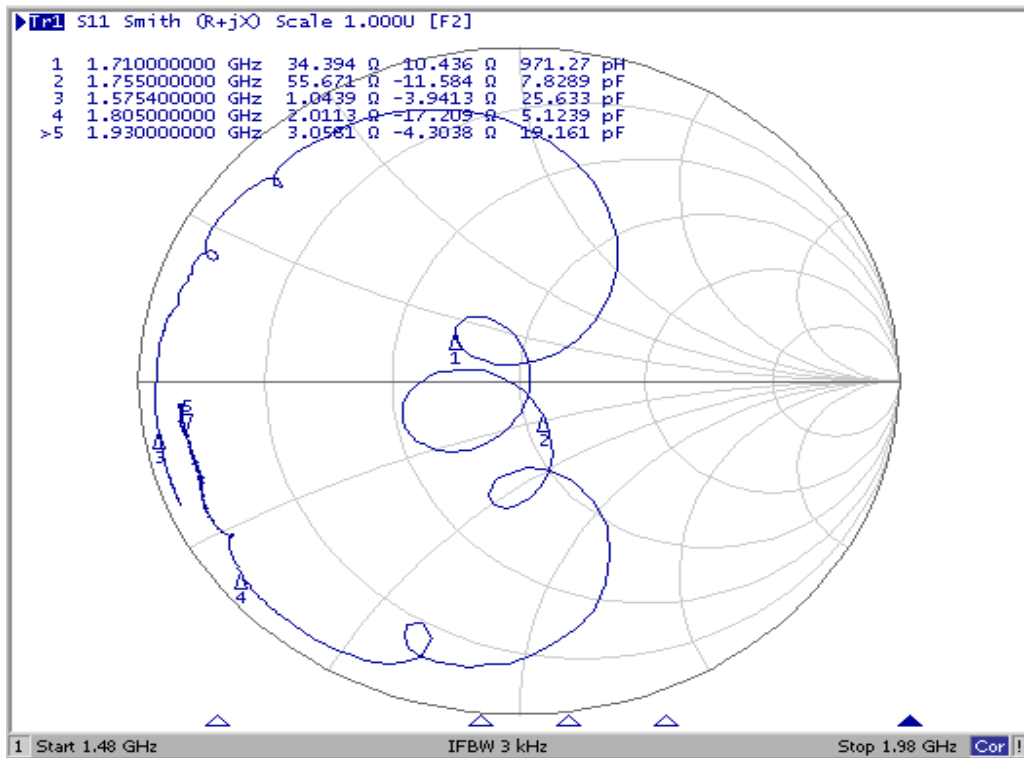

MEASUREMENT CIRCUIT:

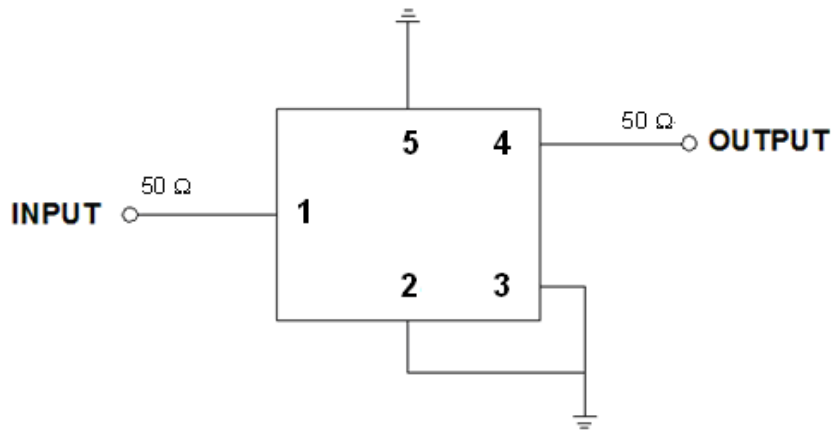

PCB Footprint:

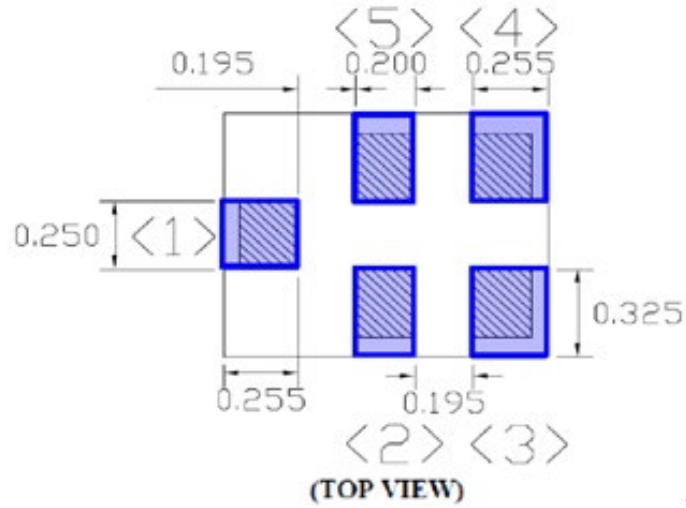

OUTLINE DRAWING:

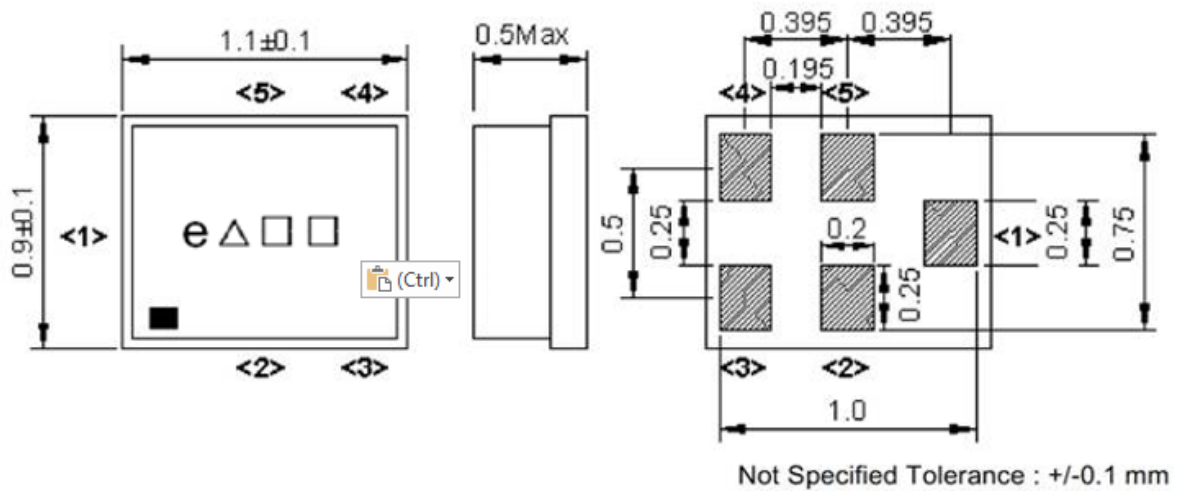

Pin Configuration

Pin No.	Symbol	Function
1	IN	Unbalanced pin
2	GND	Ground
3	GND	Ground
4	OUT	Unbalanced pin
5	GND	Ground

△ : Date Code

□ : Lot No. (Indicated by 0~9 or A to Z and a to z, except I, O, i, o and l)

Date Code:

Year	Jan.	Feb.	Mar.	Apr.	May.	Jun.	Jul.	Aug.	Sep.	Oct.	Nov.	Dec.
2015	a	b	c	d	e	f	g	h	j	k	l	m
2016	n	p	q	r	s	t	u	v	w	x	y	z
2017	A	B	C	D	E	F	G	H	J	K	L	M
2018	N	P	Q	R	S	T	U	∇	W	X	Y	Z

**PACKING
REEL
DIMENSION**

Reel Count:
7" = 3000
13" = 10,000

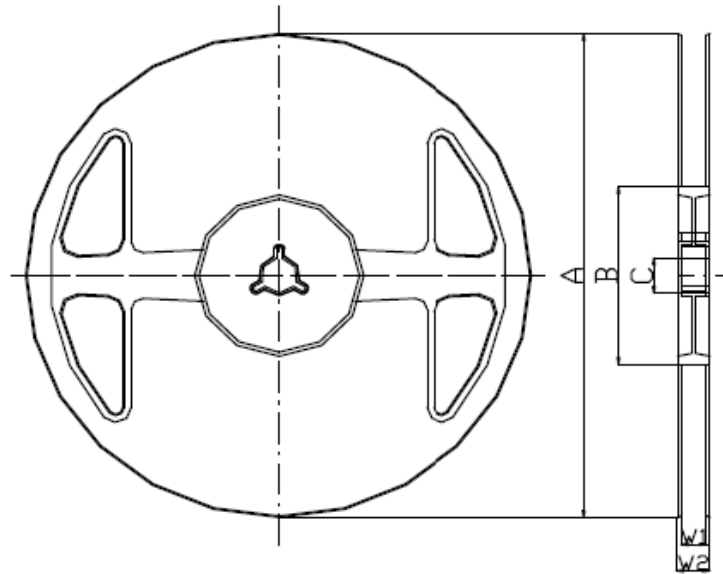

Materials of Reel

Material : Polystyrene + Carbon

Color : Black

Surface resistance (reference value) : $10^9 \Omega/\text{sq}$ Max.

Unit : mm

A	B	C	W1	W2
$\phi 180.0 +0.0/-1.5$	$\phi 66.0 +/-0.5$	$\phi 13.0 +/-0.2$	$9.0 +1.0/-0.0$	$11.4 +/-1.0$

TAPE DIMENSION

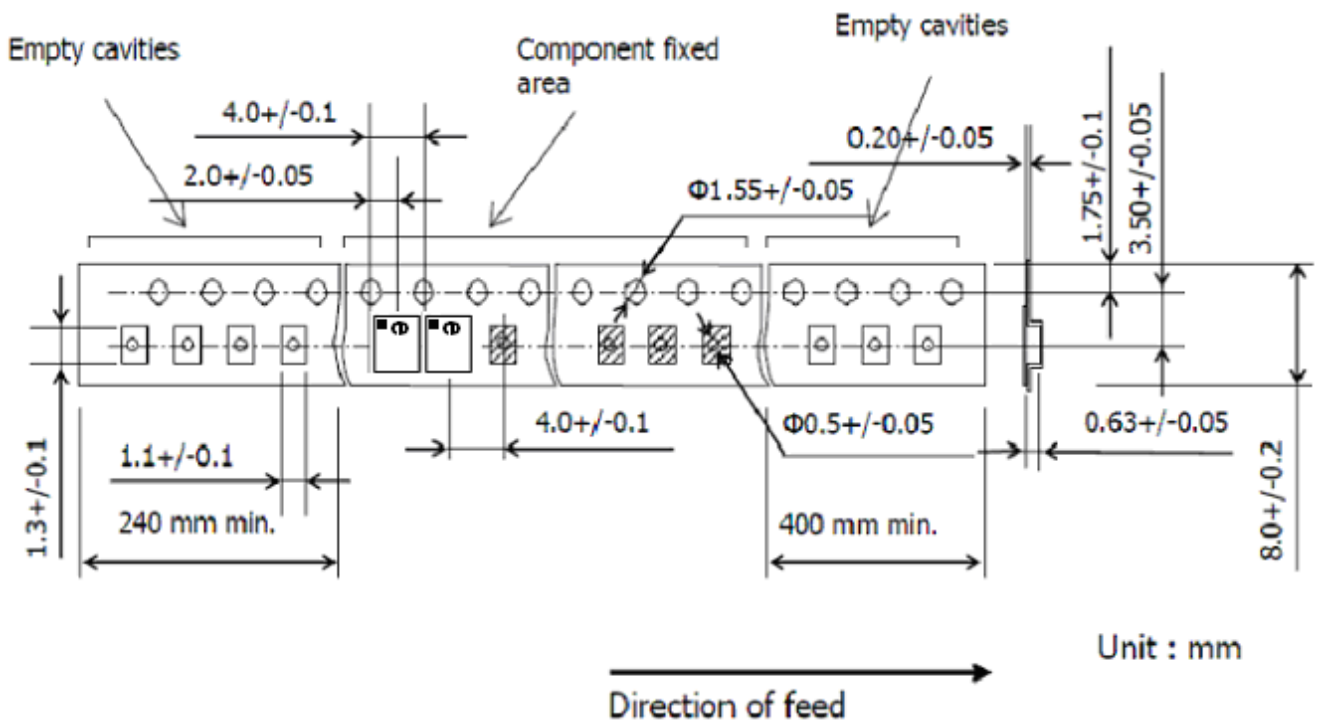

Recommended Reflow Profile

1. Preheating shall be fixed at 150~180°C for 60~90 seconds.
2. Ascending time to preheating temperature 150°C shall be 30 seconds min.
3. Heating shall be fixed at 220°C for 50~80 seconds and at 260°C+0/-5°C peak (20~40sec).
4. Time: 2 times.

