

SF2550LA

**897.5 MHz
SAW Filter**

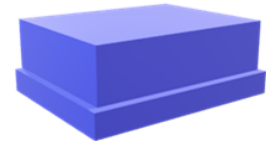

SM1109

MAXIMUM RATING:

- Maximum Input Power: 13 dBm
- DC voltage: 0 V
- Operating Temperature: -40 °C to +85 °C
- Storage Temperature: -40 °C to +85 °C
- Moisture Sensitivity Level: Level 1 (MSL 1)
- ESD: 100 V(MM), 200 V(HBM)
- AEC-Q200 Qualified

ELECTRICAL CHARACTERISTICS:

Terminating source impedance: $Z_s = 50 \Omega$ (Single-ended)

Terminating load impedance: $Z_L = 50 \Omega$ (Single-ended)

Parameters Description	Unit	Min.	Typ.	Max.
Center Frequency F_c	MHz	-	897.5	-
Insertion Loss (880.4~914.6 MHz) IL	dB	-	2.3	2.9
Amplitude Ripple (880.4~914.6 MHz)	dB _{p-p}	-	0.8	1.7
VSWR (880.4~914.6 MHz)	-	-	2.1	2.5
Attenuation (Reference level from 0 dB)				
DC ~ 860 MHz	dB	30	50	-
860 ~ 870 MHz	dB	18	28	-
925.4 ~ 935 MHz	dB	8	18	-
935 ~ 959.4 MHz	dB	24	28	-
1760 ~ 1830 MHz	dB	34	44	-
2640 ~ 2745 MHz	dB	30	39	-

MEASUREMENT CIRCUIT:

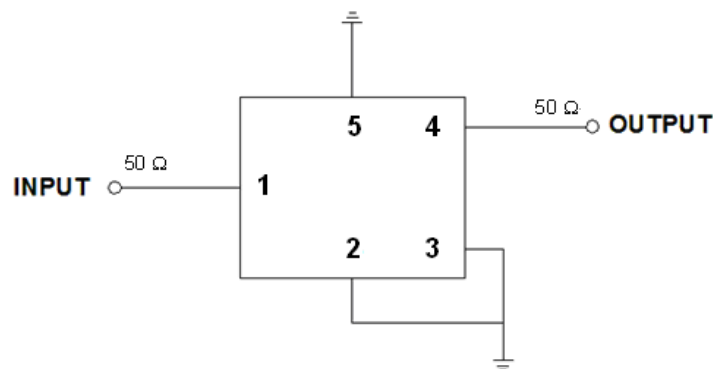



CAUTION: Electrostatic Sensitive Device. Observe precautions for handling.

NOTES:

1. The design, manufacturing process, and specifications of this device are subject to change.
2. US or International patents may apply.
3. RoHS compliant from the first date of manufacture.

FREQUENCY CHARACTERISTIC

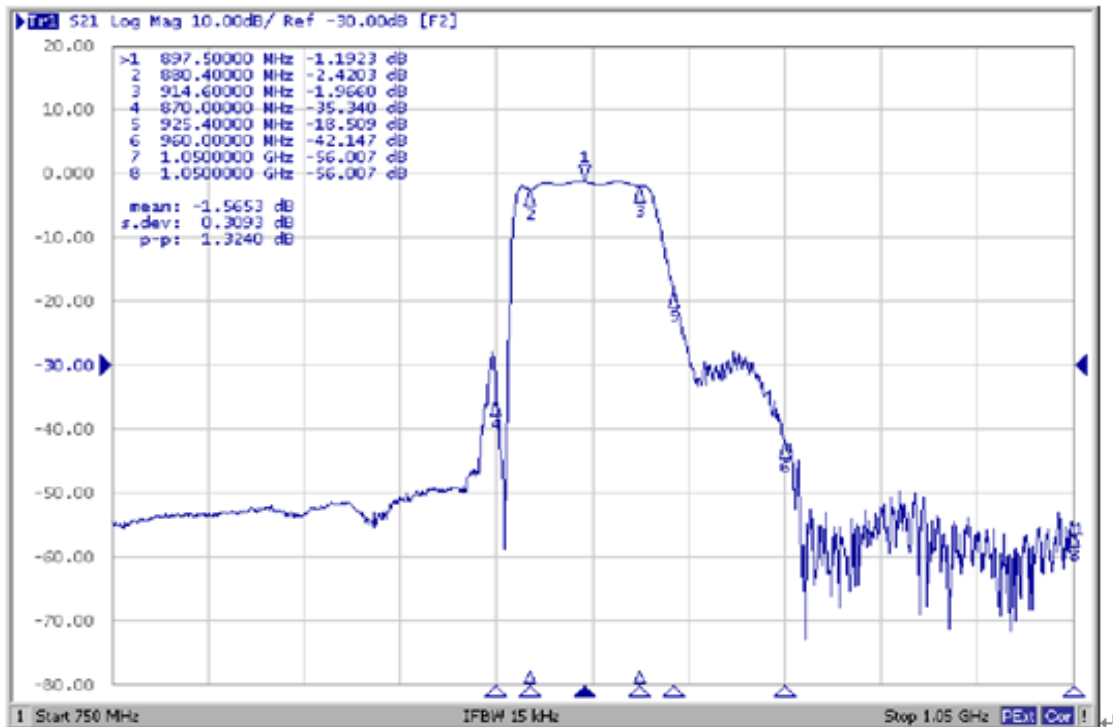
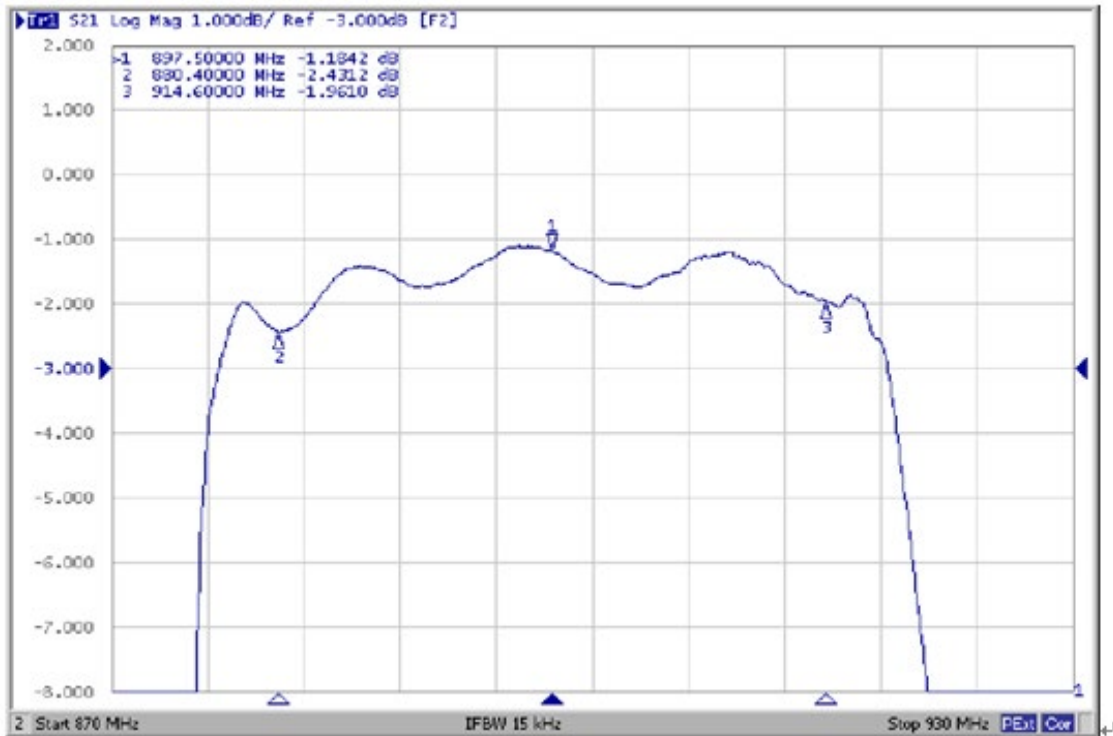

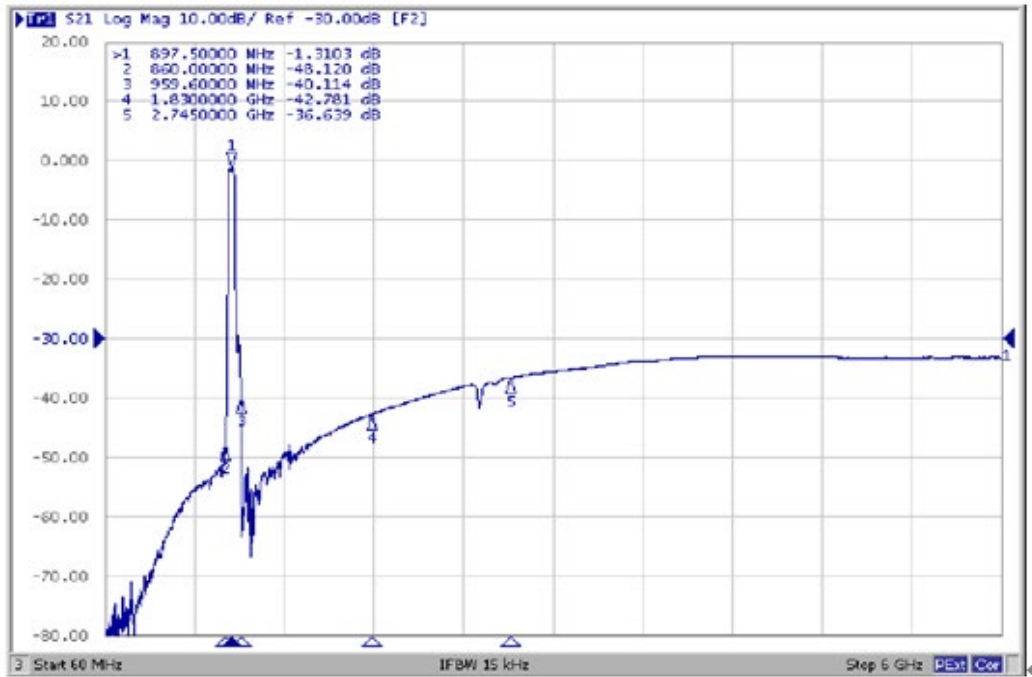

Reflection Functions:

VSWR

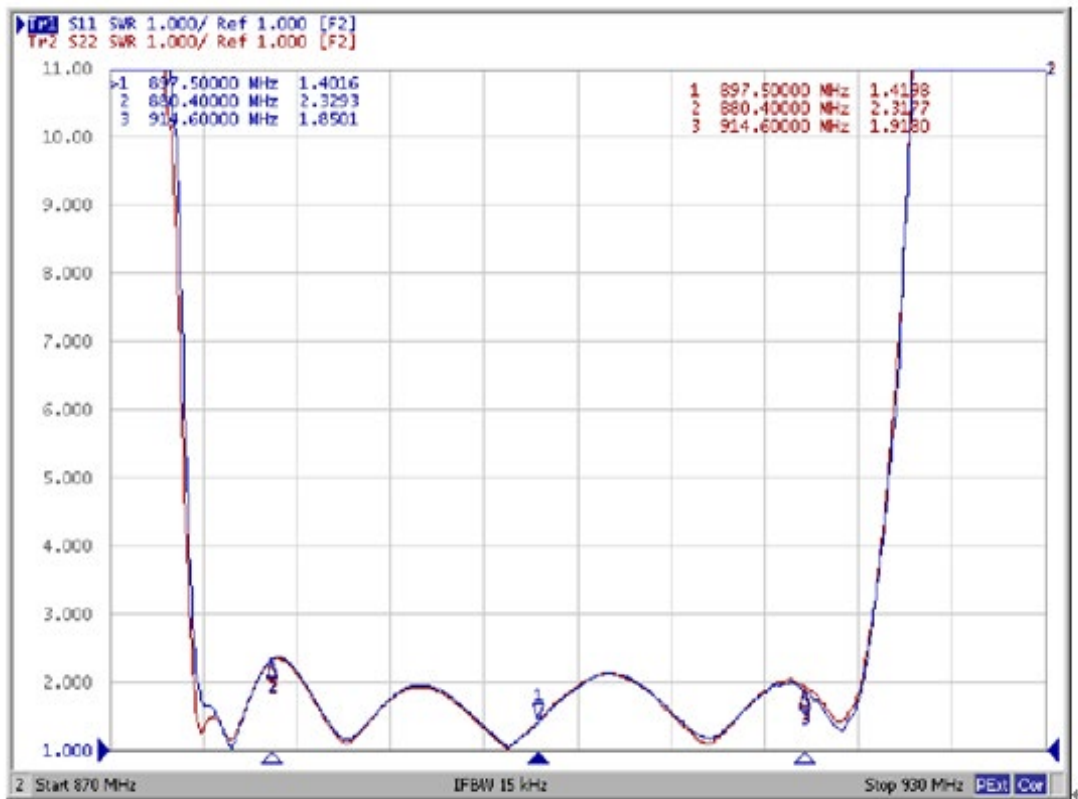

Smith Chart

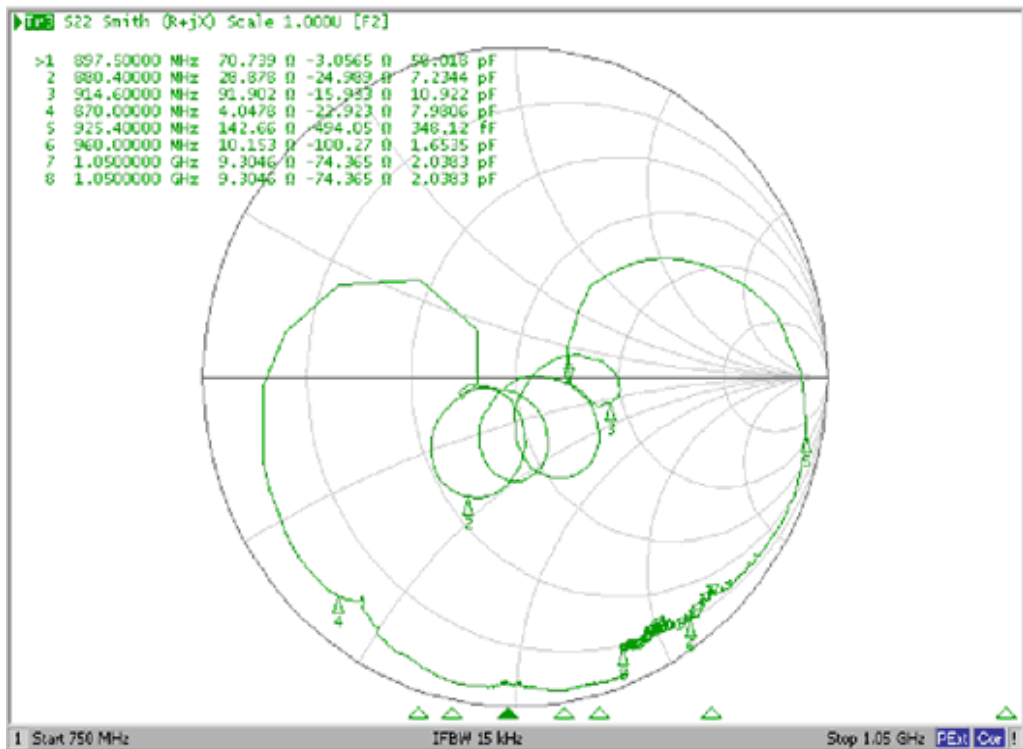
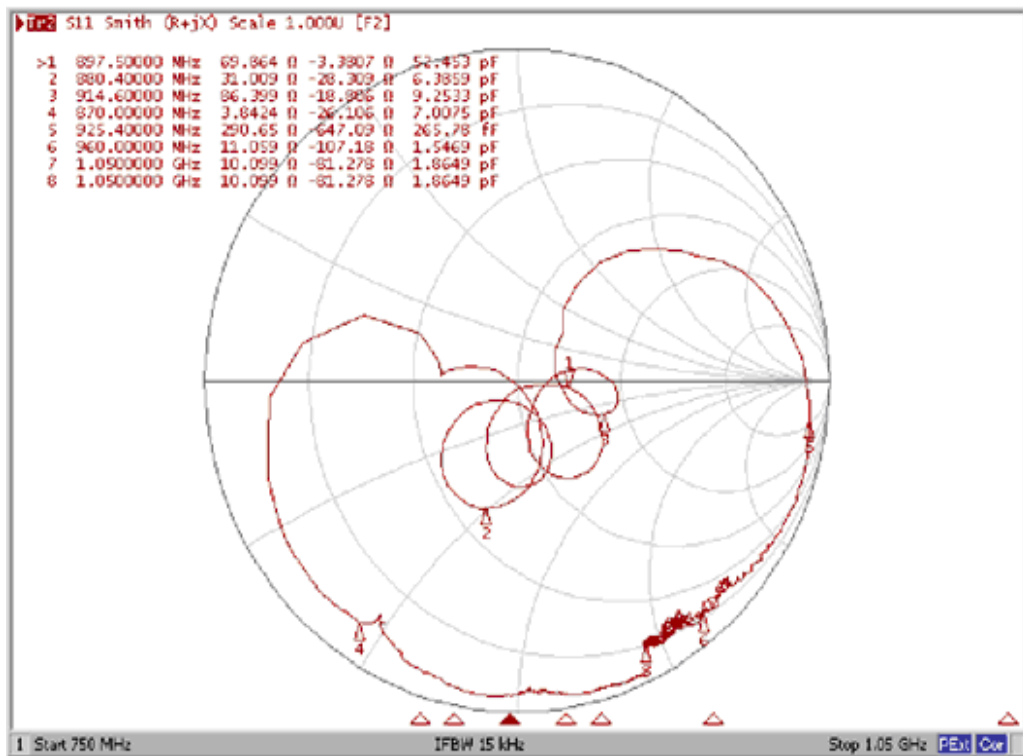

PCB Footprint

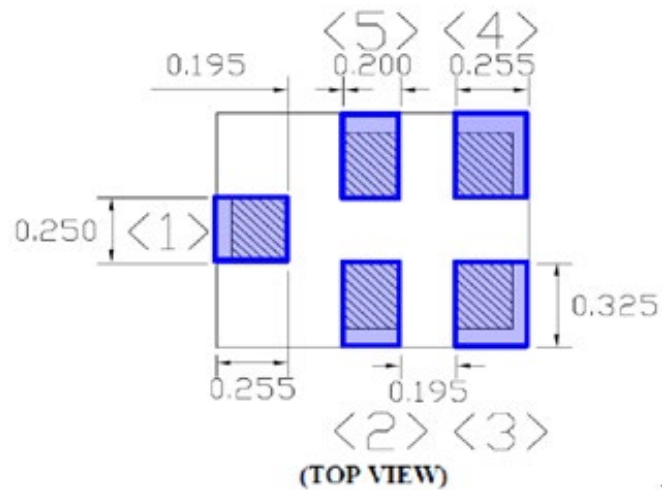

OUTLINE DRAWING (Mass Production)

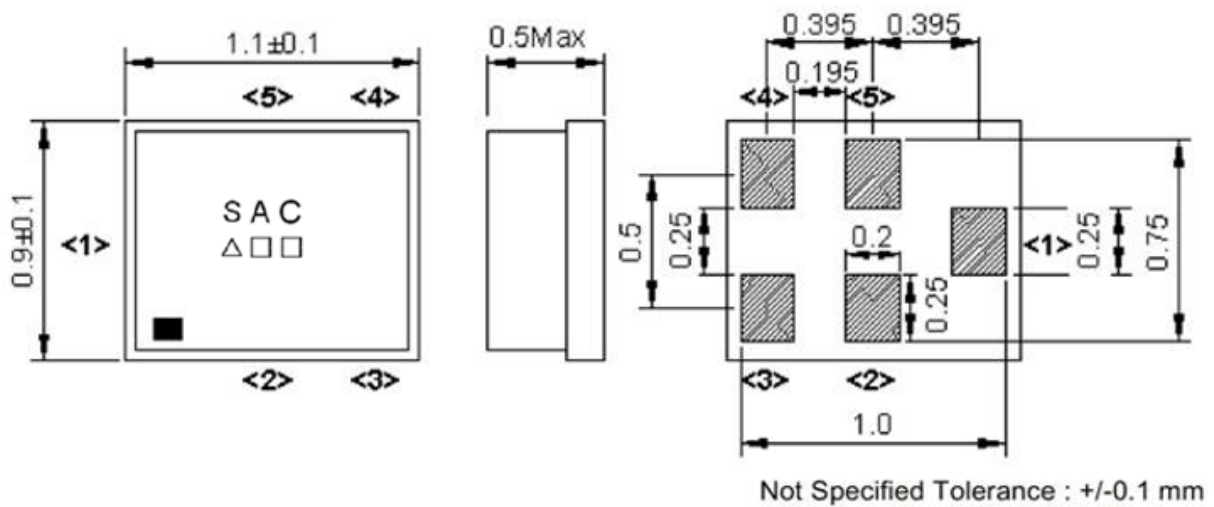

Pin Configuration

Pin No.	Symbol	Function
1	IN	Unbalanced pin
2	GND	Ground
3	GND	Ground
4	OUT	Unbalanced pin
5	GND	Ground

△ : Date Code

□ : Lot No. (Indicated by 0~9 or A to Z and a to z, except I, O, i, o and l)

Date Code												
Year	Jan	Feb	Mar	Apr	May	Jun	Jul	Aug	Sep	Oct	Nov	Dec
2017	A	N	C	D	E	F	G	H	J	K	L	M
2018	N	P	Q	R	S	T	U	V	W	X	Y	Z
2019	a	b	c	d	e	f	g	h	j	k	l	m
2020	n	p	q	r	s	t	u	v	w	x	y	z

PACKING:
REEL DIMENSION

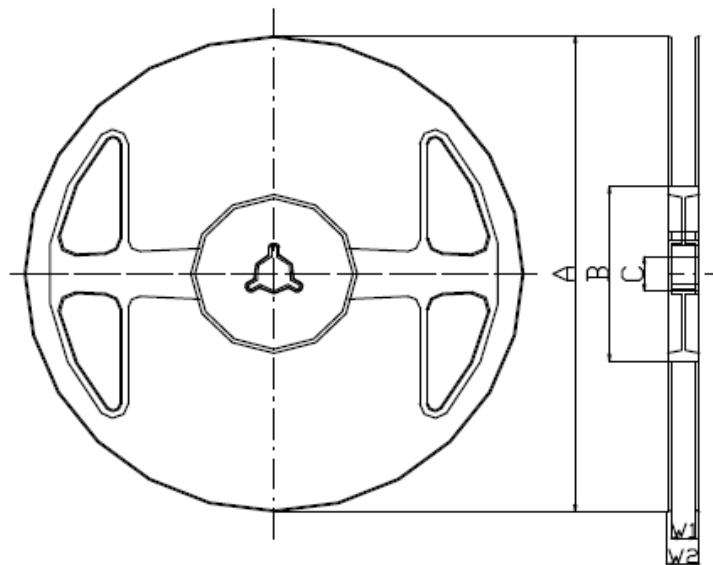

Materials of Reel

Material : Polystyrene + Carbon

Color : Black

Surface resistance (reference value) : $10^9\Omega/\text{sq}$ Max.

Unit : mm

Code	Quantity	A	B	C	W1	W2
J	5,000 pcs	ϕ 180.0 +0.0/-1.5	ϕ 66.0 +/-0.5	ϕ 13.0 +/-0.2	9.0 +1.0/-0.0	11.4 +/-1.0

TAPE DIMENSION

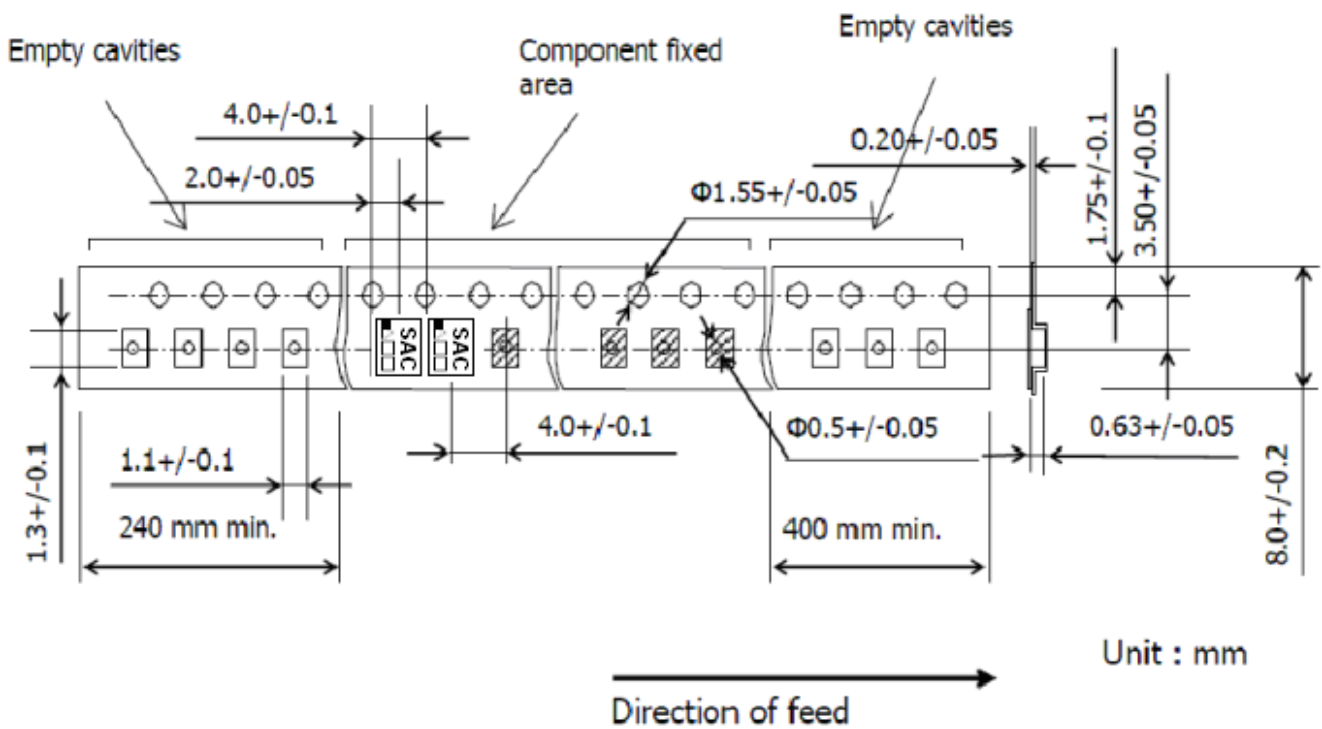

Unit : mm

Recommended Reflow Profile:

1. Preheating shall be fixed at 150~180°C for 60~90 seconds.
2. Ascending time to preheating temperature 150°C shall be 30 seconds min.
3. Heating shall be fixed at 220°C for 50~80 seconds and at 260°C+0/-5°C peak (20~40sec).
4. Time: 2 times.

