



RFM Integrated Device, Inc.

PRODUCT SPECIFICATION

Part Number:

SF2564LA

FILTER, SAW Rx LTE BAND 28, 773
MHz, BW 30 MHz, IL 3 dB

SMD 1.1 x 0.9 mm

MAXIMUM RATING

1. Maximum Input Power: 15 dBm
2. Operating Temperature: -40 °C to +85 °C
3. Storage Temperature Range: -55 °C to +125 °C
4. Moisture Sensitivity Level: Level 1 (MSL 1)
5. ESD: 100 V(MM), 200 V(HBM)
6. AEC-Q200 Qualified



ELECTRICAL CHARACTERISTICS

Terminating source impedance: $Z_s = 50 \Omega$

Terminating load impedance: $Z_L = 50 \Omega$

| Parameters Description | Unit | Min. | Typ. | Max. |
|--|-------------------|------|------|------|
| Center Frequency Fc | MHz | - | 773 | - |
| Insertion Loss (758~788 MHz) IL | dB | - | 2.1 | 3.0 |
| Amplitude Ripple (758~788 MHz) | dB _{p-p} | - | 1.1 | 2.3 |
| VSWR (758~788 MHz) | - | - | 2.2 | 2.5 |
| Attenuation (Reference level from 0 dB) | | | | |
| 703 ~ 733 MHz | dB | 46 | 52 | - |
| 733 ~ 748 MHz | dB | 46 | 53 | - |
| 1516 ~ 1576 MHz | dB | 40 | 49 | - |
| 1559 ~ 1606 MHz | dB | 40 | 48 | - |
| 2274 ~ 2364 MHz | dB | 35 | 43 | - |
| 2400 ~ 2500 MHz | dB | 35 | 43 | - |
| 3032 ~ 3152 MHz | dB | 30 | 40 | - |
| 3790 ~ 3940 MHz | dB | 30 | 39 | - |
| 4548 ~ 4728 MHz | dB | 30 | 38 | - |
| 4900 ~ 5950 MHz | dB | 30 | 37 | - |
| 5306 ~ 5516 MHz | dB | 30 | 38 | - |
| 6064 ~ 6304 MHz | dB | 30 | 39 | - |
| 6822 ~ 7092 MHz | dB | 30 | 42 | - |
| 7580 ~ 7880 MHz | dB | 25 | 49 | - |

FREQUENCY CHARACTERISTICS

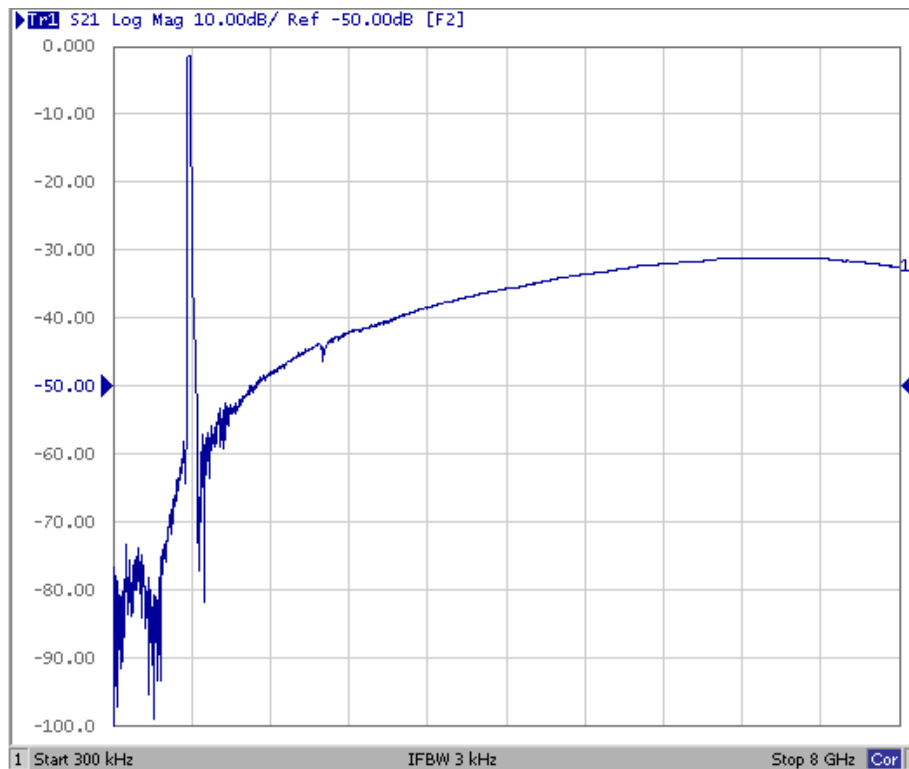
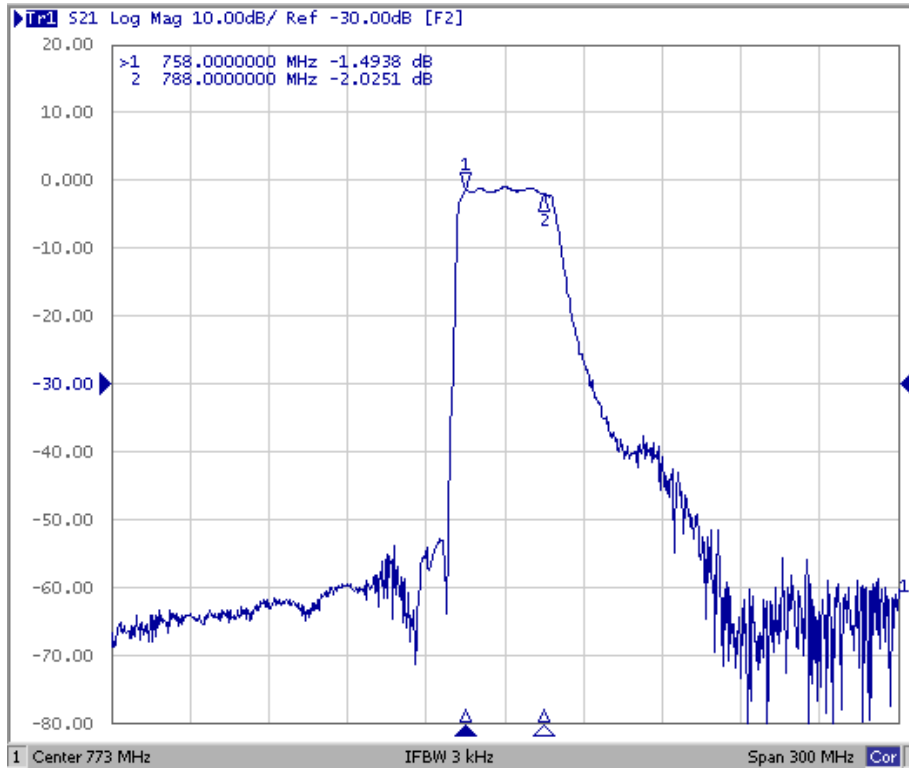

Reflection Functions

VSWR

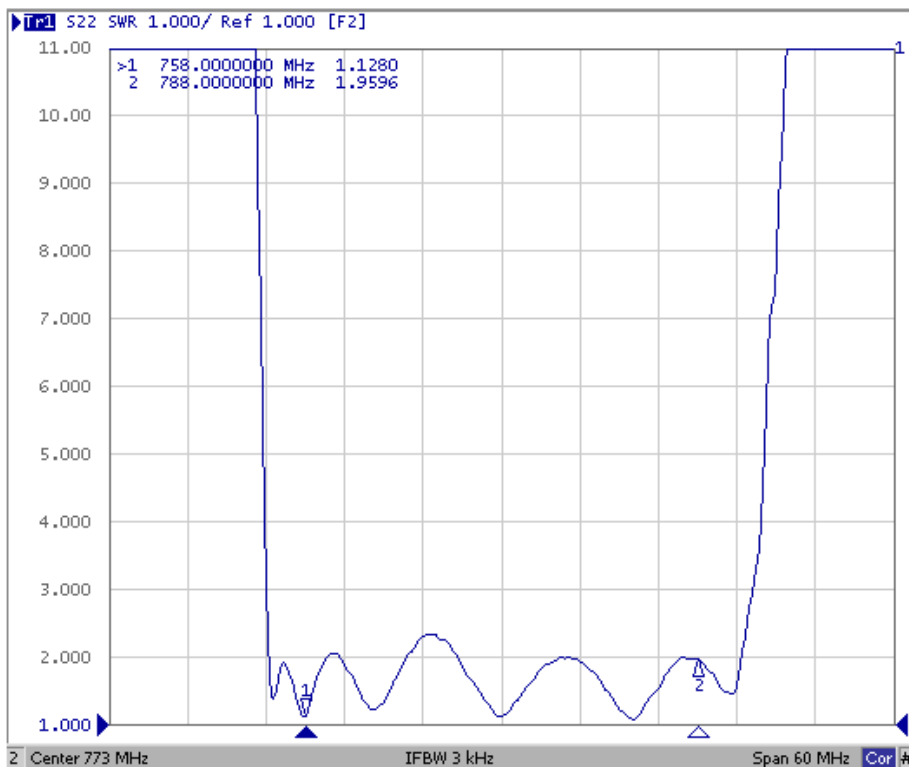
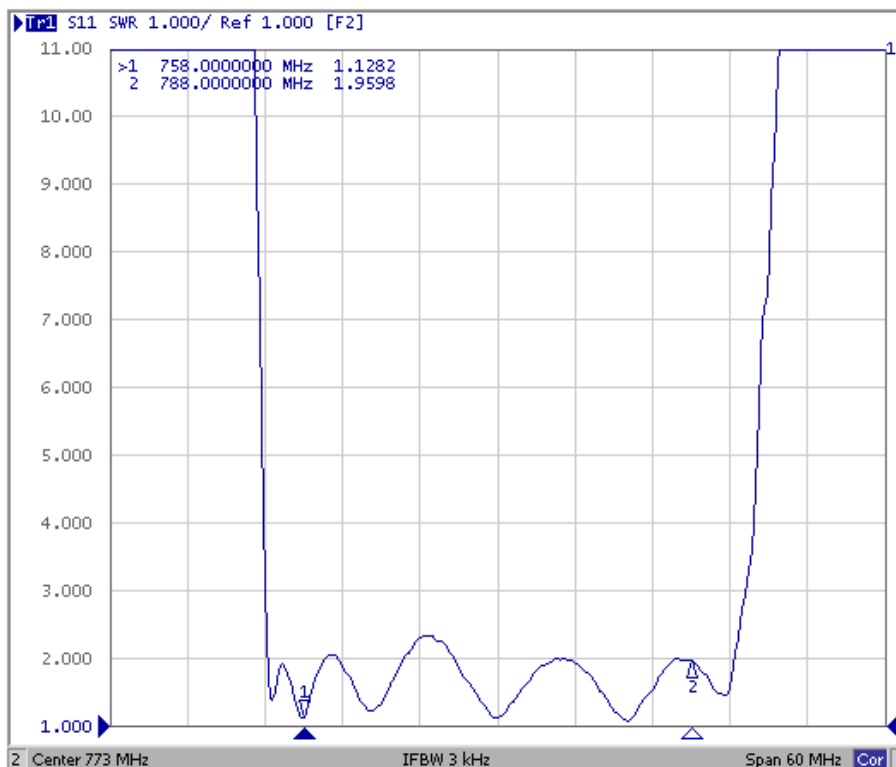

Smith Chart

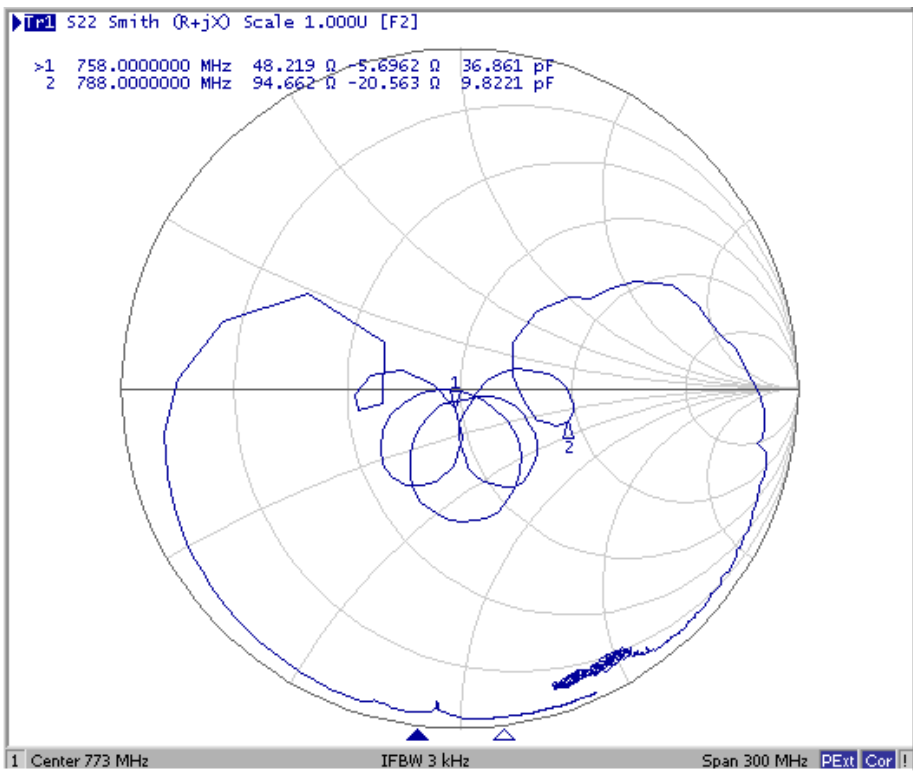
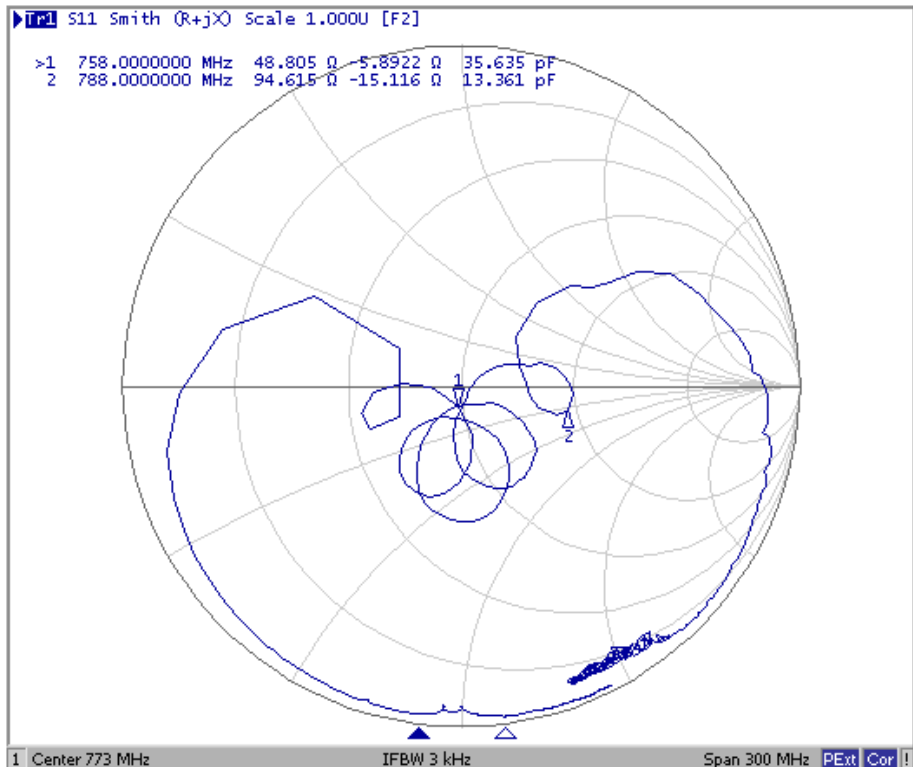

MEASUREMENT CIRCUIT

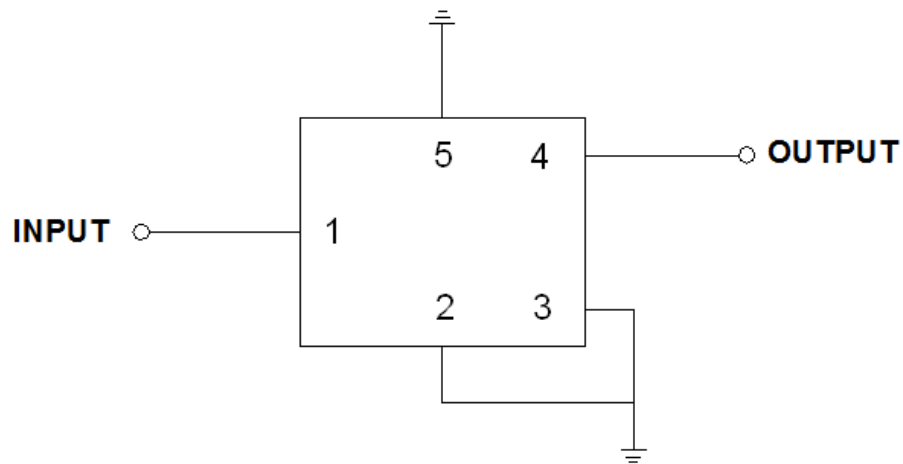

Source & Load Impedance: 50Ω

PCB Footprint

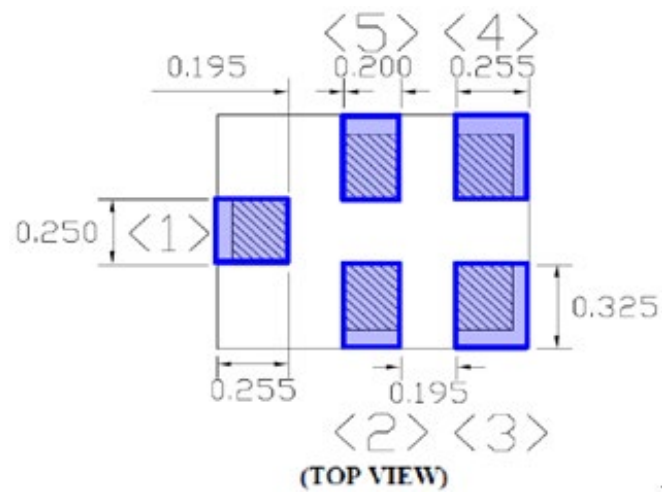

OUTLINE DRAWING

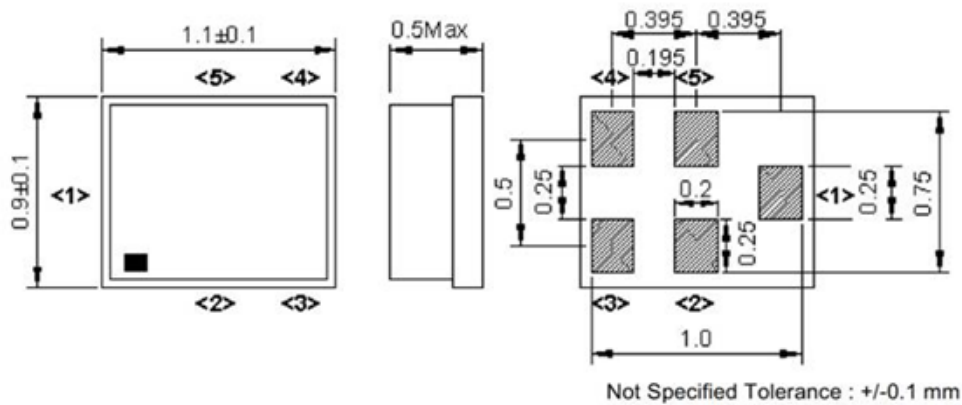

Pin Configuration

| Pin No. | Symbol | Function |
|---------|--------|----------------|
| 1 | IN | Unbalanced pin |
| 2 | GND | Ground |
| 3 | GND | Ground |
| 4 | OUT | Unbalanced pin |
| 5 | GND | Ground |

Top View (Mass Production)

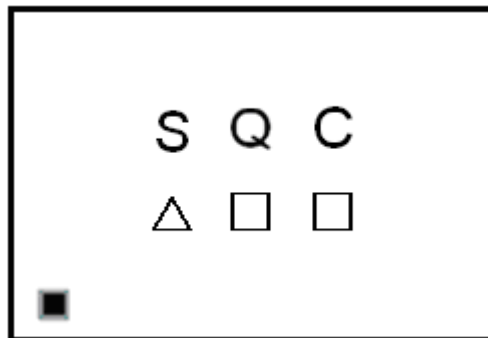

Δ : Date Code

\square : Lot No. (Indicated by 0~9 or A to Z and a to z, except I, O, i, o and l)

| Date Code | | | | | | | | | | | | |
|-----------|-----|-----|-----|-----|-----|-----|-----|-----|-----|-----|-----|-----|
| Year | Jan | Feb | Mar | Apr | May | Jun | Jul | Aug | Sep | Oct | Nov | Dec |
| 2017 | A | N | C | D | E | F | G | H | J | K | L | M |
| 2018 | N | P | Q | R | S | T | U | V | W | X | Y | Z |
| 2019 | a | b | c | d | e | f | g | h | j | k | l | m |
| 2020 | n | p | q | r | s | t | u | v | w | x | y | z |

PACKING
REEL DIMENSION

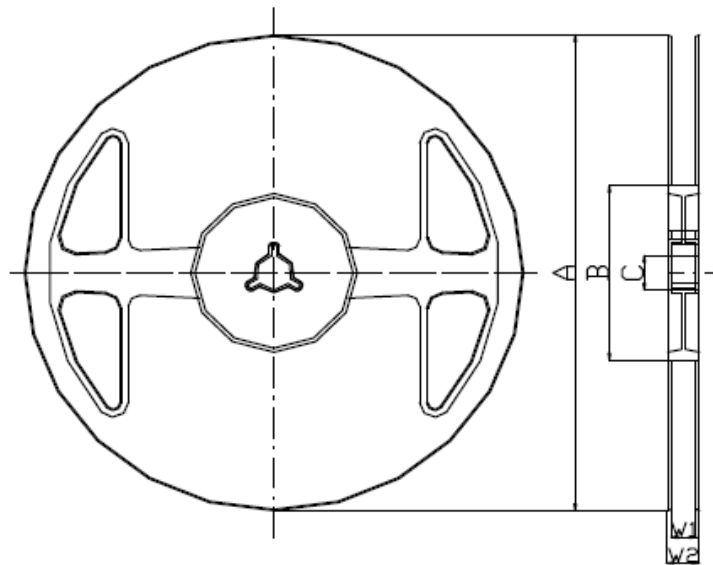

Materials of Reel

Material : Polystyrene + Carbon

Color : Black

Surface resistance (reference value) : $10^9\Omega/\text{sq}$ Max.

Unit : mm

| Code | Quantity | A | B | C | W1 | W2 |
|------|-----------|------------------------|--------------------|--------------------|-----------------|---------------|
| J | 5,000 pcs | $\phi 180.0 +0.0/-1.5$ | $\phi 66.0 +/-0.5$ | $\phi 13.0 +/-0.2$ | $9.0 +1.0/-0.0$ | $11.4 +/-1.0$ |

TAPE DIMENSION

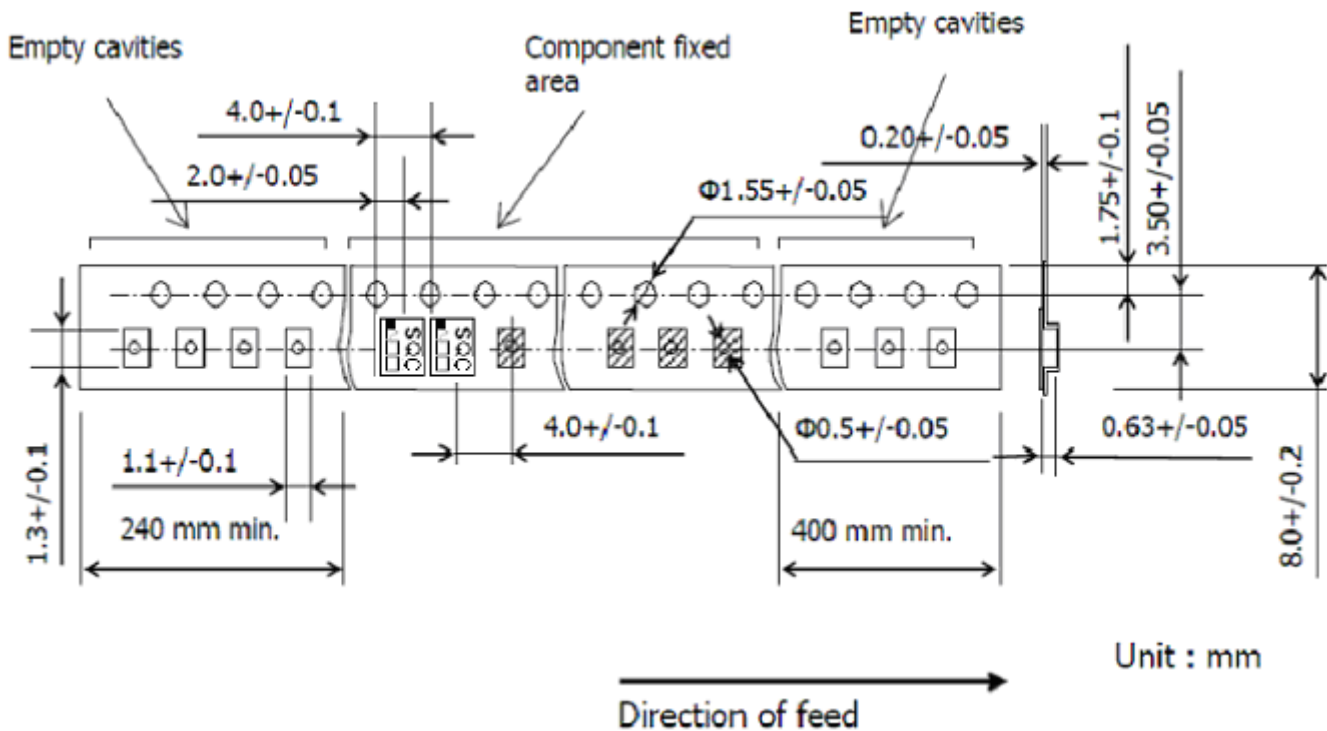

RECOMMENDED REFLOW PROFILE

1. Preheating shall be fixed at 150~180°C for 60~90 seconds.
2. Ascending time to preheating temperature 150°C shall be 30 seconds min.
3. Heating shall be fixed at 220°C for 50~80 seconds and at 260°C+0/-5°C peak (20~40sec).
4. Time: 2 times.

