

SF2577LA

**2155 MHz
SAW Filter**

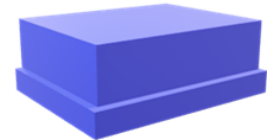

SM1109

MAXIMUM RATING

- Input Power Level: 15dBm
- DC Voltage : 5V
- Operating Temperature: -40°C to +85°C
- Storage Temperature: -40°C to +100°C
- Moisture Sensitivity Level: Level 1
- ESD 50V(MM) 100V(HBM)
- AEC-Q200 Qualified

ELECTRICAL CHARACTERISTICS

Terminating source impedance(Unbalanced) : $Z_s = 50//4.7nH \ \Omega$

Terminating load impedance(Unbalanced) : $Z_L = 50//3.9nH \ \Omega$

Item	Unit	Min.	Typ.	Max.	Note
Center Frequency Fc	MHz	-	2155	-	-
Insertion Loss (2110~2200 MHz)	IL dB(*1)	-	1.7	2.3	-30°C ~ +85°C
Insertion Loss (2110~2200 MHz)	IL dB(*1)	-	1.7	2.8	-
Amplitude ripple (2110~2200 MHz)	dB	-	0.7	1.5	-30°C ~ +85°C
Amplitude ripple (2110~2200 MHz)	dB	-	0.7	2.0	-
VSWR Input (2110~2200 MHz)		-	1.5	2.2	-
VSWR Output (2110~2200 MHz)		-	1.5	2.7	
Attenuation (reference level from 0 dB)					
1710 ~ 1780 MHz	dB	42	49	-	-
1920 ~ 2010 MHz	dB	40	45	-	-30°C ~ +85°C
1920 ~ 2010 MHz	dB	35	45	-	-
2400 ~ 2500 MHz	dB	30	36	-	-
3820 ~ 3980 MHz	dB	30	36	-	-
4900 ~ 5950 MHz	dB	25	32	-	-
5530 ~ 5760 MHz	dB	25	32	-	-

Notes : (*1) Specification of insertion loss excludes loss that comes from the test board.

CAUTION: Electrostatic Sensitive Device. Observe precautions for handling.



1. The design, manufacturing process, and specifications of this device are subject to change.
2. US or International patents may apply.
3. RoHS compliant from the first date of manufacture.

OUTLINE DRAWING

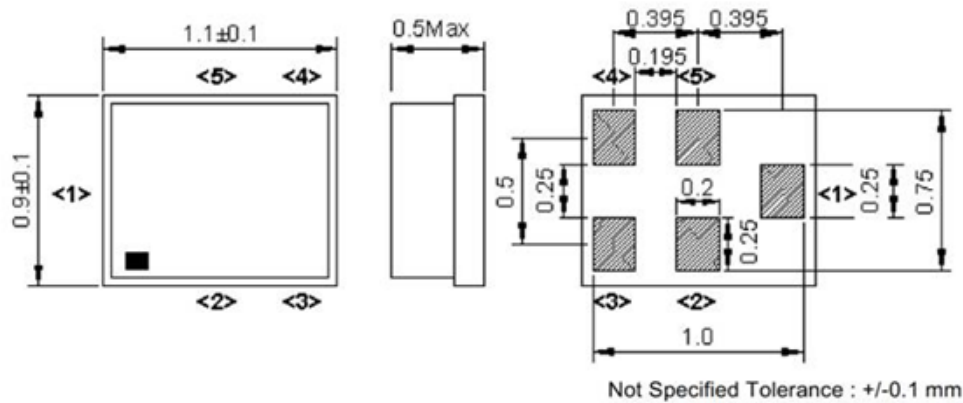

Pin assignment

Pin No.	Pin name	Description
1	In	Input
2	GND	Ground
3	GND	Ground
4	Out	Output
5	GND	Ground

Top View (Mass Production):



Δ : Date Code

\square : Lot No. (Indicated by 0~9 or A to Z and a to z, except I, O, i, o and l)

Date Code: (4-year cycle)

Year	Jan	Feb	Mar	Apr	May	Jun	Jul	Aug	Sep	Oct	Nov	Dec
2018	N	P	Q	R	S	T	U	V	W	X	Y	Z
2019	a	b	c	d	e	f	g	h	j	k	l	m
2020	n	p	q	r	s	t	u	v	w	x	y	z
2021	A	B	C	D	E	F	G	H	J	K	L	M

Evaluation Circuit

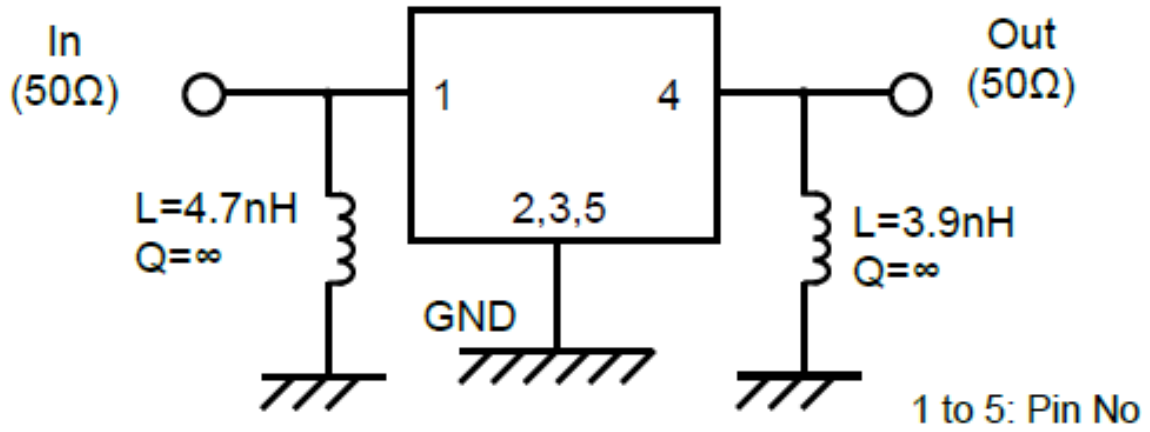

PCB Footprint

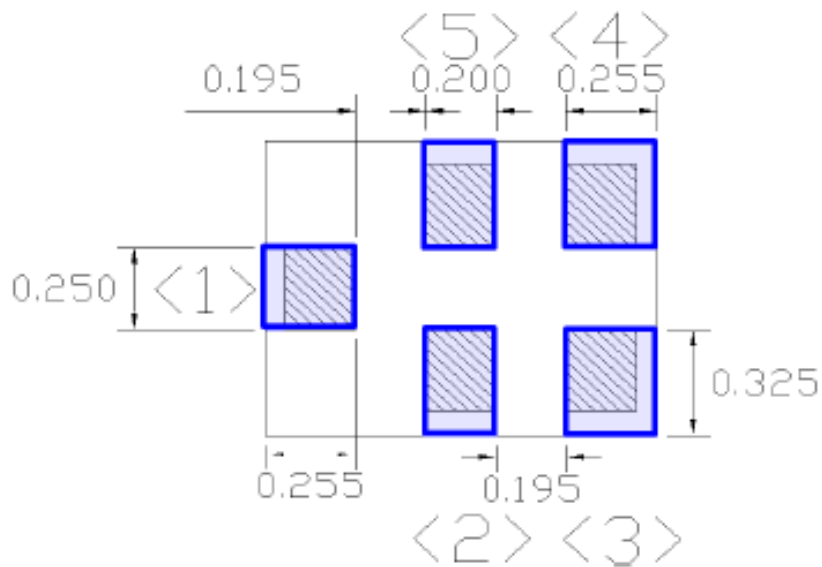

FREQUENCY CHARACTERISTICS

Pass-band

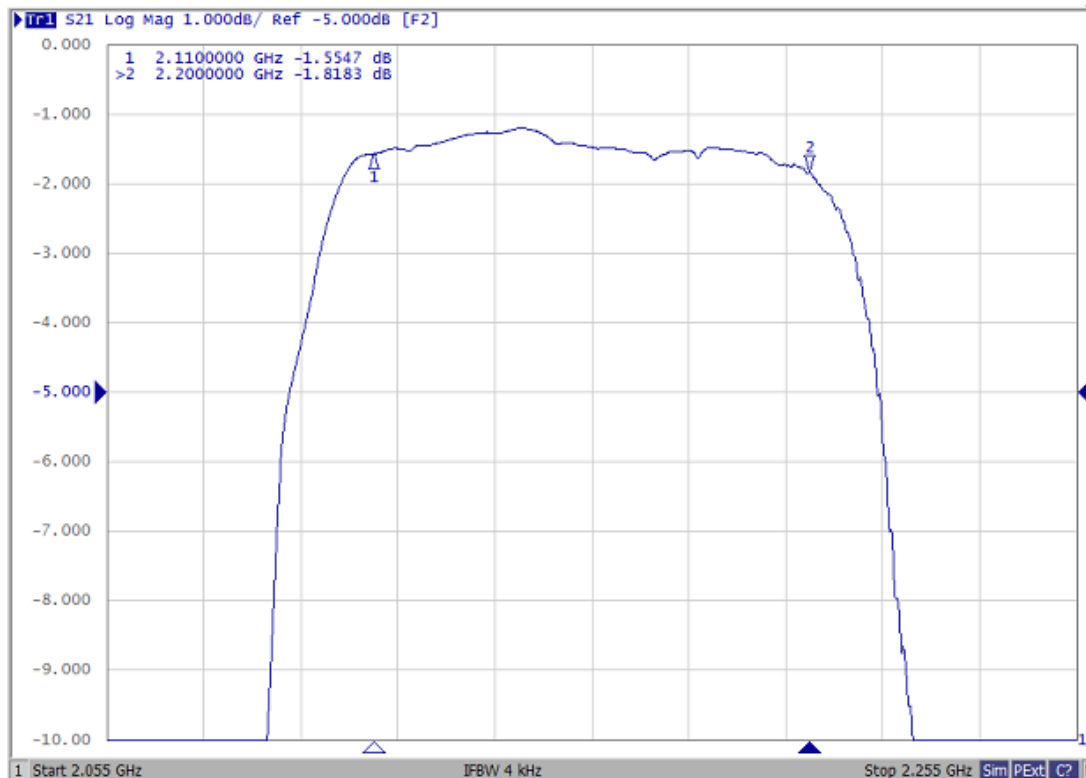
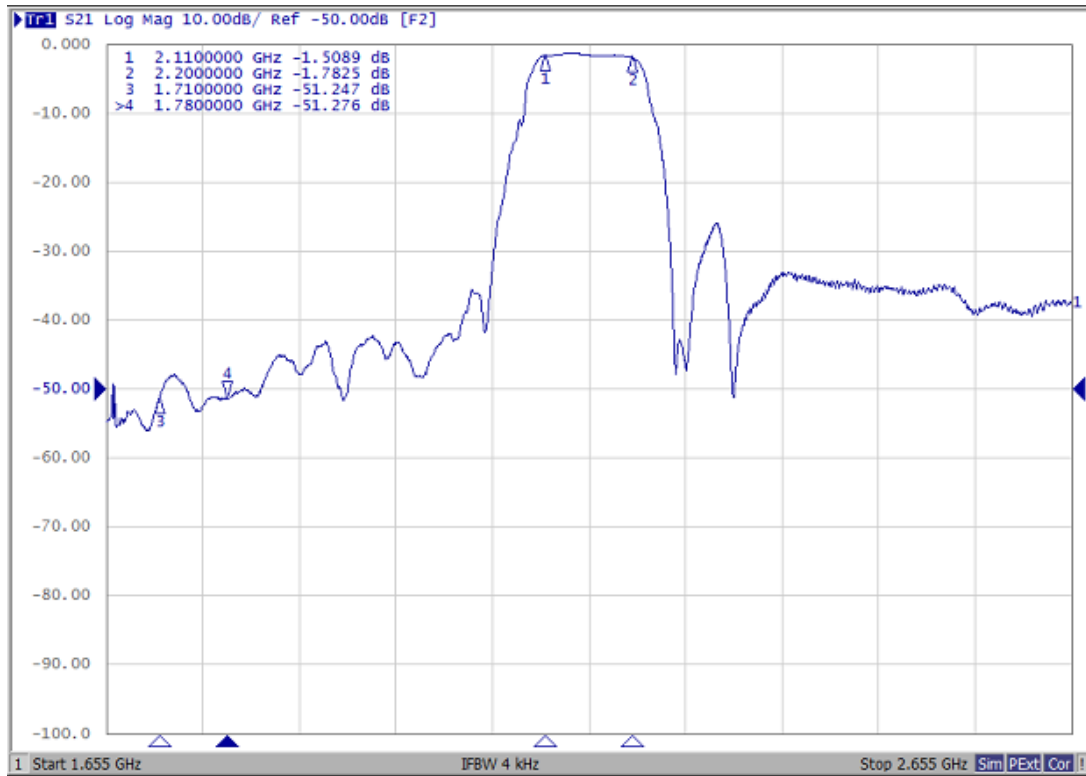

Input Port

VSWR

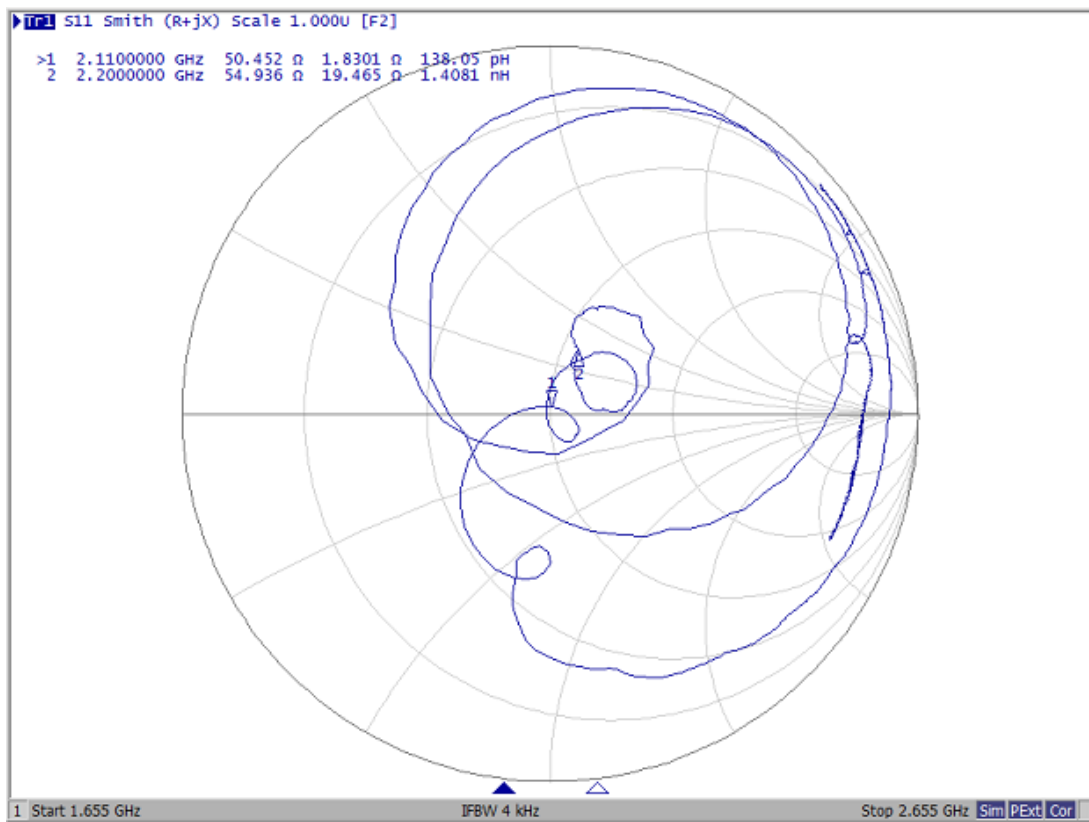
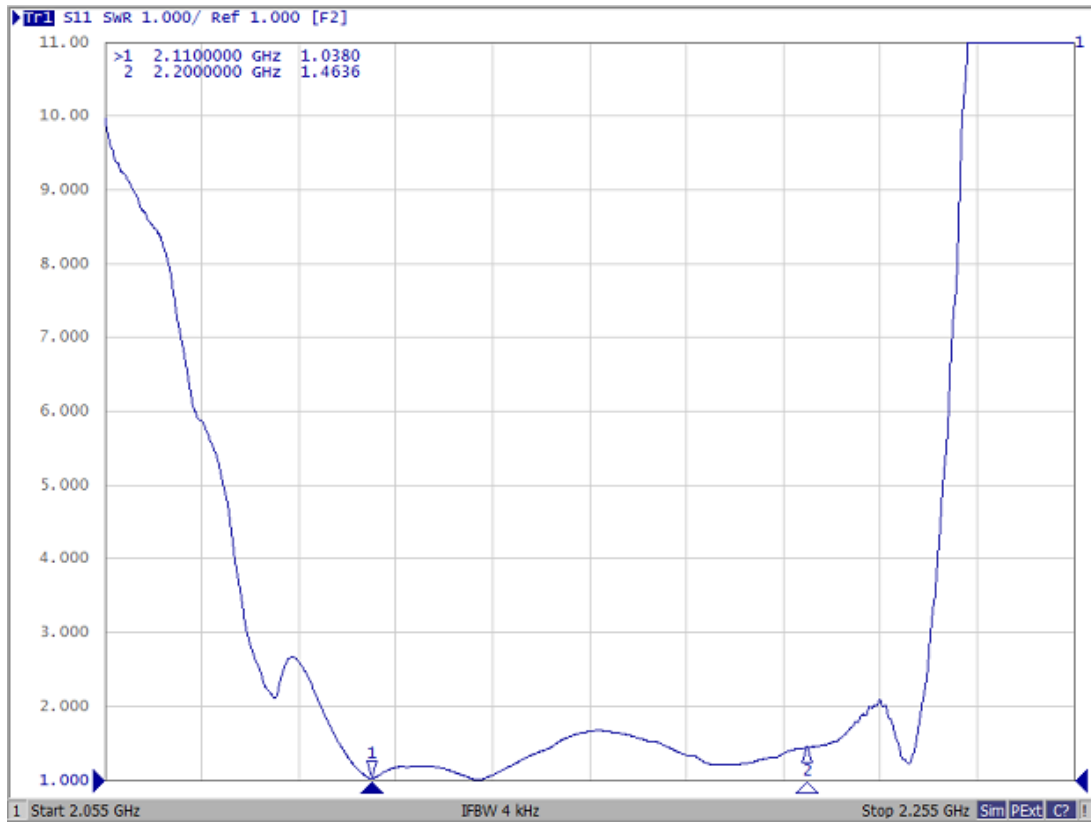

Output Port

VSWR

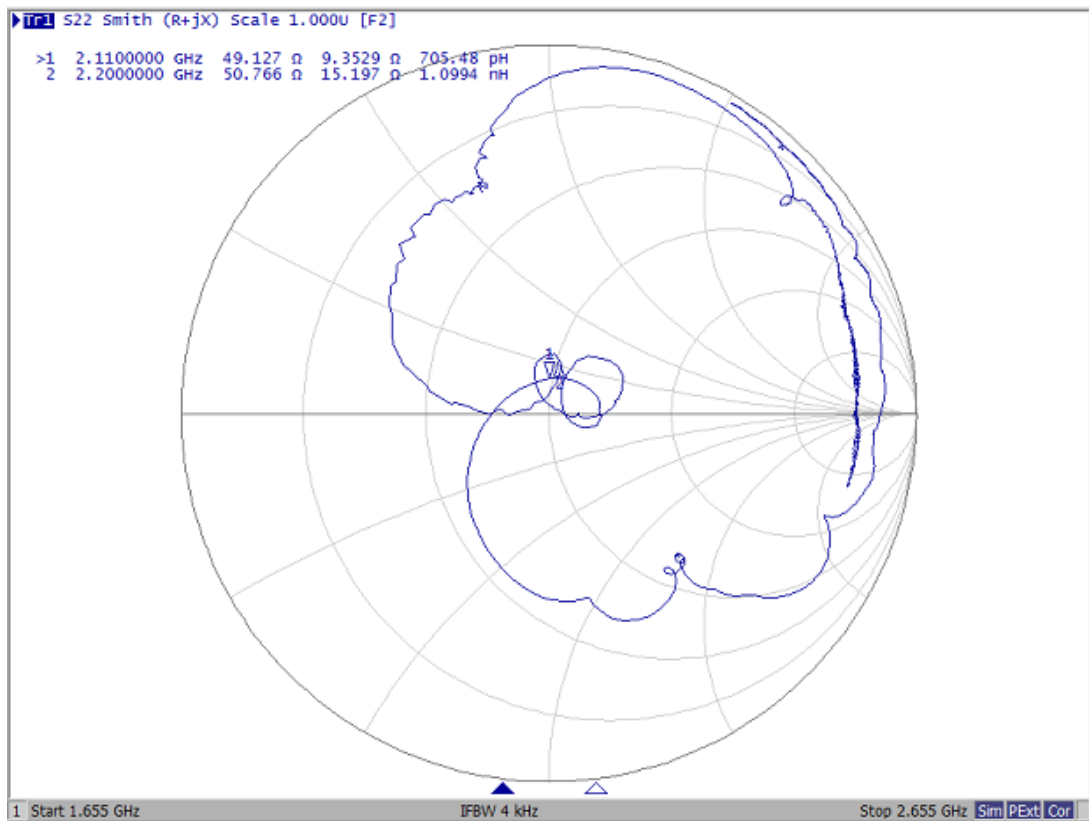
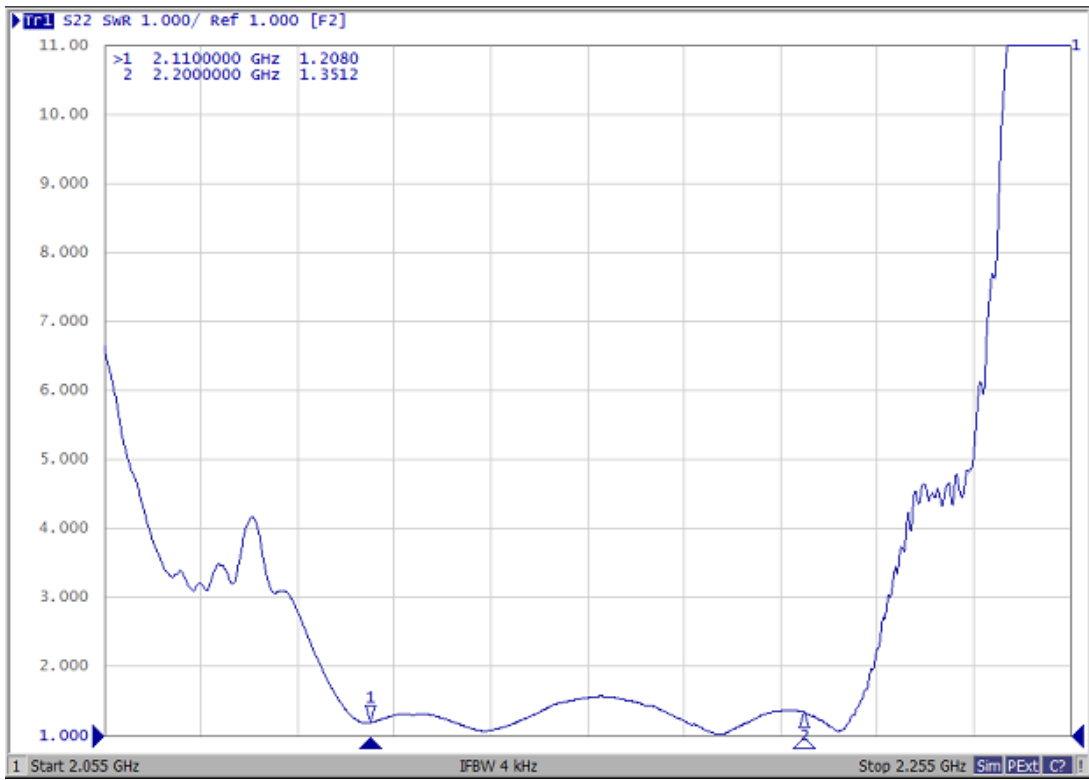

Wide-band

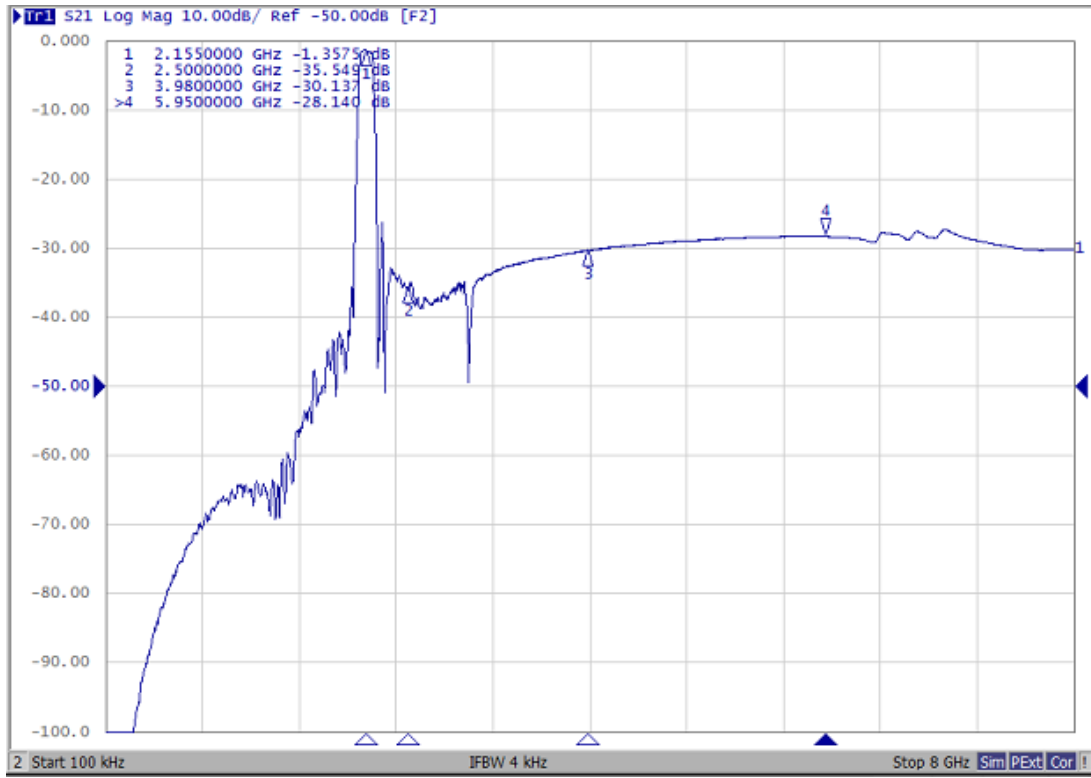

**PACKING
REEL DIMENSION**

Reel count
7" = 3000
13" = 10,000

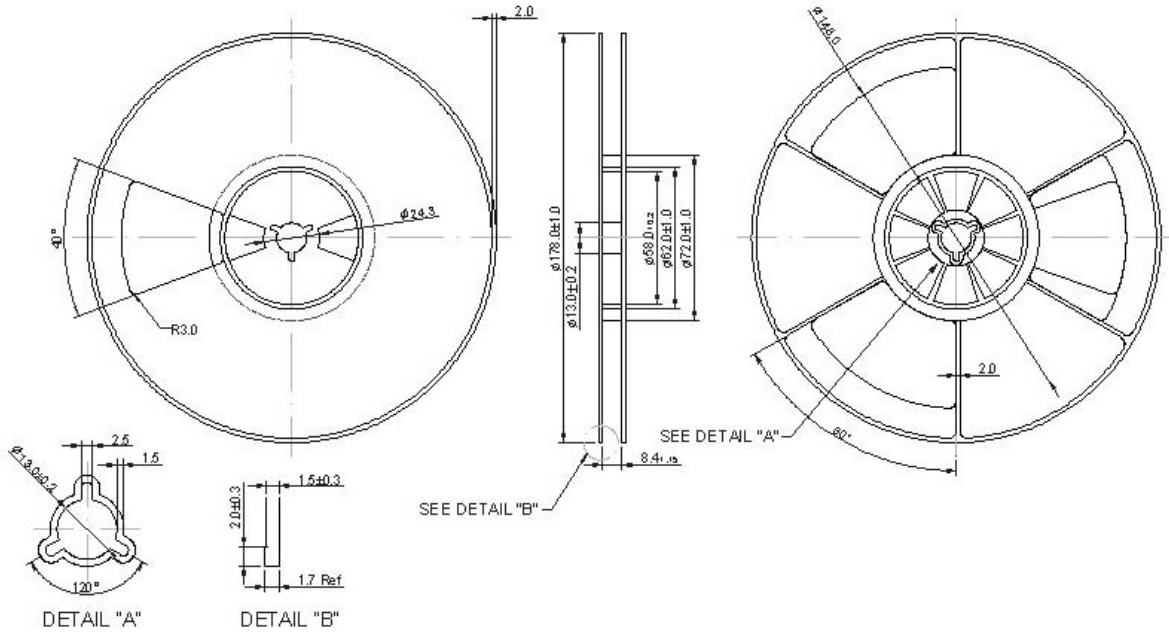

TAPE DIMENSION

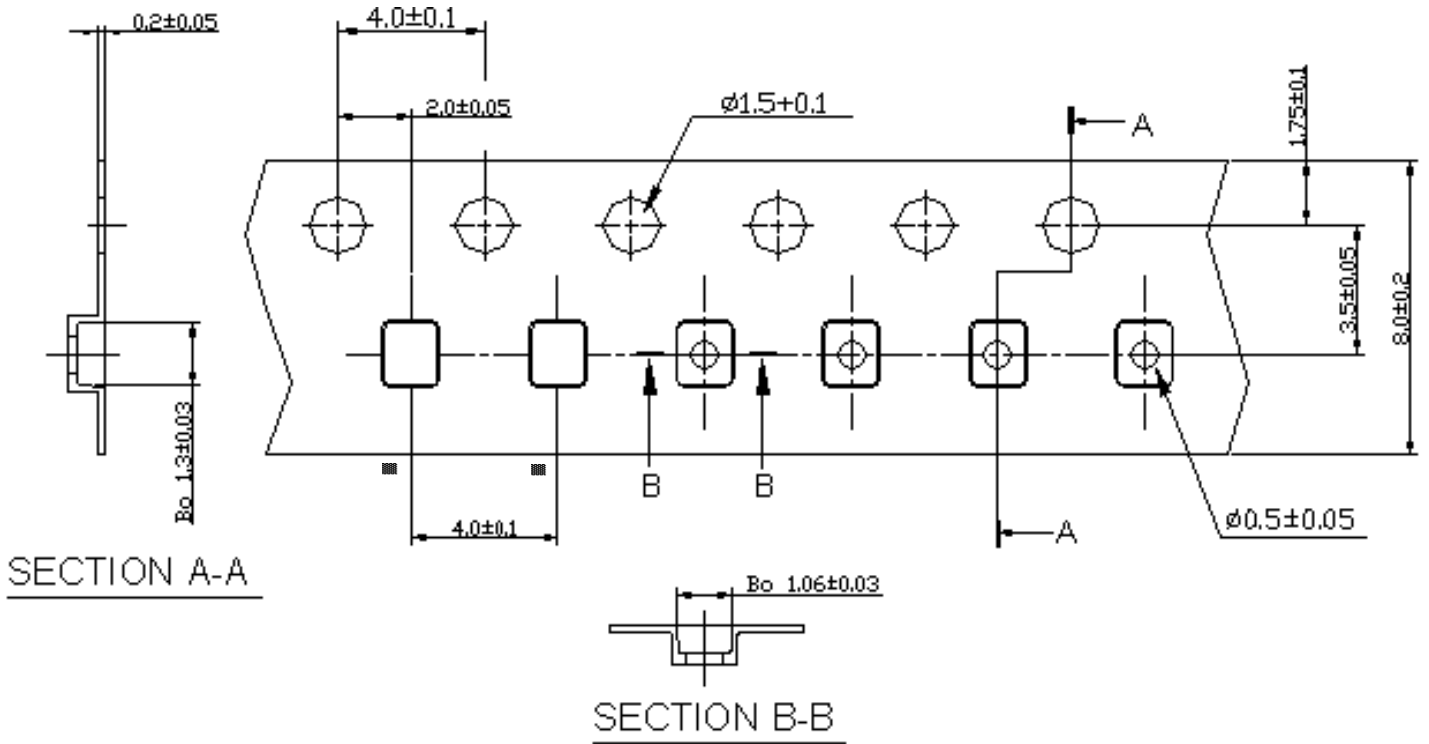

RECOMMENDED REFLOW PROFILE

1. Preheating shall be fixed at 150~180°C for 60~90 seconds.
2. Ascending time to preheating temperature 150°C shall be 30 seconds min.
3. Heating shall be fixed at 220°C for 50~80 seconds and at 245~260°C peak (min. 10sec).
4. Time : 2 times.

