

SF2626E

1579.5 MHz
SAW Filter

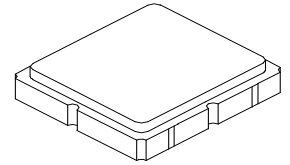

SM3030-6

MAXIMUM RATING:

- Input Power Level: 10 dBm
- DC Voltage : 3V
- Operating Temperature: -40°C to +85°C
- Storage Temperature: -40°C to +85°C
- Moisture Sensitivity Level: 1
- AEC-Q200 Qualified

ELECTRICAL CHARACTERISTICS:

Item		Unit	Min.	Typ.	Max.
Center frequency	Fc	dB	-	1579.5	-
Insertion loss within 1551 ~1608 MHz	IL	dB	-	2.1	3.8
Amplitude ripple (p-p) within 1551 ~ 1608 MHz		dB	-	1.1	2.5
VSWR within 1551 ~ 1608 MHz		-	-	1.8	2.5
Attenuation (Reference level from 0 dB)					
10.000 ~ 1490.0	MHz	dB	17	25	-
1700.0 ~ 2300.0	MHz	dB	23	28	-
2300.0 ~ 3000.0	MHz	dB	20	28	-
Temperature Coefficient of Frequency		ppm/°C	-	-36	-
Source impedance	Zs	Ω	-	50	-
Load impedance	ZL	Ω	-	50	-

MEASUREMENT CIRCUIT:

HP Network analyzer

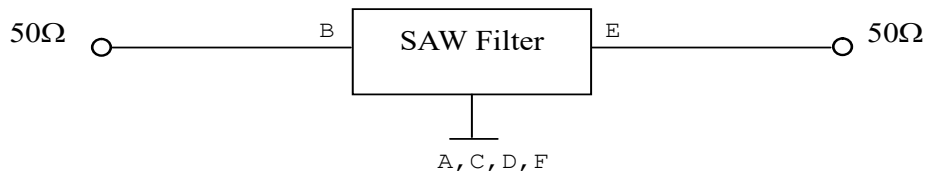

CAUTION: Electrostatic Sensitive Device. Observe precautions for handling.

1. The design, manufacturing process, and specifications of this device are subject to change.
2. US or International patents may apply.
3. RoHS compliant from the first date of manufacture.

OUTLINE DRAWING:

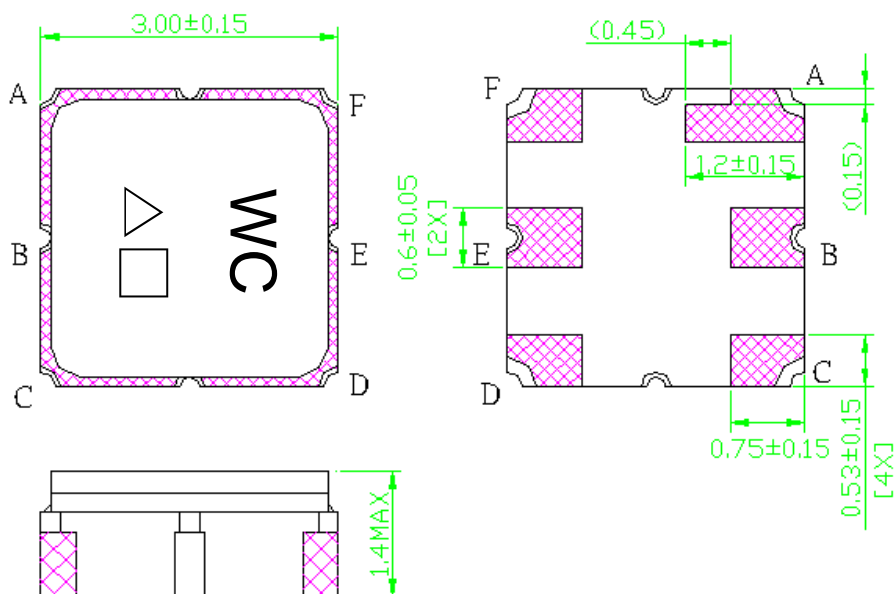

- B : Input
- E : Output
- A, C, D, F : Ground
- Unit : mm

△ : Year Code (2013->3, 2014->4, ..., 2018->8)

□ : Date Code (Follow the table from planner each year)

WK01	WK02	WK03	WK04	WK05	WK06	WK07	WK08	WK09	WK10	WK11	WK12	WK13
A	B	C	D	E	F	G	H	I	J	K	L	M
WK14	WK15	WK16	WK17	WK18	WK19	WK20	WK21	WK22	WK23	WK24	WK25	WK26
N	O	P	Q	R	S	T	U	V	W	X	Y	Z
WK27	WK28	WK29	WK30	WK31	WK32	WK33	WK34	WK35	WK36	WK37	WK38	WK39
a	b	c	d	e	f	g	h	i	j	k	l	m
WK40	WK41	WK42	WK43	WK44	WK45	WK46	WK47	WK48	WK49	WK50	WK51	WK52
n	o	p	q	r	s	t	u	v	w	x	y	z

PCB Footprint:

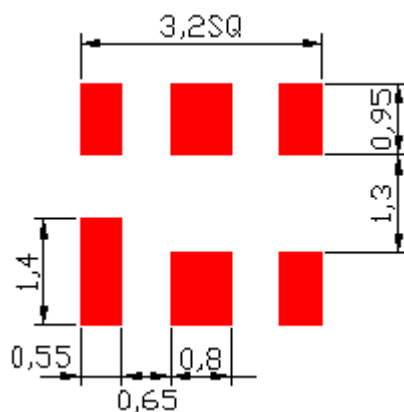

Frequency Characteristics :

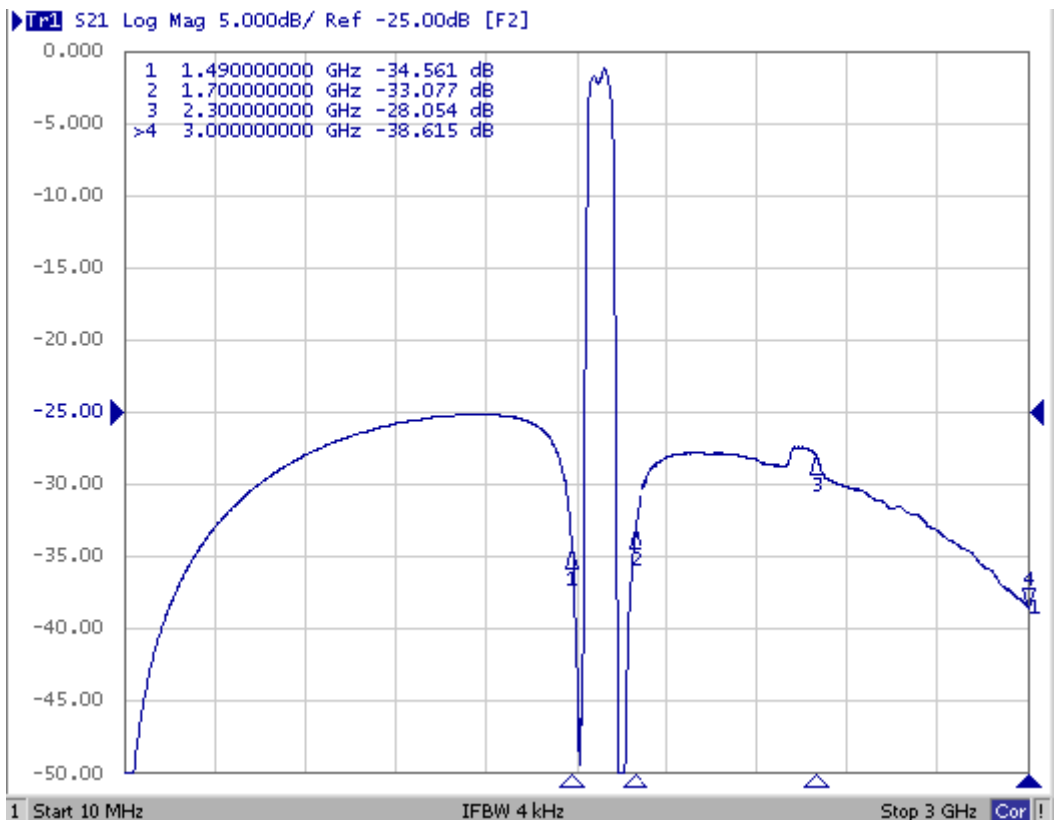
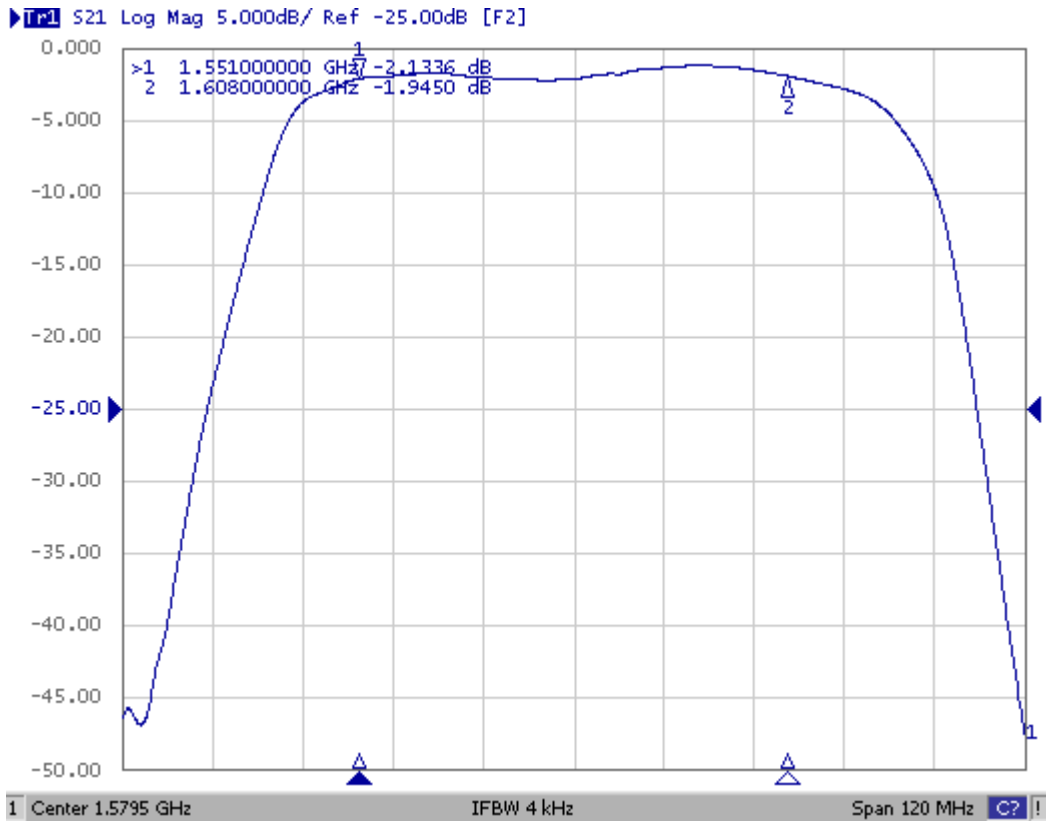

VSWR_S11 :

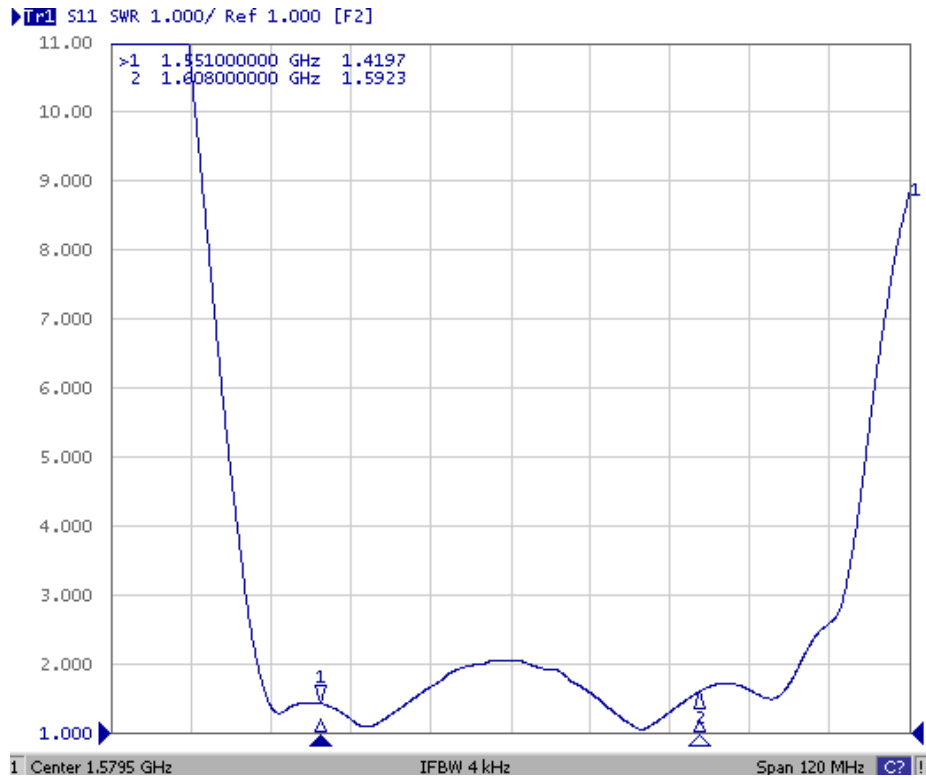

VSWR_S22 :

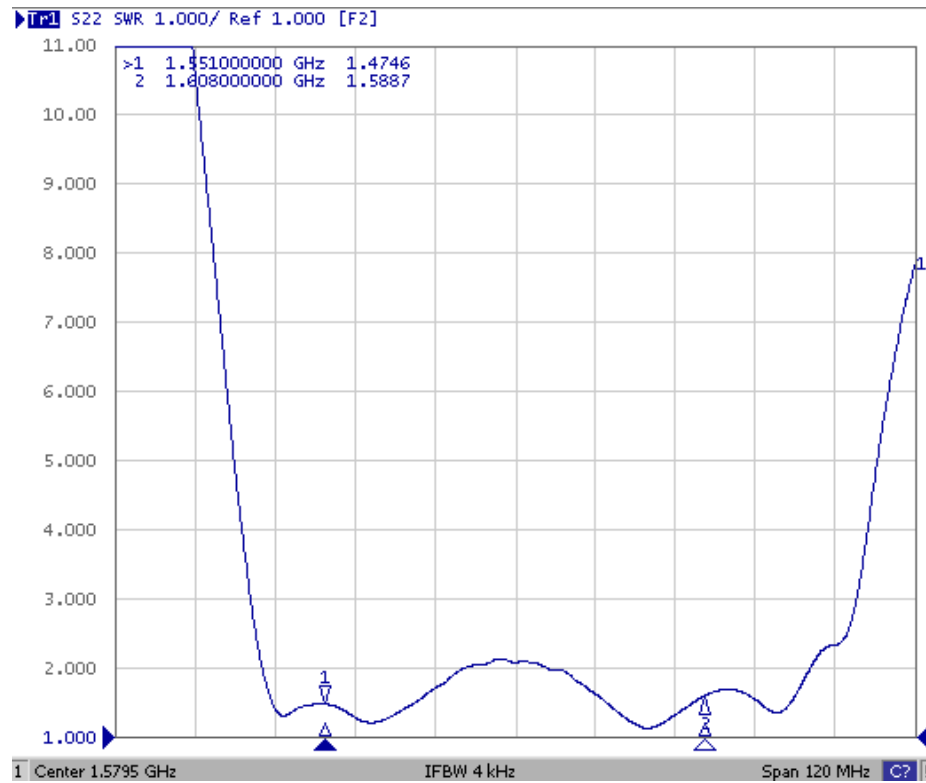

PACKING:

1. REEL DIMENSION

Reel Count:

7" = 1000

13" = 3000

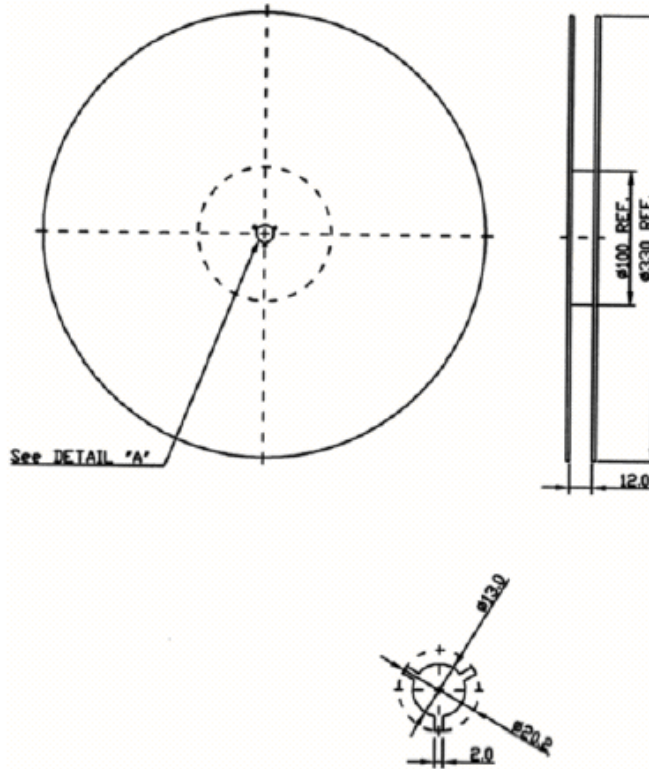

2. TAPE DIMENSION

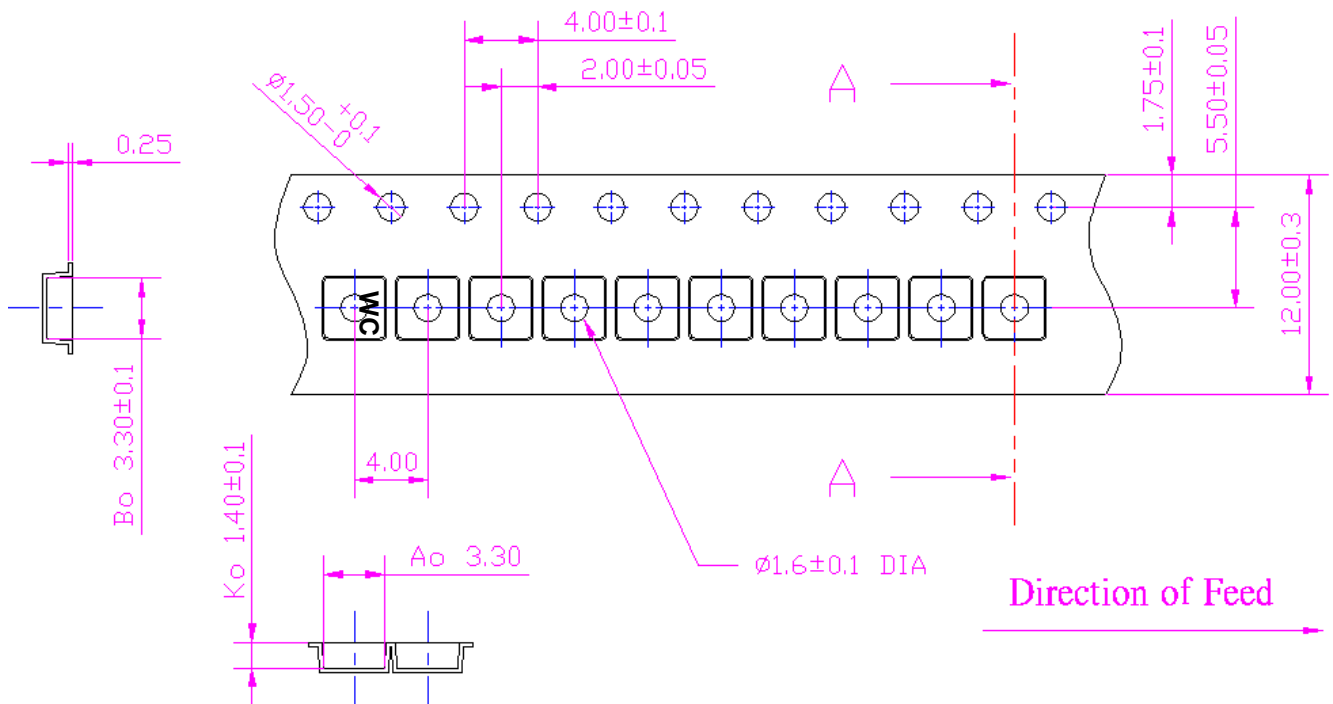

RECOMMENDED REFLOW PROFILE:

