

SF2642E

**322.25 MHz
SAW Filter**

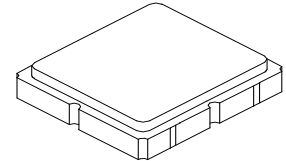

SM3030-6

MAXIMUM RATING:

1. Input Power Level: 20 dBm
2. DC Voltage : 7.5 V
3. Operating Temperature: -40°C to +85°C
4. Storage Temperature: -40°C to +85°C
5. Moisture Sensitive Level: MSL 1

ELECTRICAL CHARACTERISTICS:

Terminating source impedance: $Z_s = 50 \Omega$

Terminating load impedance: $Z_L = 50 \Omega$

Item	Unit	Min.	Type.	Max.
Center Frequency	MHz	-	322.25	-
Insertion Loss (321 ~ 323.44 MHz)	dB	-	1.5	3.0
Amplitude Ripple (321 ~ 323.44 MHz)	MHz	-	0.2	1.5
VSWR (321~ 323.44 MHz)	-	-	1.1	2.5
Attenuation				
300.85 MHz	dB	50	77	-
343.65 MHz	dB	35	56	-
Temperature Coefficient of Frequency	ppm/C°	-	-36	-

 **CAUTION: Electrostatic Sensitive Device. Observe precautions for handling.**

NOTES:

1. The design, manufacturing process, and specifications of this device are subject to change.
2. US or International patents may apply.
3. RoHS compliant from the first date of manufacture.

MEASUREMENT CIRCUIT:

HP Network analyzer

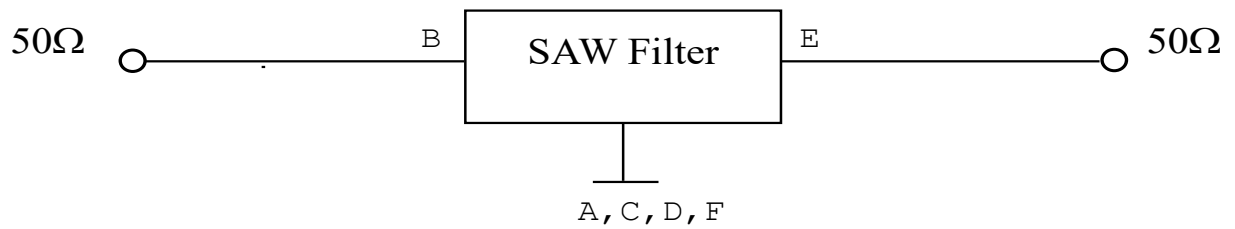

OUTLINE DRAWING:

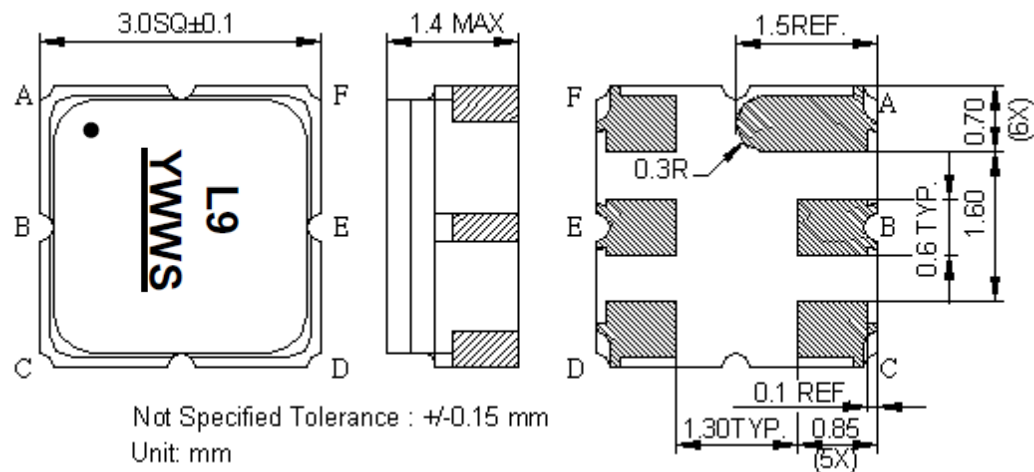

B: Input

E: Output

A,C,D,F: Ground Unit : mm

Marking:

Y = Year

WW = Week

S = Shift

PCB FOOTPRINT:

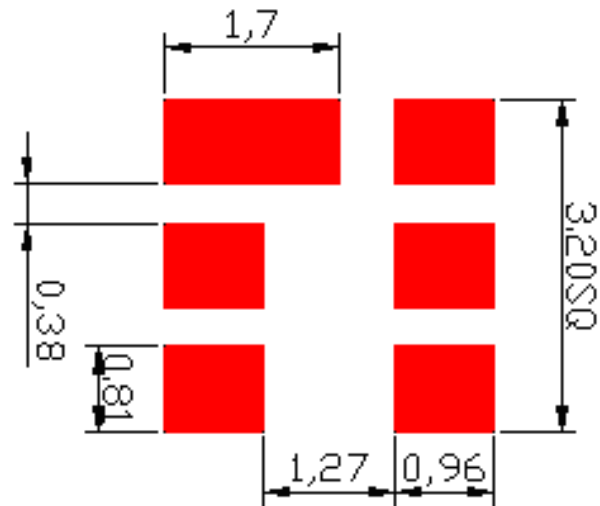

FREQUENCY CHARATERISTICS:

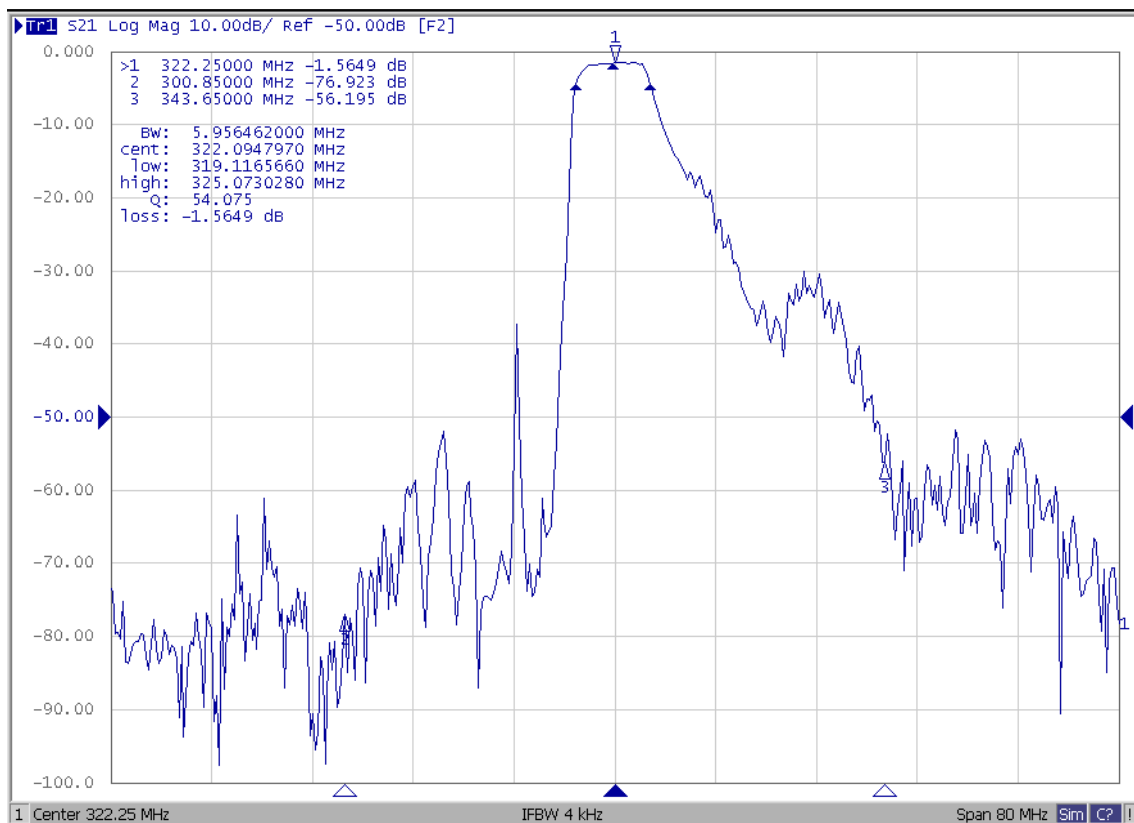

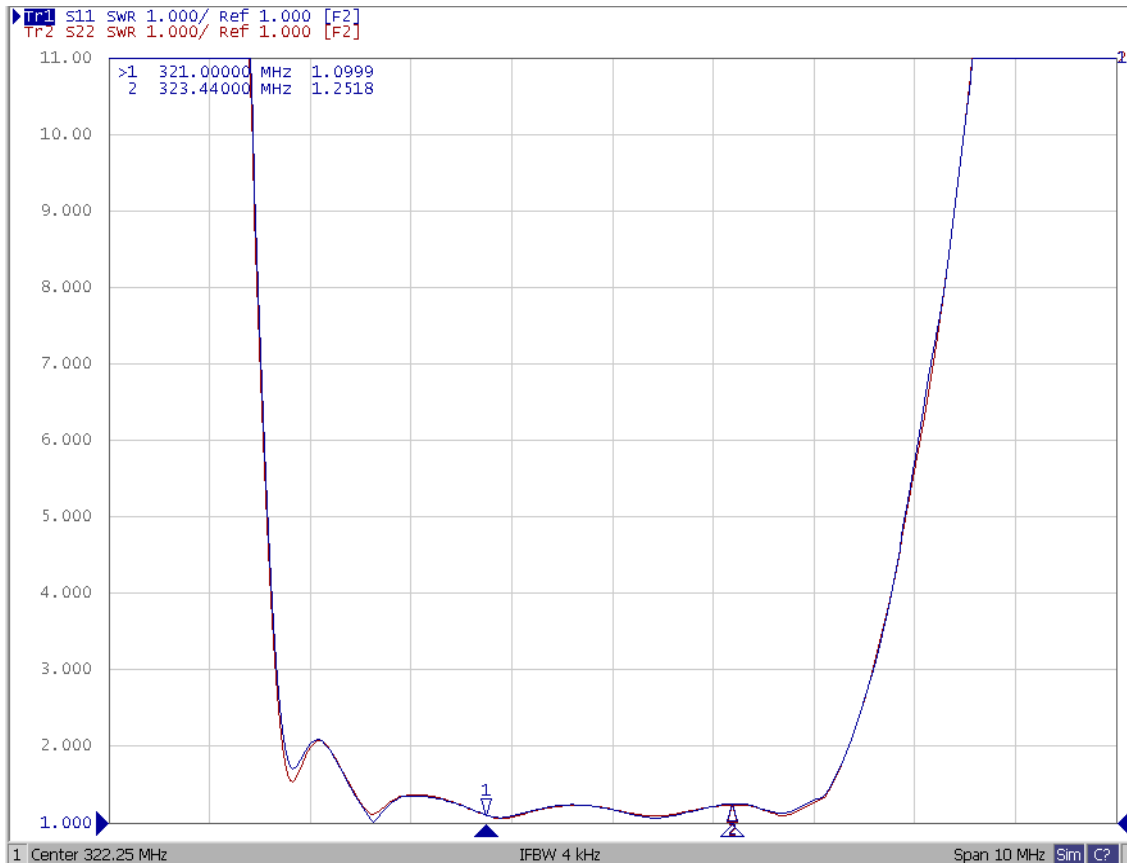
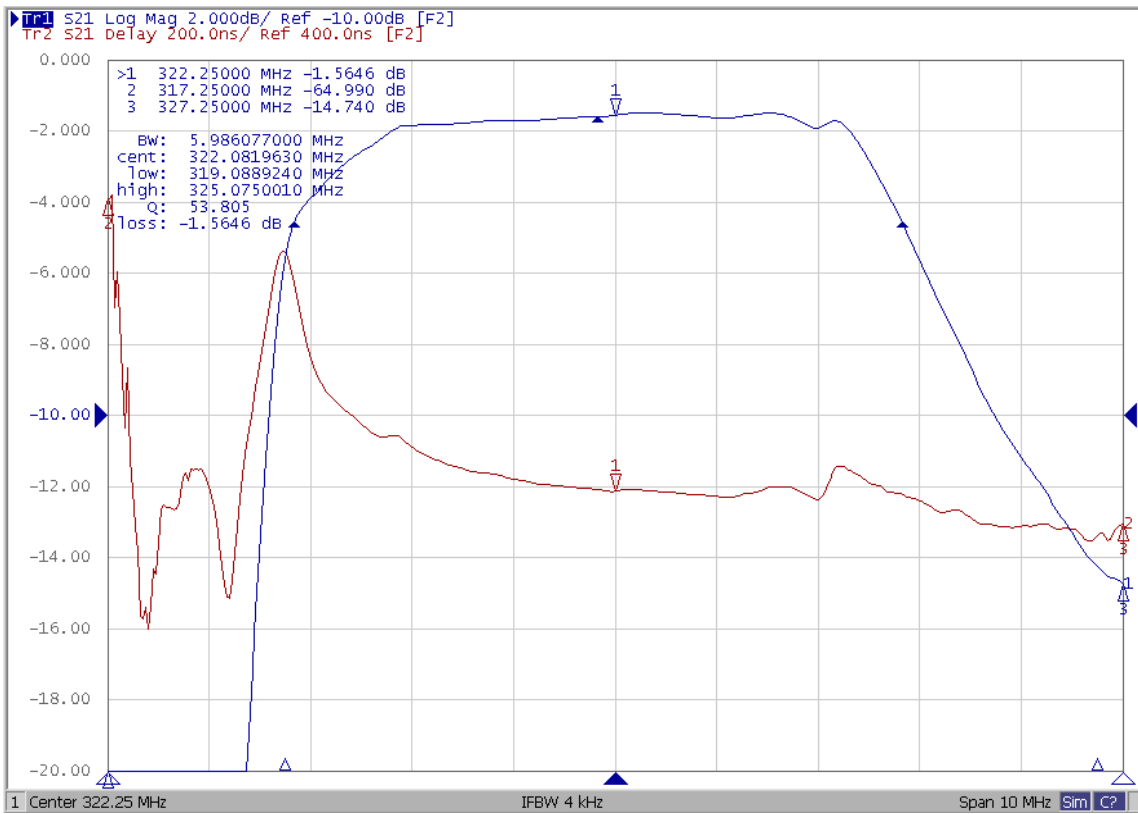

PACKING:

REEL DIMENSION

Reel Count:

7" = 500

13" = 3000

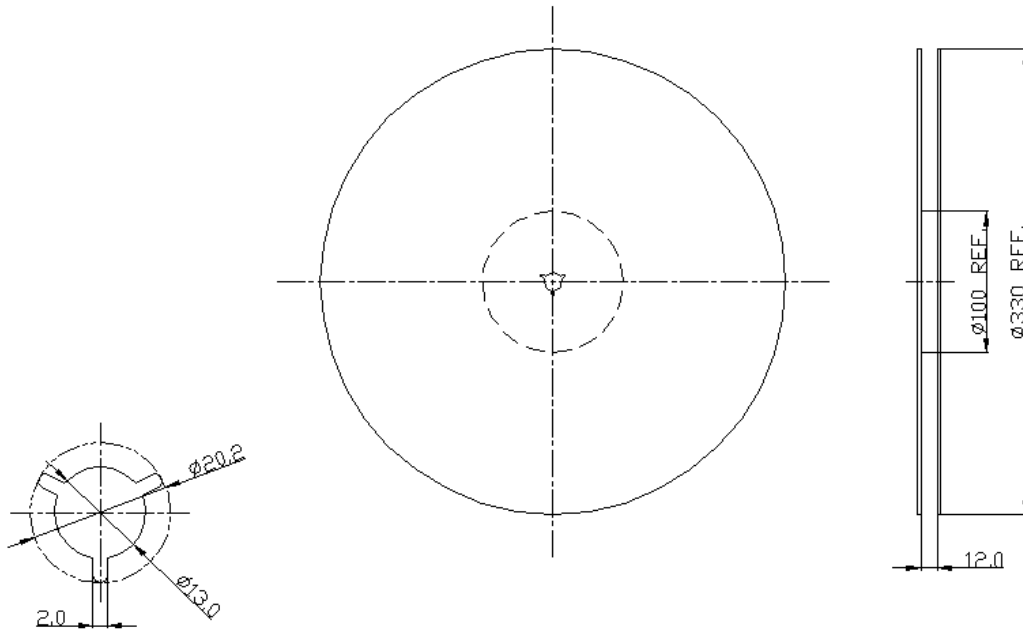

TAPE DIMENSION

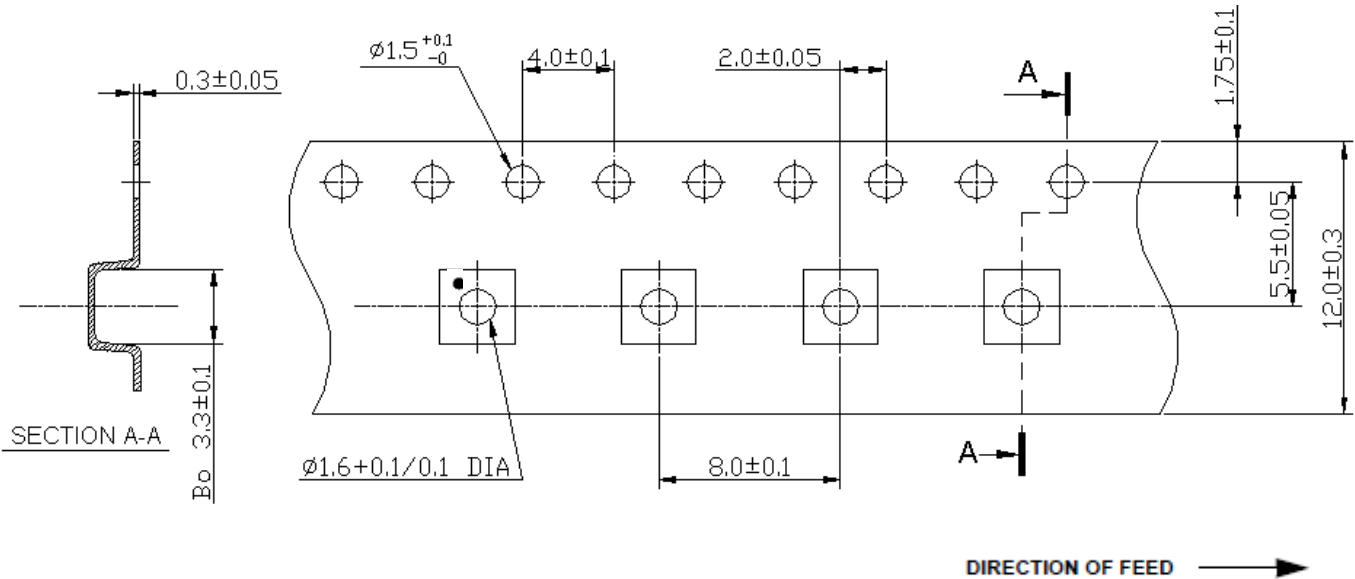

RECOMMENDED REFLOW PROFILE :

- 1. Preheating shall be fixed at 150~180°C for 60~90 seconds.
- 2. Ascending time to preheating temperature 150°C shall be 30 seconds min.
- 3. Heating shall be fixed at 220°C for 50~80 seconds and at 260°C+0/-5°C peak (20~40sec).
- 4. Time: 2 times.

