

SF2650E

**3450 MHz
SAW Filter**

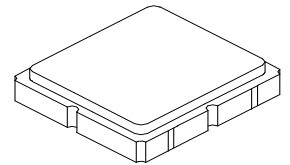

SM3030-6

MAXIMUM RATING:

- Input Power Level: 20 dBm
- DC voltage: 3 V
- Operating Temperature: -40°C to +85°C
- Storage Temperature: -40°C to +85°C
- Moisture Sensitivity Level: Level 1(MSL1)
- AEC-Q00 Qualified

ELECTRICAL CHARACTERISTICS:

Item	Unit	Min.	Typ.	Max.
Center frequency Fc	MHz	-	3450	-
Insertion Loss (3400.86~3499.14 MHz) IL	dB	-	3.9	5.2
Amplitude Ripple (3400.86~3499.14 MHz)	dB _{p-p}	-	1.7	3.0
Attenuation (Reference level from 0 dB)				
3260 MHz	dB	30	41	-
3295 MHz	dB	25	33	-
3380 MHz	dB	2.5	4.5	-
3520 MHz	dB	2.5	5	-
3575 MHz	dB	25	43	-
Temperature Coefficient of Frequency	ppm/°C	-	-36	-

MEASUREMENT CIRCUIT:

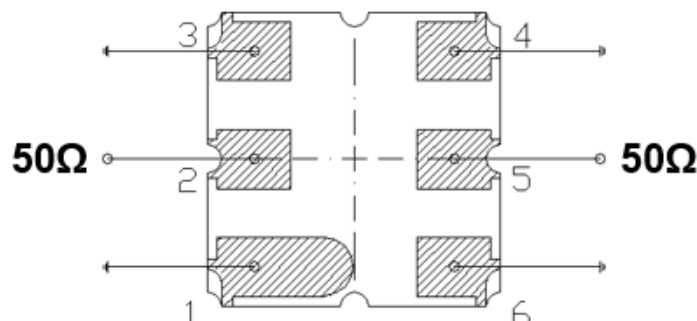

(2): Unbalance Port

(5): Unbalance Port

Others: Ground



CAUTION: Electrostatic Sensitive Device. Observe precautions for handling.

1. The design, manufacturing process, and specifications of this device are subject to change.
2. US or International patents may apply.
3. RoHS compliant from the first date of manufacture.

OUTLINE DRAWING:

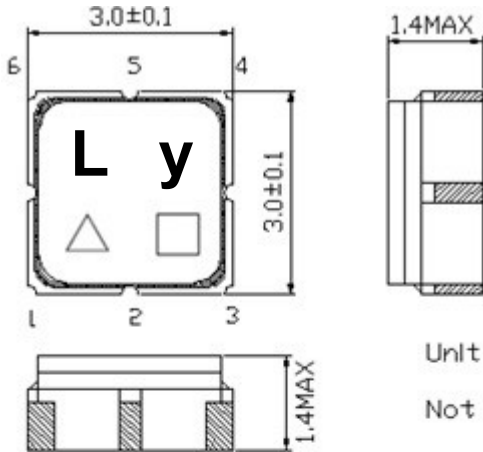

Unit : mm

Not Specified Tolerance : +/-0.15 mm

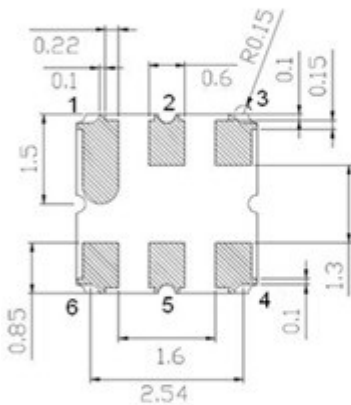

Pin No.	Symbol	Function
1	GND	Ground
2	IN	Input
3	GND	Ground
4	GND	Ground
5	OUT	Output
6	GND	Ground

△ : Year Code (2011->1, 2012->2, ..., 2019->9, 2020->0)

□ : Date Code

Date Code Table:

WK01	WK02	WK03	WK04	WK05	WK06	WK07	WK08	WK09	WK10	WK11	WK12	WK13
A	B	C	D	E	F	G	H	I	J	K	L	M
WK14	WK15	WK16	WK17	WK18	WK19	WK20	WK21	WK22	WK23	WK24	WK25	WK26
N	O	P	Q	R	S	T	U	V	W	X	Y	Z
WK27	WK28	WK29	WK30	WK31	WK32	WK33	WK34	WK35	WK36	WK37	WK38	WK39
a	b	c	d	e	f	g	h	i	j	k	l	m
WK40	WK41	WK42	WK43	WK44	WK45	WK46	WK47	WK48	WK49	WK50	WK51	WK52
n	o	p	q	r	s	t	u	v	w	x	y	z

PCB Footprint:

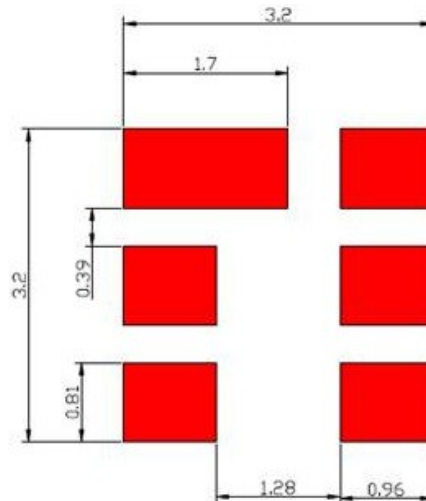

Frequency Characteristics:

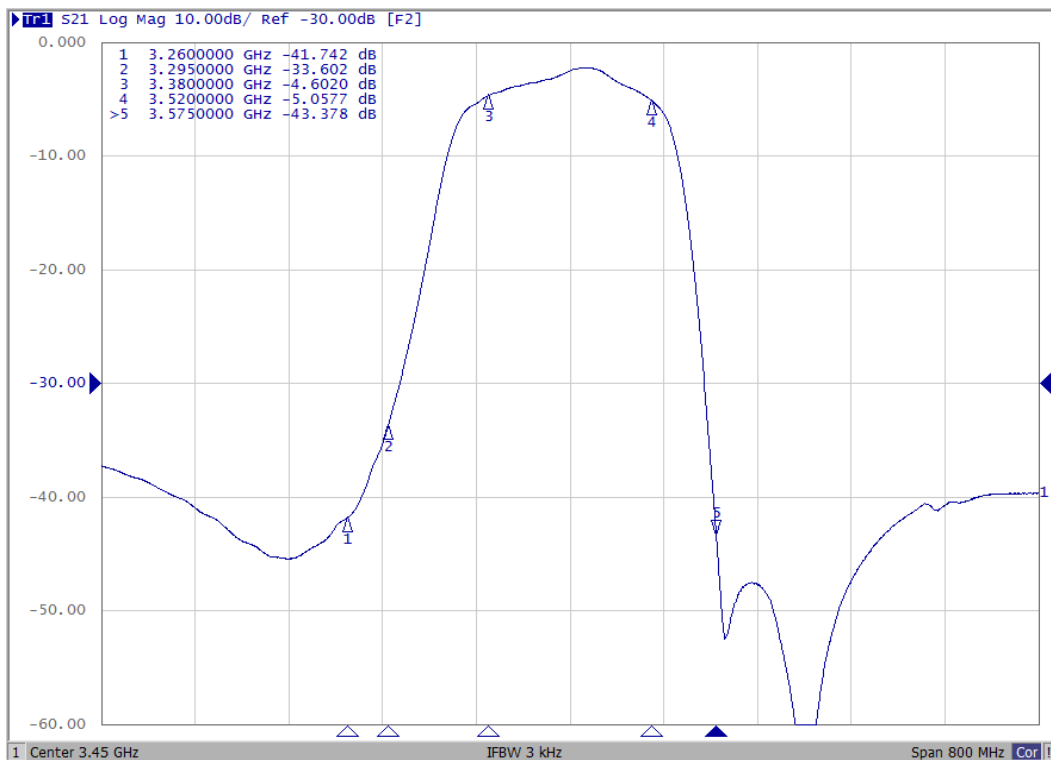
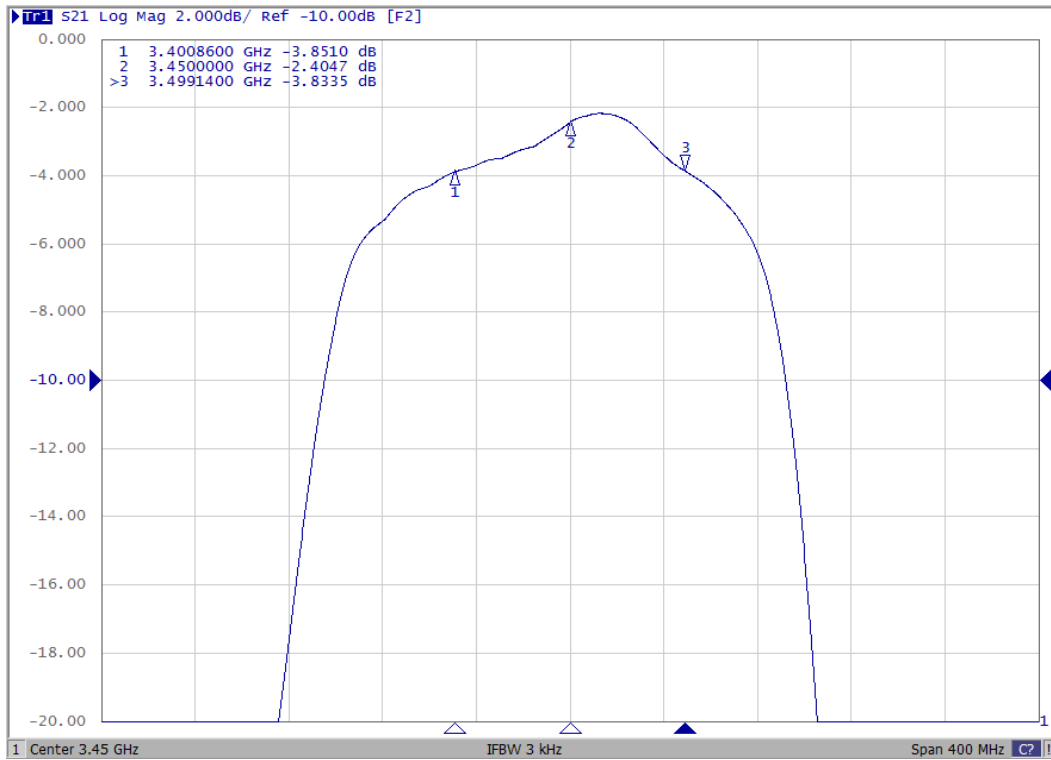

PACKING:

1. REEL DIMENSION

Reel Count:

7" = 500

13" = 3000

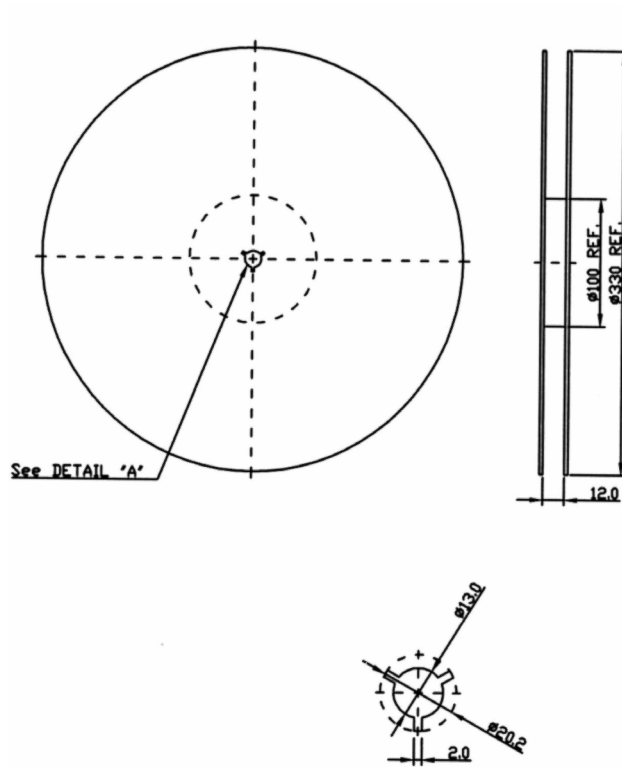

2. TAPE DIMENSION

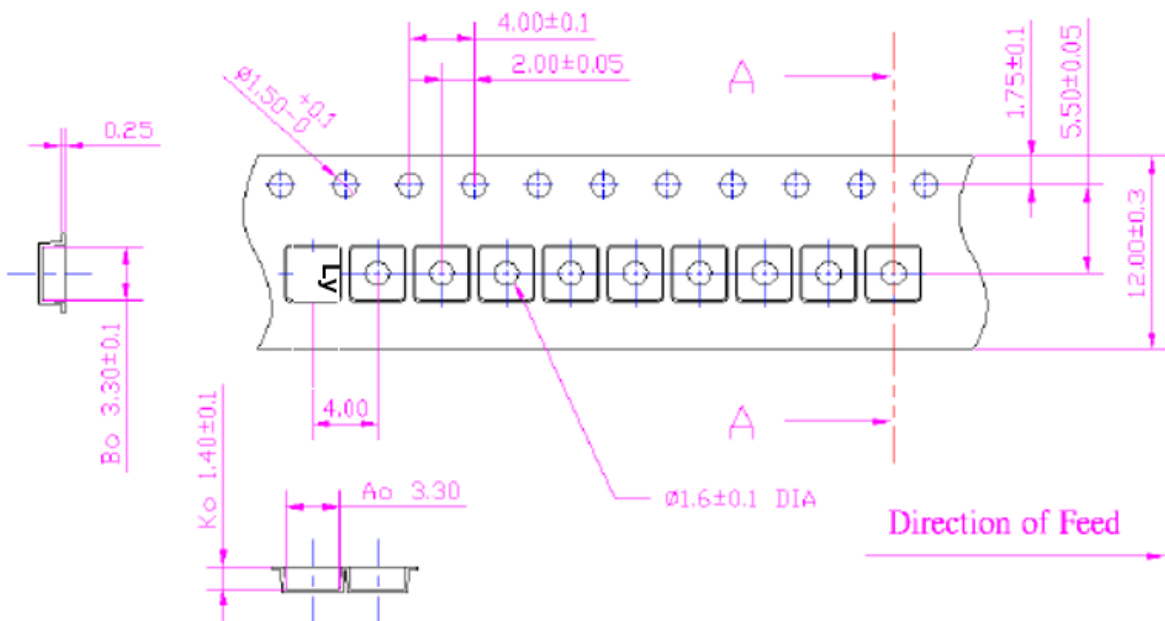

Recommended Reflow Profile:

1. Preheating shall be fixed at 150~180°C for 60~90 seconds.
2. Ascending time to preheating temperature 150°C shall be 30 seconds min.
3. Heating shall be fixed at 220°C for 50~80 seconds and at 260°C +0/-5°C peak (20~40sec).
4. Time: 2 times.

