

SF2651K

1746.5 MHz
SAW Filter

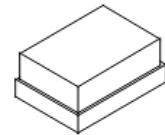

SM1411-5

MAXIMUM RATING:

- Input Power Level: 10 dBm
- DC Voltage : 0V
- Operating Temperature: -40°C to +85°C
- Storage Temperature: -40°C to +85°C
- Moisture Sensitivity Level: Level 3(MSL3)

ELECTRICAL CHARACTERISTICS:

Terminating source impedance (single) : $Z_s = 50 \Omega$
 Terminating load impedance(single) : $Z_L = 50 \Omega$

Item	Unit	Min	Type.	Max	Note
Center Frequency Fc	MHz	-	1746.5	-	
Insertion Loss (1710~1783 MHz) IL	dB		3	5	23 ~ 27°C
Amplitude ripple (1710~1783 MHz)			1.5	3.5	23 ~ 27°C
VSWR (1710~1783 MHz)			2.5	3.0	23 ~ 27°C
Attenuation					
800 ~ 1670 MHz	dB	25	30		23 ~ 27°C
1795 ~ 2000 MHz	dB	10	15		23 ~ 27°C
2000 ~ 3000 MHz	dB	20	25		
Temperature coefficient	ppm/°C	-36			
Package size	mm	1411			



CAUTION: Electrostatic Sensitive Device. Observe precautions for handling.

NOTES:

1. The design, manufacturing process, and specifications of this device are subject to change.
2. US or International patents may apply.
3. This component was always RoHS compliant from the first date of manufacture.

OUTLINE DRAWING:

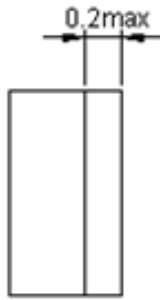
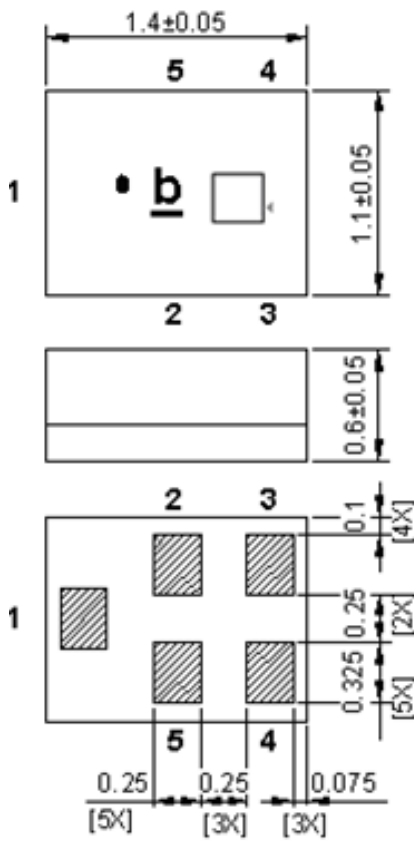

Symbol:

b – assigned by manufacturer

□ Year/Month code

All tolerances are ± 0.05 mm unless otherwise specified

Coplanarity : 0.1 mm max.

1 to 5 : Pin No.

Unit : mm

Pin No.	Symbol	Function
1	IN	Input
2	GND	Ground
3	GND	Ground
4	OUT	Output
5	GND	Ground

MEASUREMENT CIRCUIT:

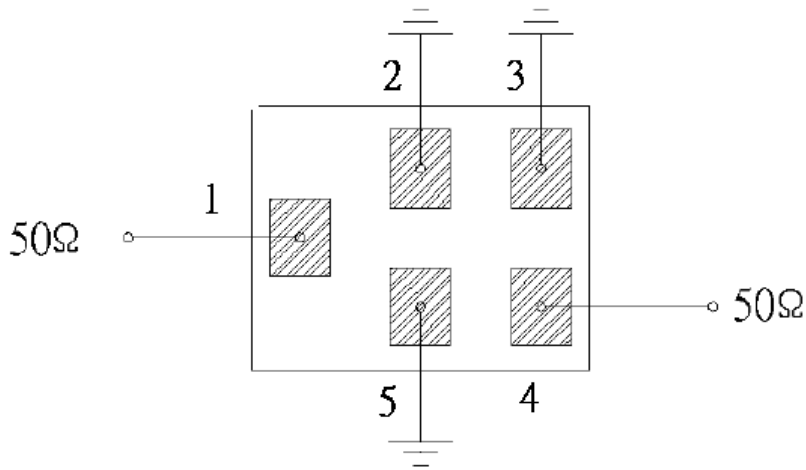

**Frequency Characteristics:
S21 response: (span 400MHz)**

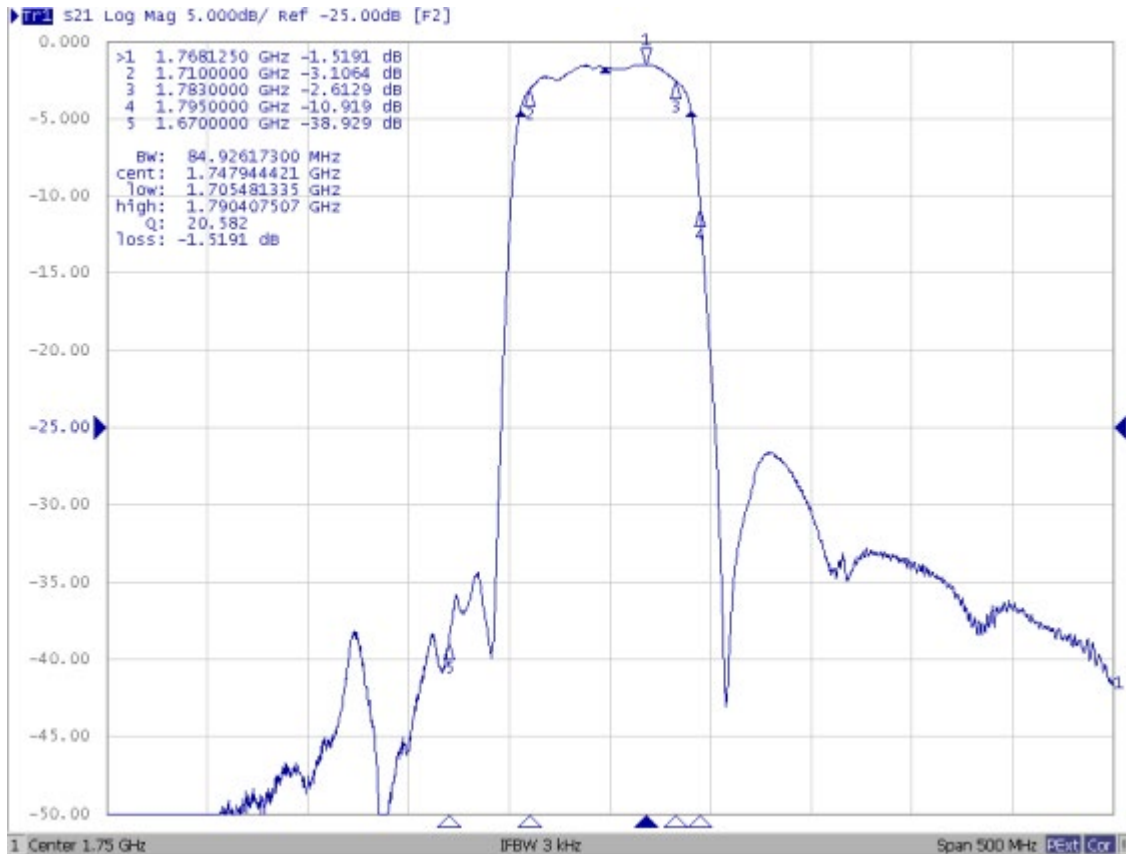

S21 response: (span 200MHz)



S21 response: (span 4.5GHz)

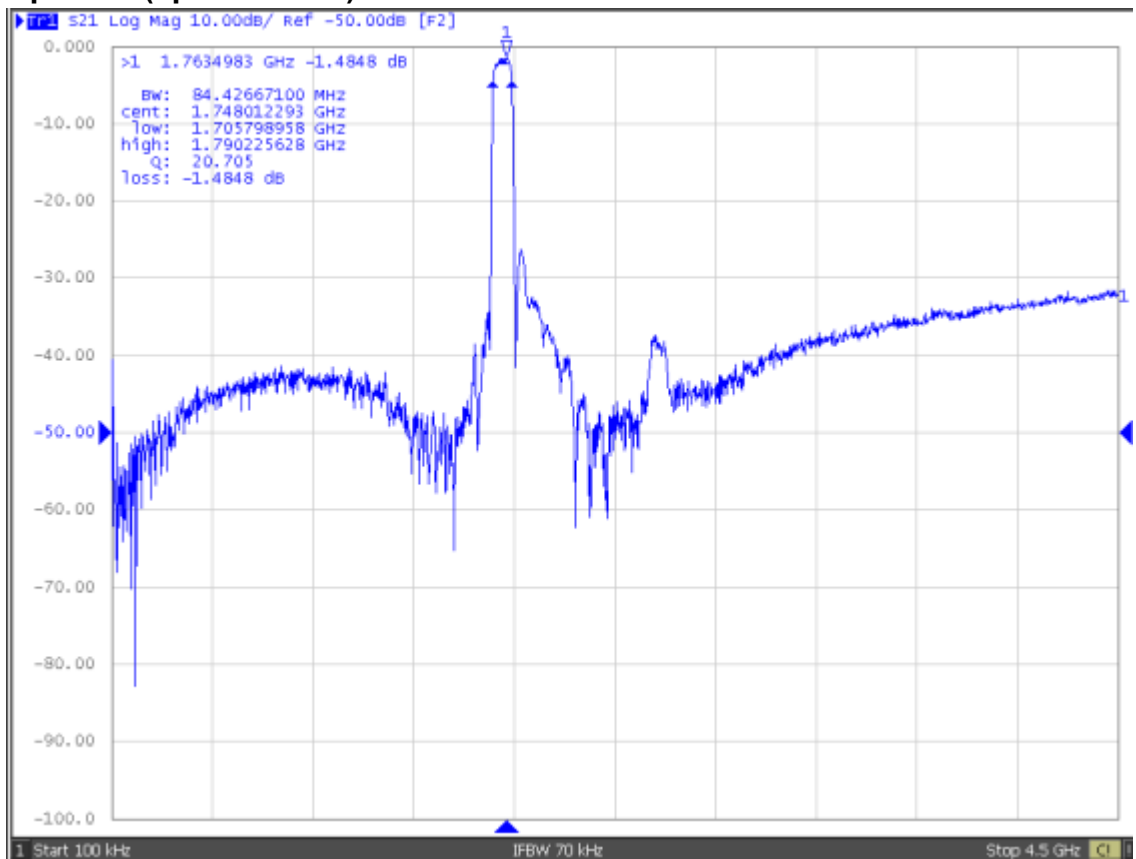

S11/S22 response: (span 400MHz)

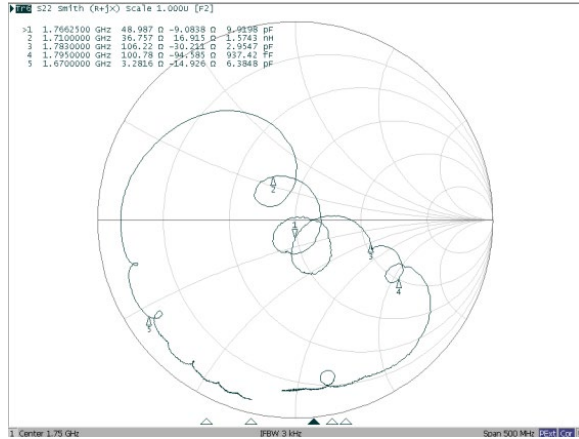
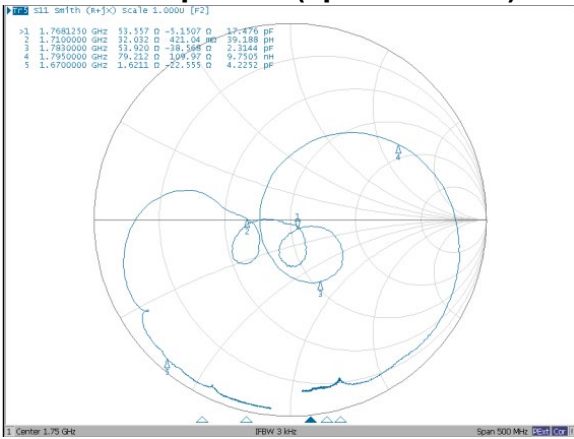

PCB Footprint:

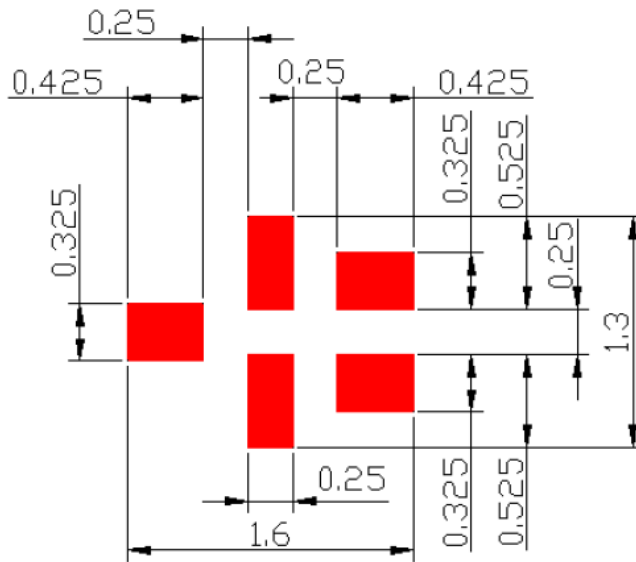

■ : Land Pattern

PACKING:
1. REEL DIMENSION

7" Reel = 3000

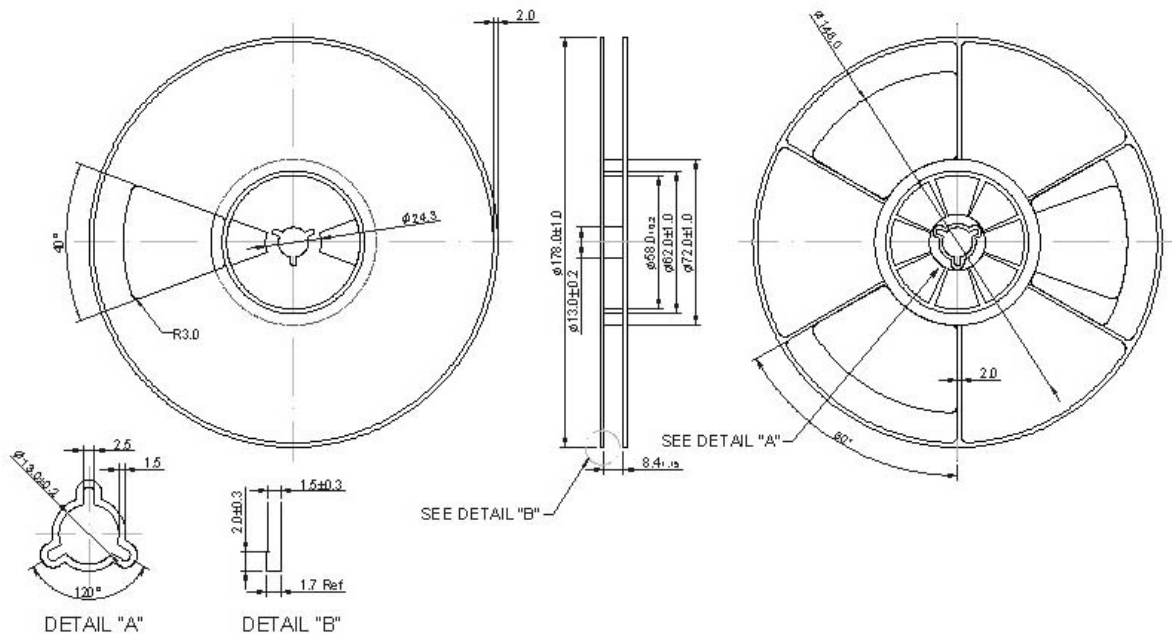

2. TAPE DIMENSION

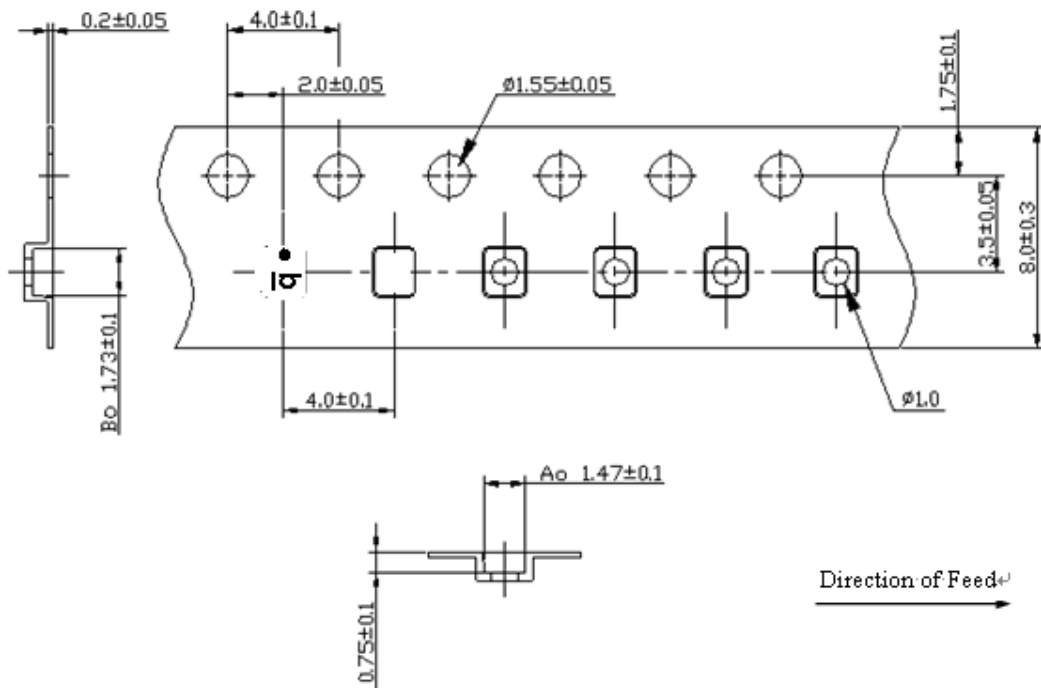

Recommended Reflow Profile:

1. Preheating shall be fixed at 150~180°C for 60~90 seconds.
2. Ascending time to preheating temperature 150°C shall be 30 seconds min.
3. Heating shall be fixed at 220°C for 50~80 seconds and at 260°C+0/-5°C peak (20~40sec).
4. Time: 2 times.

