

SM3030-6

A. MAXIMUM RATING:

1. Input Power Level: +5dB_m
2. Operating Temperature: -30°C to +85°C
3. Storage Temperature: -40°C to +85°C
4. Moisture Sensitivity Level: Level 1(MSL1)

B. ELECTRICAL CHARACTERISTICS:

Parameters	Unit	Min.	Typical	Max.
Nominal Center frequency, Fo	MHz	-	265.55	-
Insertion Loss at Fo	dB	-	3.2	4.2
3 dB Bandwidth	KHz	260	580	-
Amplitude ripple, Fo ± 100 KHz	dB	-	0.8	1.2
Group delay ripple, Fo ± 100 KHz	μsec	-	0.3	1.2
Attenuation(Reference level from 0dB)				
264.95 MHz, 266.15 MHz	dB	25	30	-
254.85 MHz, 276.25 MHz	dB	40	60	-
244.15 MHz, 286.95 MHz	dB	60	62	-

***Fo is fixed frequency defined on 265.55MHz**



CAUTION: Electrostatic Sensitive Device. Observe precautions for handling.

NOTES:

1. The design, manufacturing process, and specifications of this device are subject to change.
2. US or International patents may apply.
3. RoHS compliant from the first date of manufacture.

C. FREQUENCY CHARACTERISTICS:

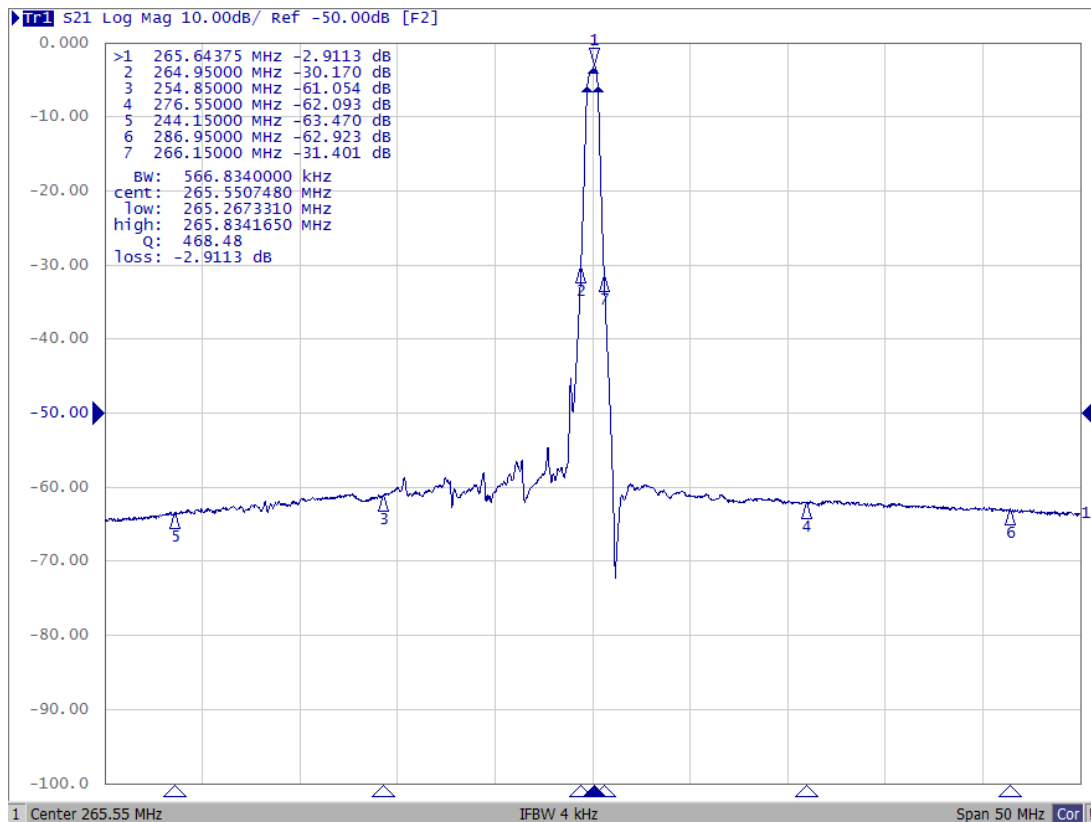
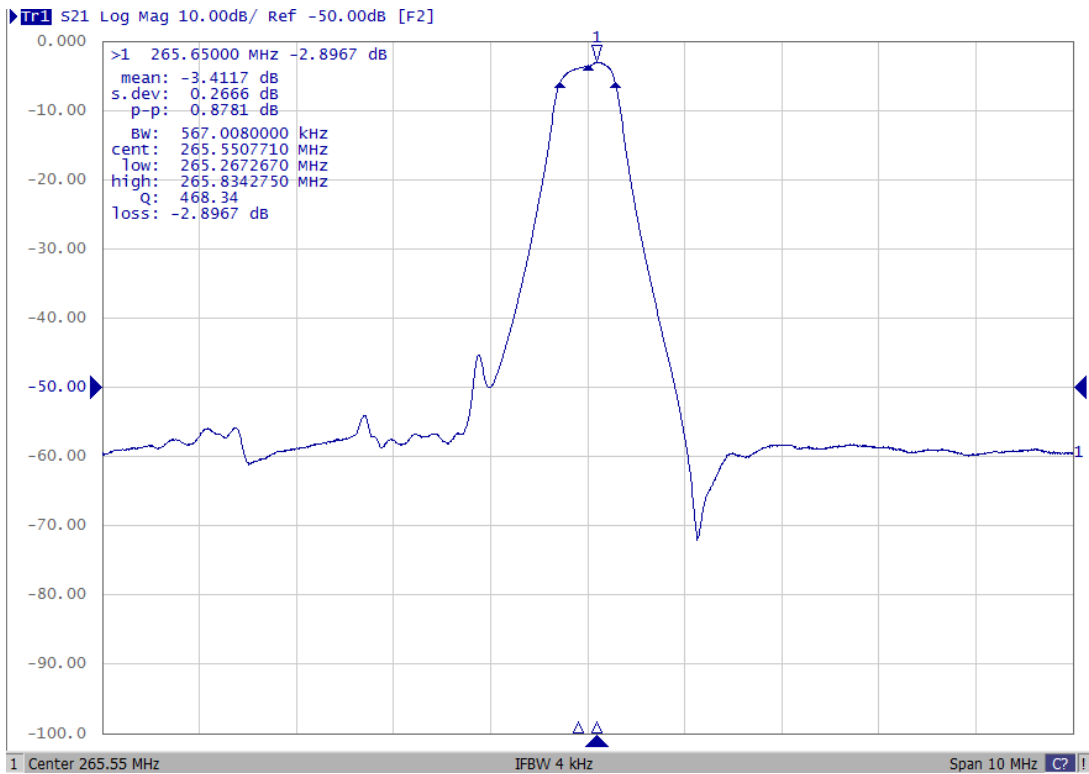

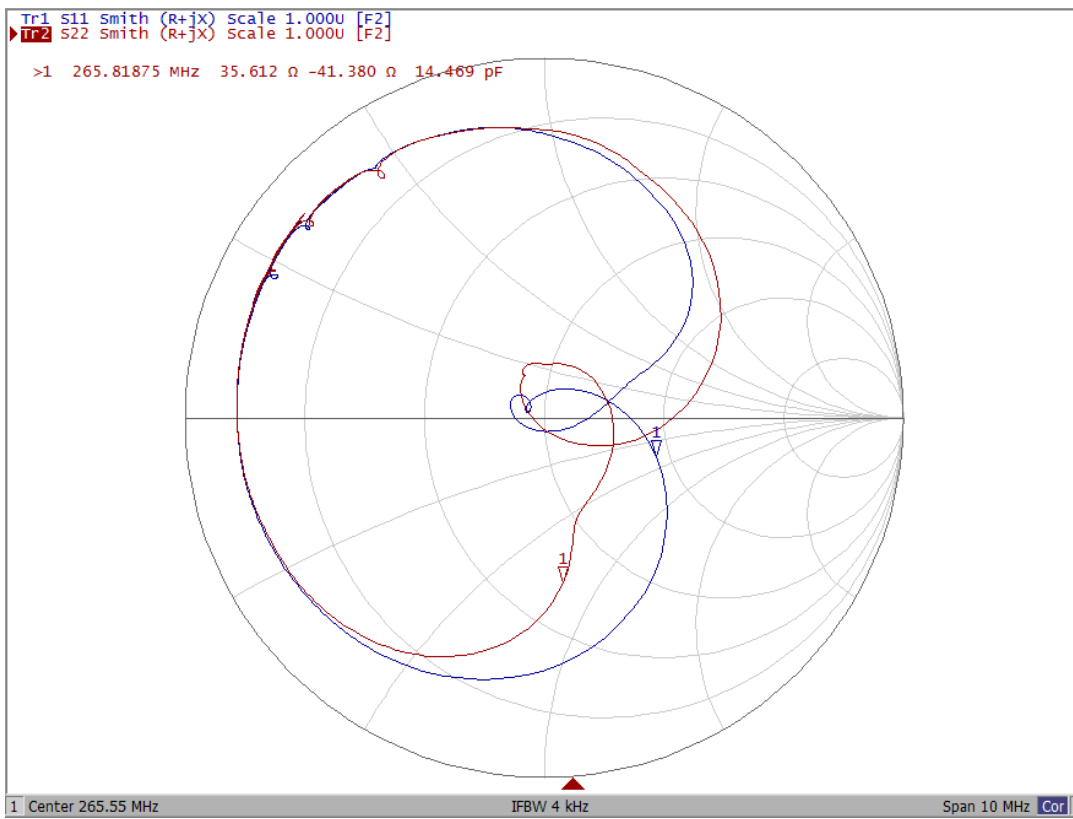

D. MEASUREMENT CIRCUIT:

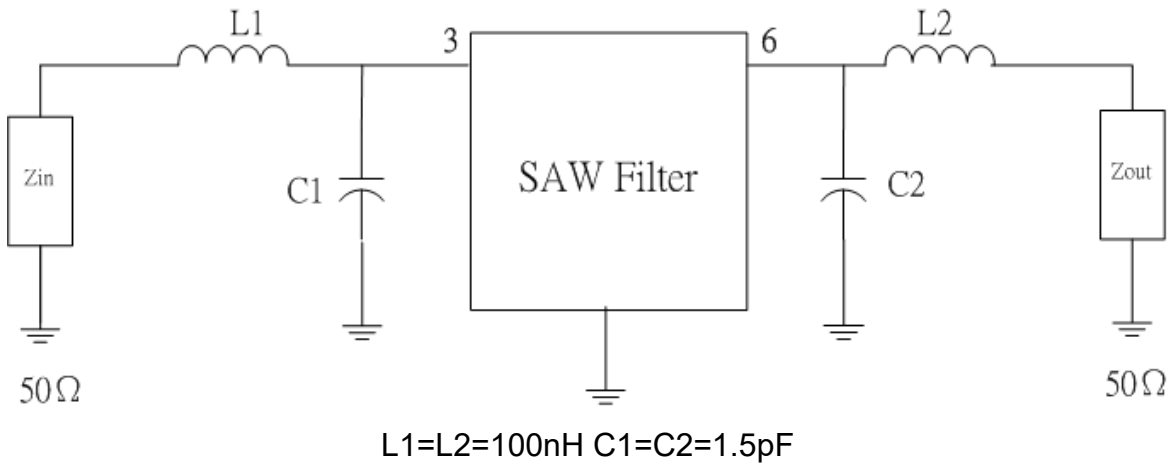

E.OUTLINE DRAWING:

**6-Terminal Ceramic Surface-Mount Case
3.0 X 3.0 mm Nominal Footprint**

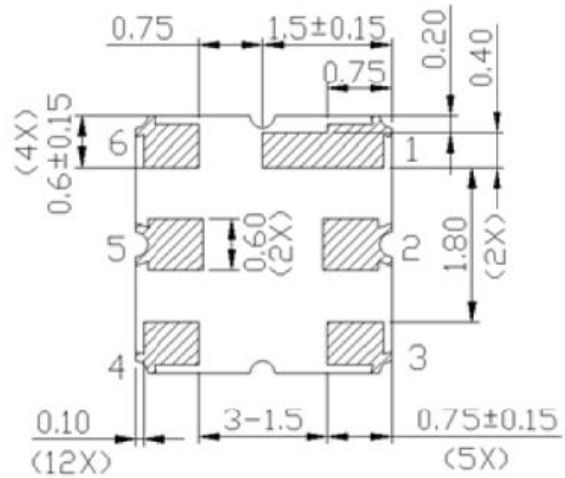
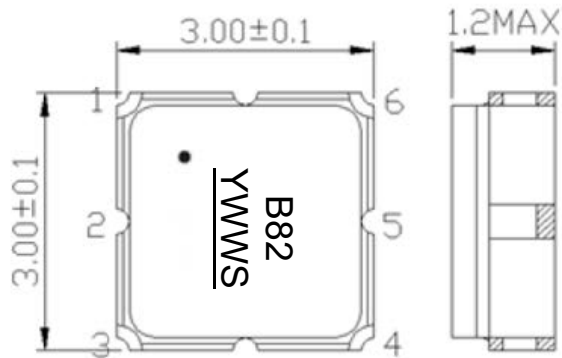

Not Specified Tolerance : +/-0.15 mm
Unit: mm

Y= Year WW = Week S = Shift

Case Materials

Materials	
Solder Pad Plating	0.3 to 1.0 μ m Gold over 1.27 to 8.89 μ m Nickel
Lid Plating	2.0 to 3.0 μ m Nickel
Body	Al ₂ O ₃ Ceramic

F. PCB FOOTPRINT:

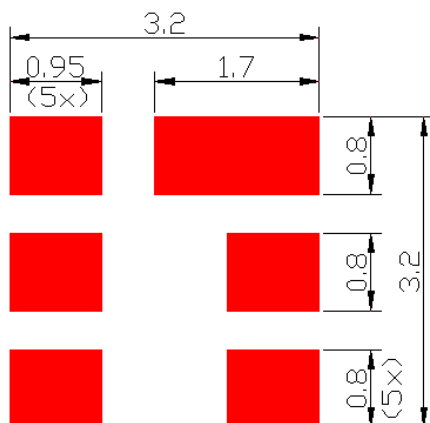

Unit: mm

Pin no.	Connection
1	GND
2	GND
3	IN/OUT
4	GND
5	GND
6	OUT/IN

G. PACKING:

Reel Count

7" = 500

13" = 3000

1. REEL DIMENSION

Tape and Reel Standard per ANSI/EIA-481

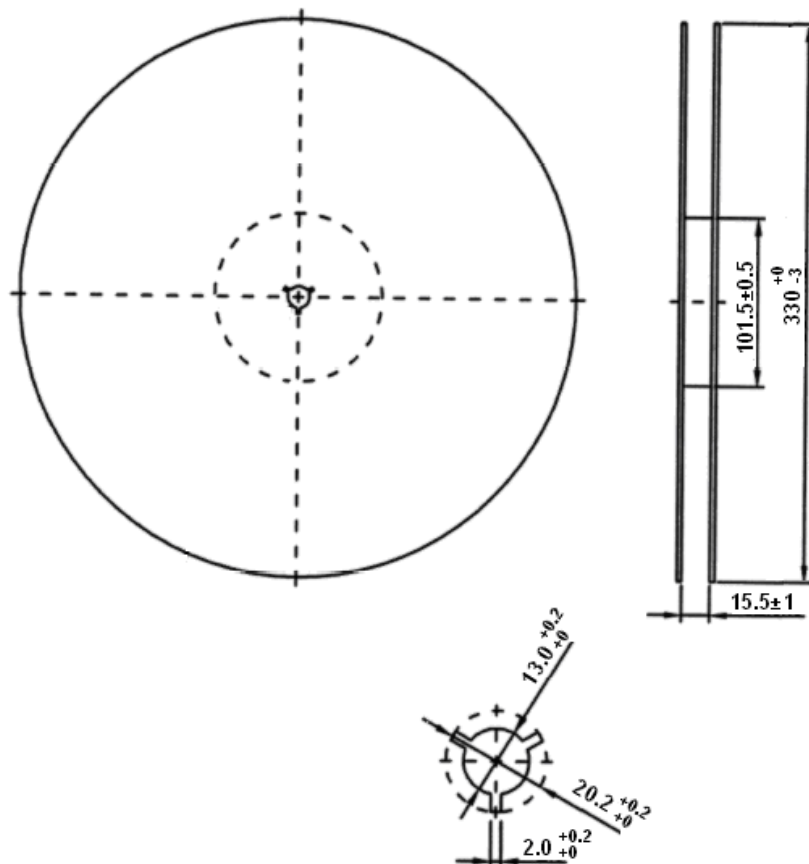

2. TAPE DIMENSION

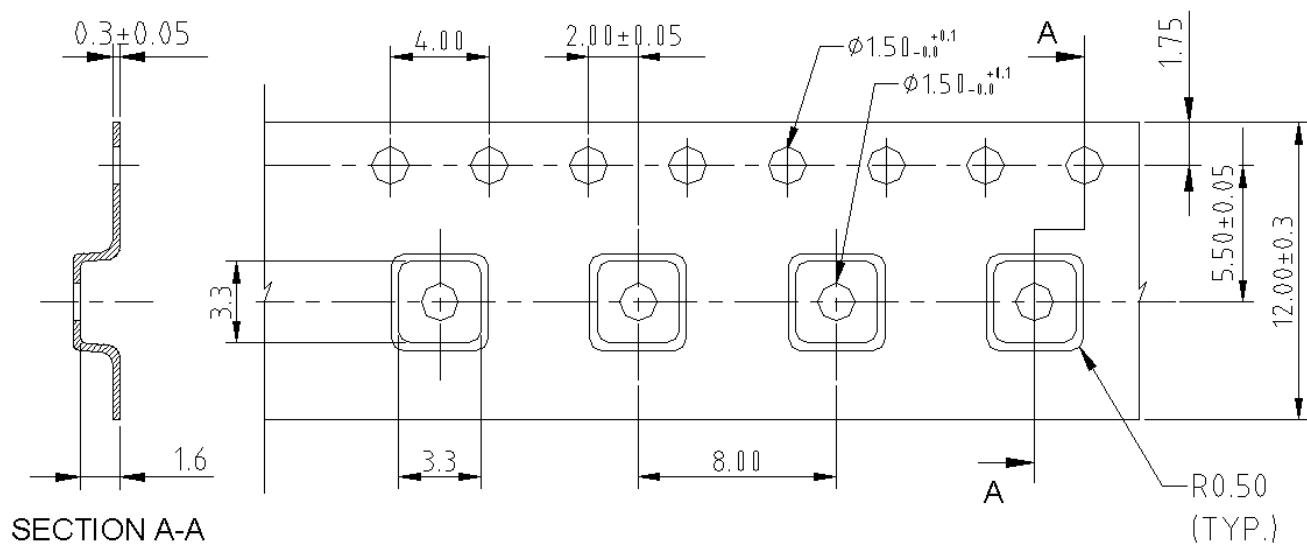

H. RECOMMENDED REFLOW PROFILE:

1. Preheating shall be fixed at 150~180°C for 60~90 seconds.
2. Ascending time to preheating temperature 150°C shall be 30 seconds min.
3. Heating shall be fixed at 220°C for 50~80 seconds and at 260°C+0/-5°C peak (20~40sec).
4. Time: 2 times.

