

SM1411-5

MAXIMUM RATING:

- Input Power Level: 10 dB_m
- DC voltage: 3 V
- Operating Temperature: -40°C to +85°C
- Storage Temperature: -40°C to +85°C
- Moisture Sensitivity Level: Level 3(MSL3)
- HBM level = 500V , MM level = 200V ,CDM level = 1000V

Electrical Characteristics

Item	Unit	Min.	Typ.	Max.
Center frequency Fc	MHz	-	1542.5	-
Insertion Loss (1525~1560MHz) at 25°C IL	dB	-	2.1	2.7
Insertion Loss (1525~1560 MHz) IL	dB	-	2.1	3.5
Amplitude Ripple (1525~1560 MHz)	dB _{p-p}	-	0.7	1.8
VSWR (1525~1560 MHz)	-	-	2.0	2.4
Attenuation (Reference level from 0 dB)				
D.C. ~ 1480 MHz	dB	30	54	-
1630 ~ 3000 MHz	dB	30	40	-
Temperature coefficient of frequency	ppm/k	-	-36	-

MEASUREMENT CIRCUIT:

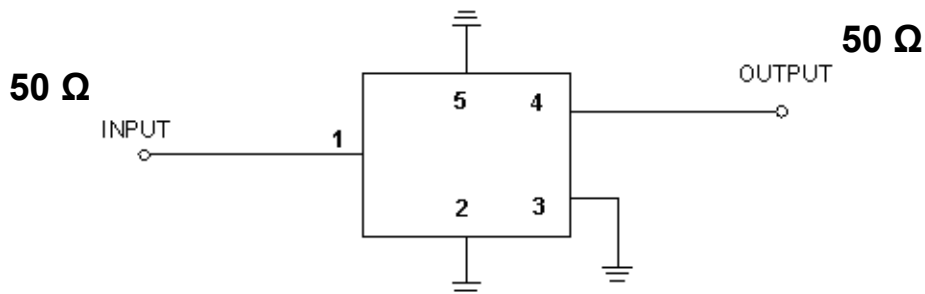

- (1): Unbalance Port**
- (4): Unbalance Port**
- Others: Ground**

OUTLINE DRAWING:

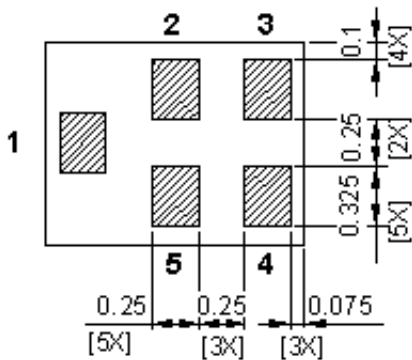
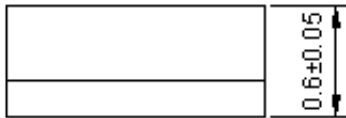
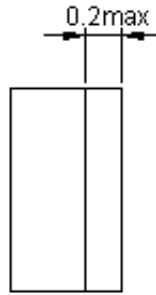
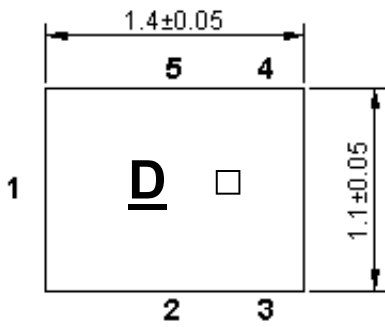

All tolerances are ± 0.05 mm unless otherwise specified
Coplanarity : 0.1 mm max.

1 to 5 : Pin No.

Unit : mm

Pin No.	Symbol	Function
1	IN	Input
2	GND	Ground
3	GND	Ground
4	OUT	Output
5	GND	Ground

□ : Year/Month Code (Follow the table) (8-year cycle)

YEAR/Month	1	2	3	4	5	6	7	8	9	10	11	12
2021	A	B	C	D	E	F	G	H	J	K	L	M
2022	N	P	Q	R	S	T	U	V	W	X	Y	Z
2023	a	b	c	d	e	f	g	h	j	k	l	m
2024	n	p	q	r	s	t	u	v	w	x	y	z
2025	<u>A</u>	<u>B</u>	<u>C</u>	<u>D</u>	<u>E</u>	<u>F</u>	<u>G</u>	<u>H</u>	<u>J</u>	<u>K</u>	<u>L</u>	<u>M</u>
2026	<u>N</u>	<u>P</u>	<u>Q</u>	<u>R</u>	<u>S</u>	<u>T</u>	<u>U</u>	<u>V</u>	<u>W</u>	<u>X</u>	<u>Y</u>	<u>Z</u>
2027	<u>a</u>	<u>b</u>	<u>c</u>	<u>d</u>	<u>e</u>	<u>f</u>	<u>g</u>	<u>h</u>	<u>j</u>	<u>k</u>	<u>l</u>	<u>m</u>
2028	<u>n</u>	<u>p</u>	<u>q</u>	<u>r</u>	<u>s</u>	<u>t</u>	<u>u</u>	<u>v</u>	<u>w</u>	<u>x</u>	<u>y</u>	<u>z</u>

PCB Footprint:

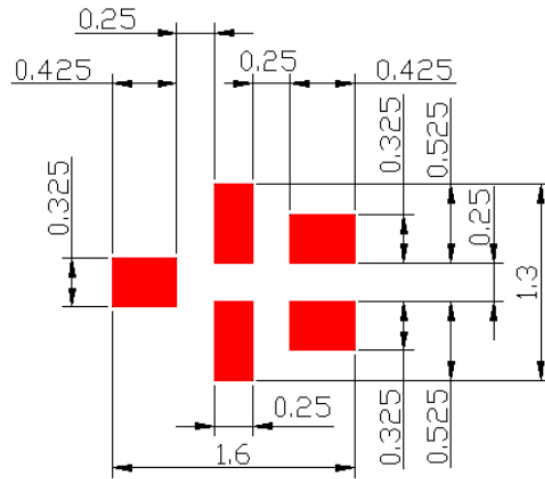

 : Land Pattern
Unit : mm

Frequency Characteristics:

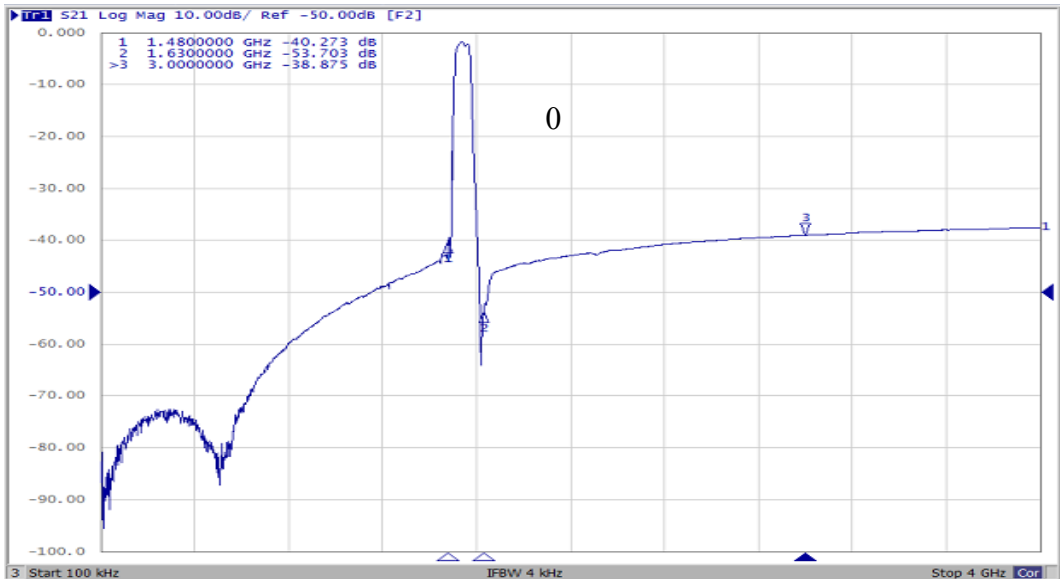
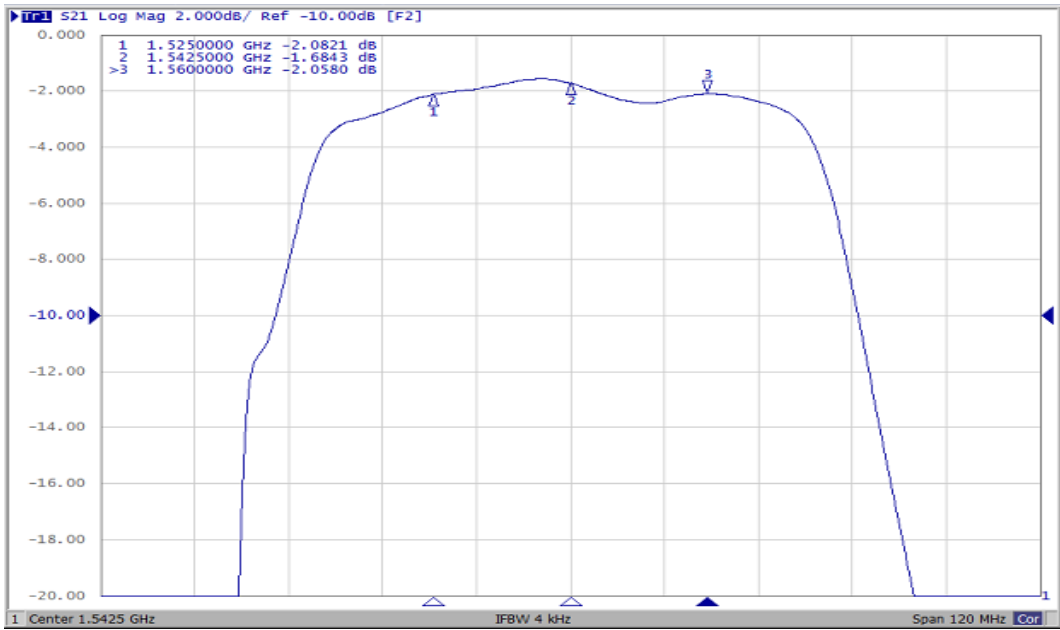

Reflection Functions:

S11

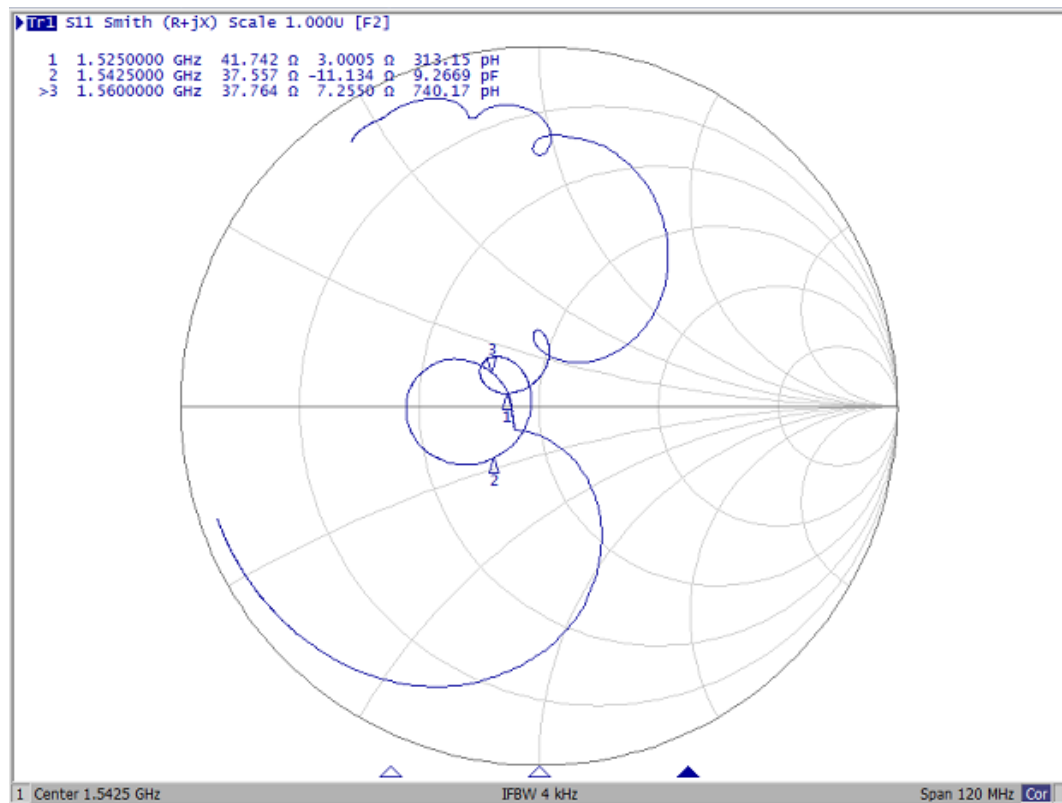
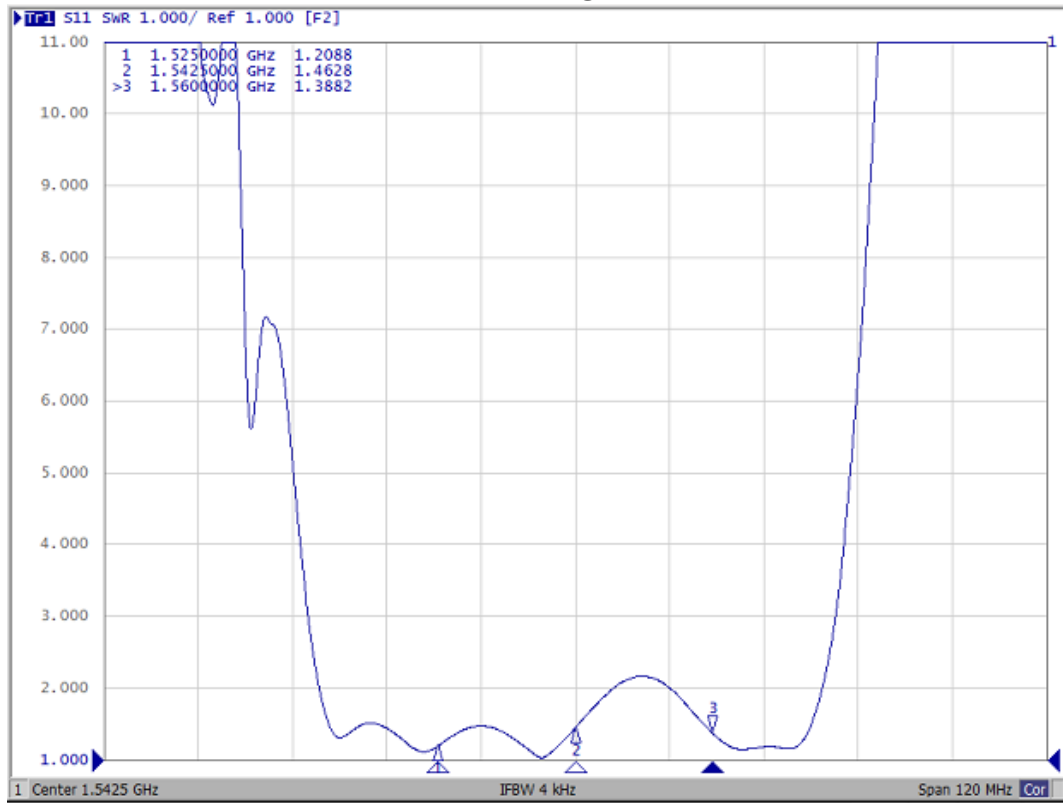

S22

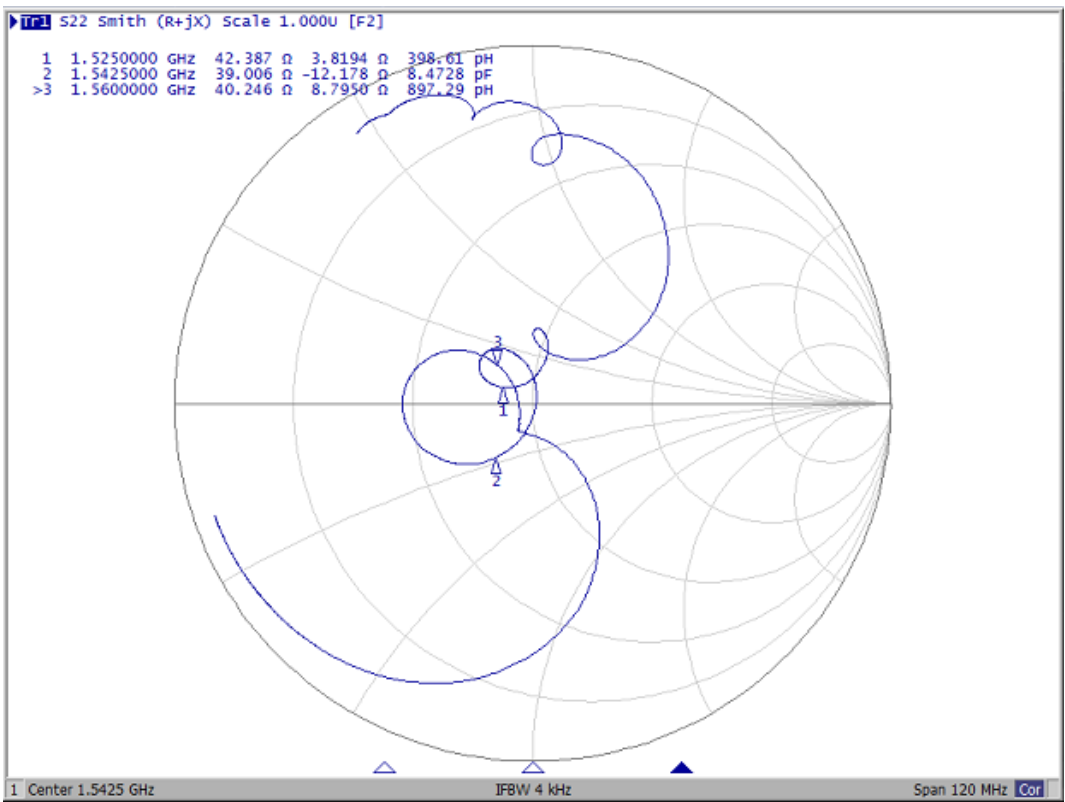
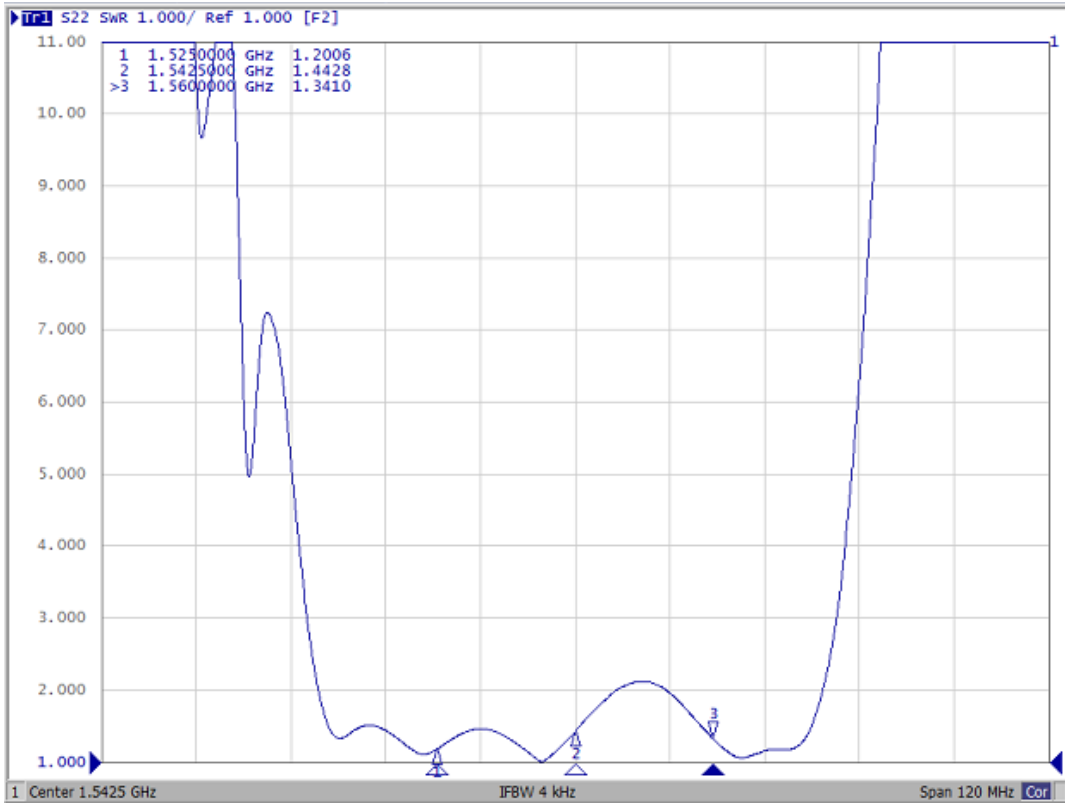

PACKING:

1. REEL DIMENSION

7" Reel = 3000

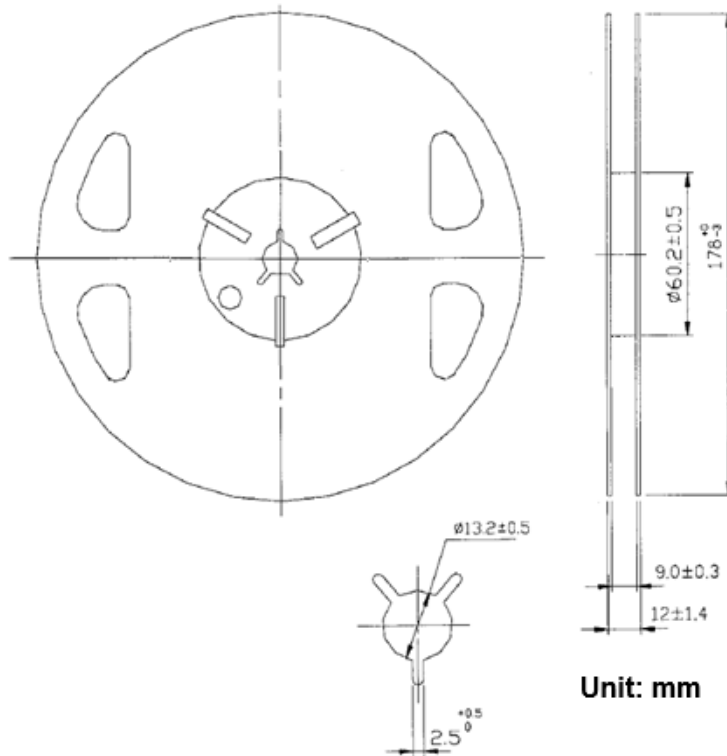

2. TAPE DIMENSION

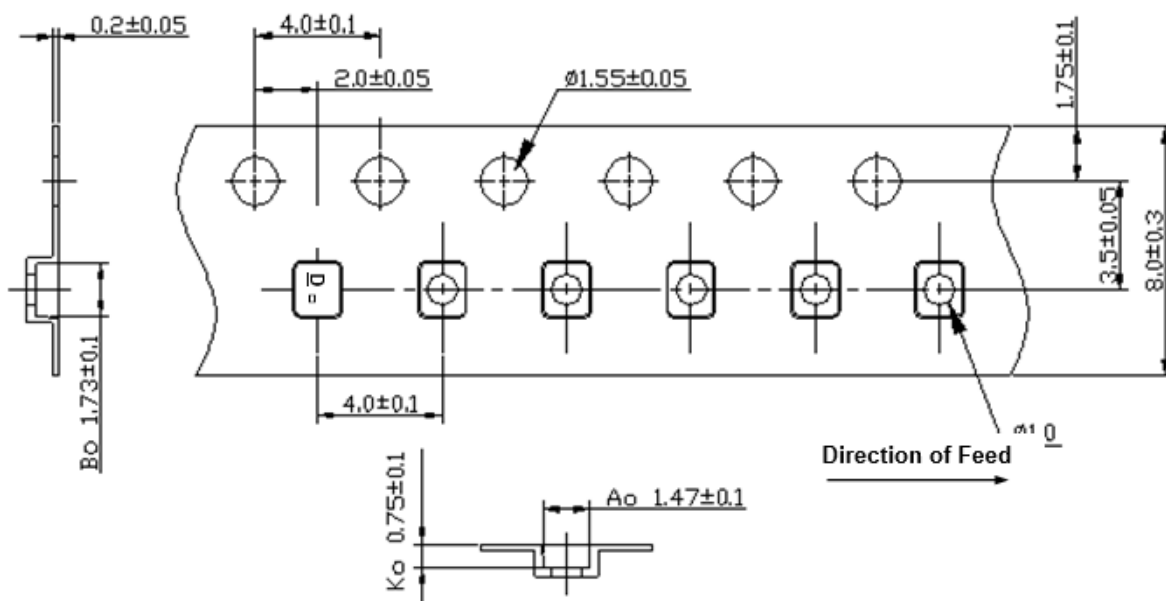

Recommended Reflow Profile:

1. Preheating shall be fixed at 150~180°C for 60~90 seconds.
2. Ascending time to preheating temperature 150°C shall be 30 seconds min.
3. Heating shall be fixed at 220°C for 50~80 seconds and at 260°C+0/-5°C peak (20~40sec).
4. Time: 2 times.

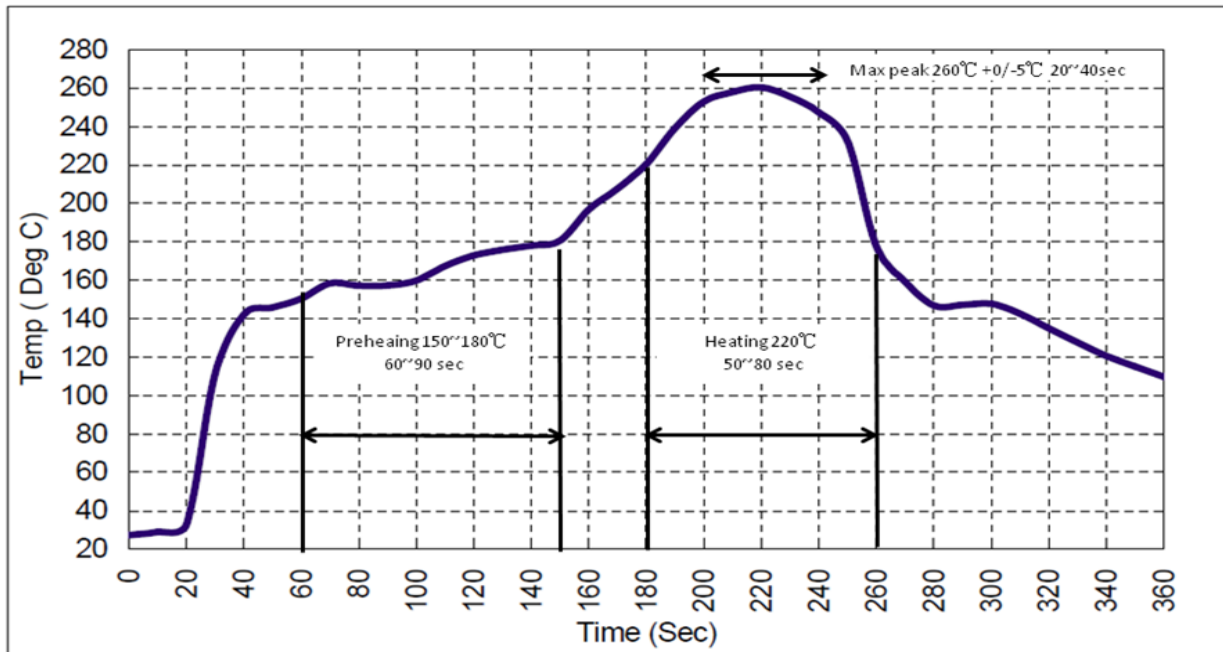

CAUTION: Electrostatic Sensitive Device. Observe precautions for handling.

NOTES:

1. The design, manufacturing process, and specifications of this device are subject to change.
2. US or International patents may apply.
3. This component was always RoHS compliant from the first date of manufacture.