

SF2734KM

**1278.75 MHz
SAW Filter**

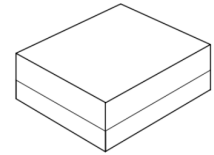

SM1411-5M

MAXIMUM RATING:

- Input Power Level: 10 dBm
- DC Voltage : 3 V
- Operating Temperature: -40°C to +85°C
- Storage Temperature: -40°C to +85°C
- Moisture Sensitivity Level: Level 1(MSL 1)
- AEC-Q200 Compliant

ELECTRICAL CHARACTERISTICS:

Item	Unit	Min.	Typ.	Max.	
Center frequency	Fc	MHz	-	1278.75	-
Insertion loss (1251.25~1306.25 MHz)	IL	dB	-	2.0	3.5
Amplitude ripple (1251.25~1306.25 MHz)		dB	-	0.5	1.2
Group delay ripple (1251.25~1306.25 MHz)		ns	-	13	50
Return loss (1251.25~1306.25 MHz)		dB	7	11	-
Attenuation (Reference level from 0 dB)					
10 ~ 1200 MHz		dB	20	34	-
1500 ~ 2100 MHz		dB	25	30	-
2100 ~ 3000 MHz		dB	30	35	-
Temperature coefficient of frequency		ppm/k	-	-36	-

MEASUREMENT CIRCUIT:

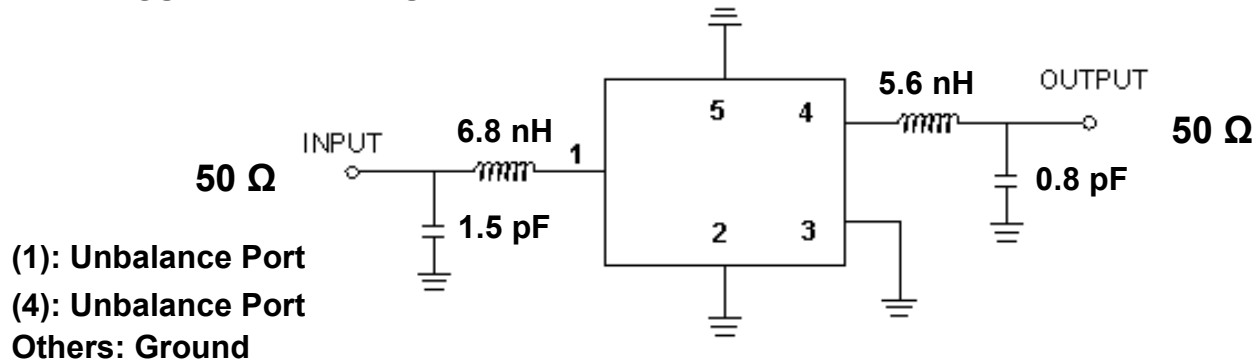

OUTLINE DRAWING:

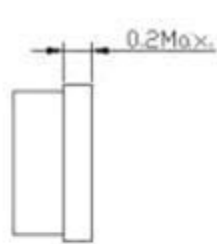
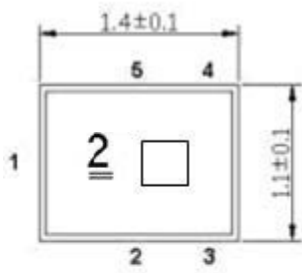

□ Year-Month
2 Symbol Code

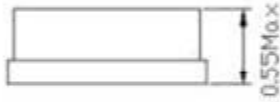

All tolerances are +/-0.05 mm unless otherwise specified
 Coplanarity : 0.1 mm max.
 1 to 5 : Pin No.
 Unit : mm

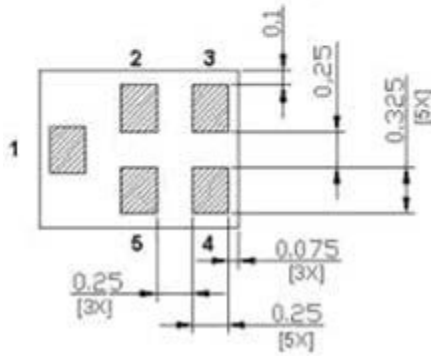

Pin No.	Symbol	Function
1	IN	Input
2	GND	Ground
3	GND	Ground
4	OUT	Output
5	GND	Ground

□ : Year/Month Code (Follow the table)

YEAR/Month	1	2	3	4	5	6	7	8	9	10	11	12
2021	A	B	C	D	E	F	G	H	J	K	L	M
2022	N	P	Q	R	S	T	U	V	W	X	Y	Z
2023	a	b	c	d	e	f	g	h	j	k	l	m
2024	n	p	q	r	s	t	u	v	w	x	y	z
2025	<u>A</u>	<u>B</u>	<u>C</u>	<u>D</u>	<u>E</u>	<u>F</u>	<u>G</u>	<u>H</u>	<u>J</u>	<u>K</u>	<u>L</u>	<u>M</u>
2026	<u>N</u>	<u>P</u>	<u>Q</u>	<u>R</u>	<u>S</u>	<u>T</u>	<u>U</u>	<u>V</u>	<u>W</u>	<u>X</u>	<u>Y</u>	<u>Z</u>
2027	<u>a</u>	<u>b</u>	<u>c</u>	<u>d</u>	<u>e</u>	<u>f</u>	<u>g</u>	<u>h</u>	<u>j</u>	<u>k</u>	<u>l</u>	<u>m</u>
2028	<u>n</u>	<u>p</u>	<u>q</u>	<u>r</u>	<u>s</u>	<u>t</u>	<u>u</u>	<u>v</u>	<u>w</u>	<u>x</u>	<u>y</u>	<u>z</u>

PCB Footprint:

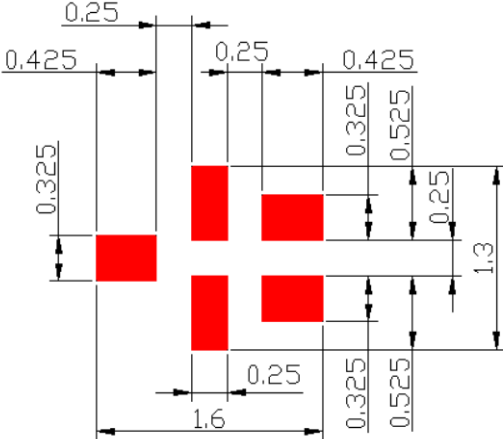

■ : Land Pattern
Unit : mm

**Frequency Characteristics:
S21_ span 500 MHz**

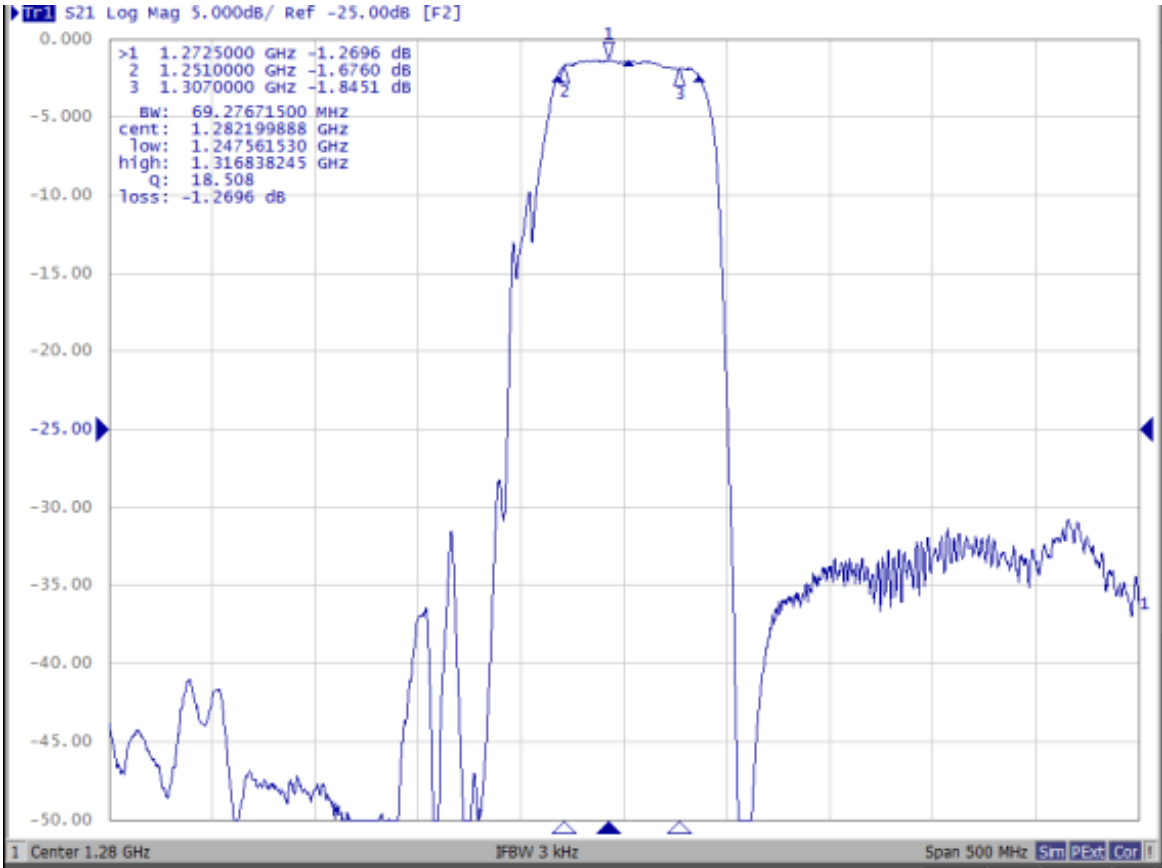

S21_span 200 MHz

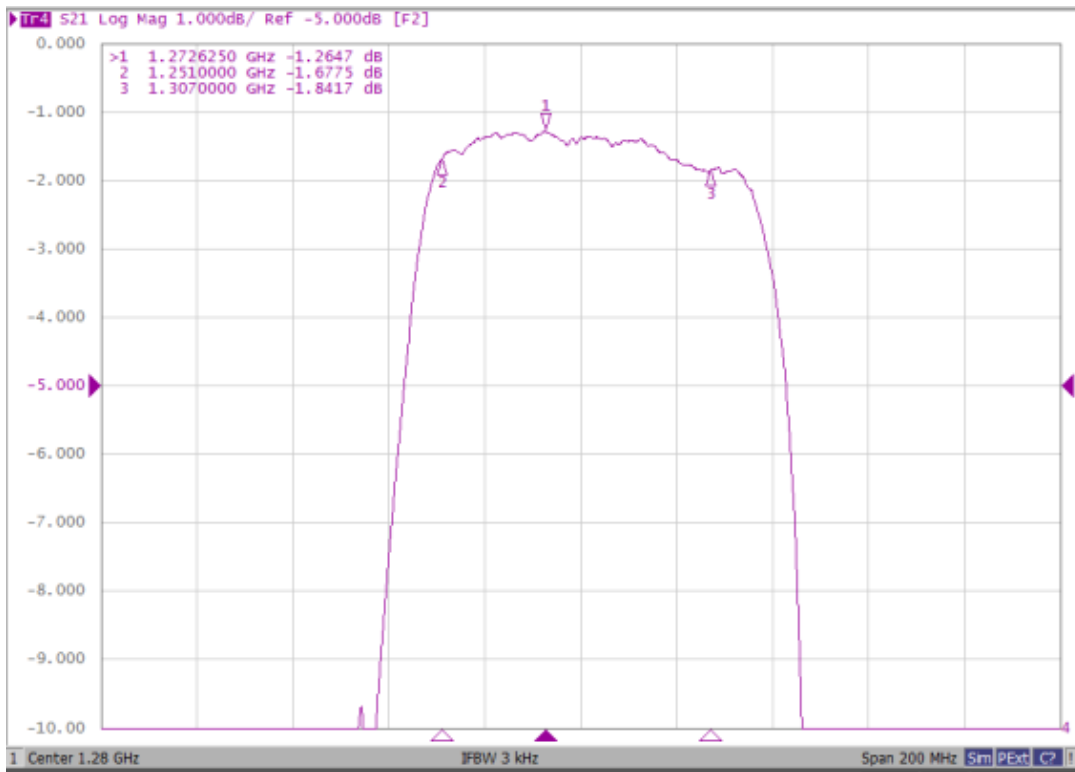

S21_span 8.5 GHz



S11/S22: span 500 MHz

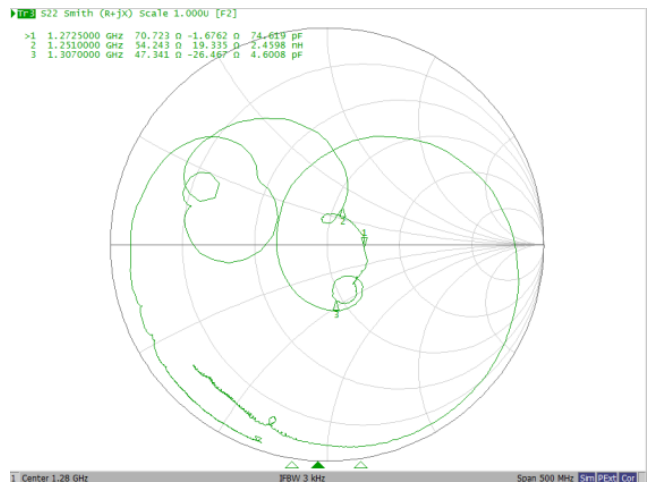
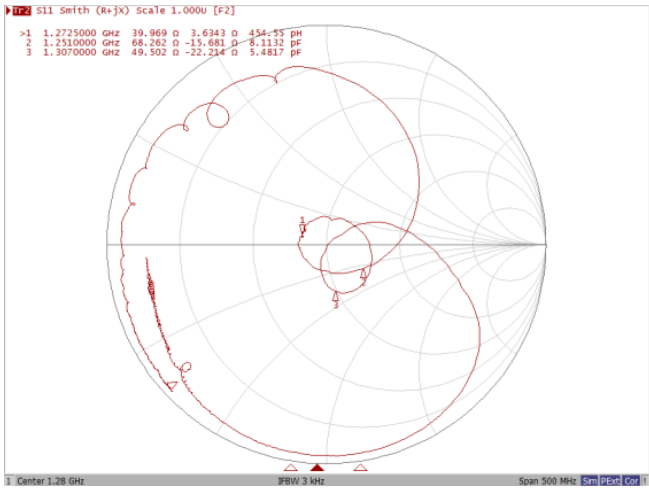

PACKING:

REEL DIMENSION

Reel QTY: 7" = 1000, 13" = 3000

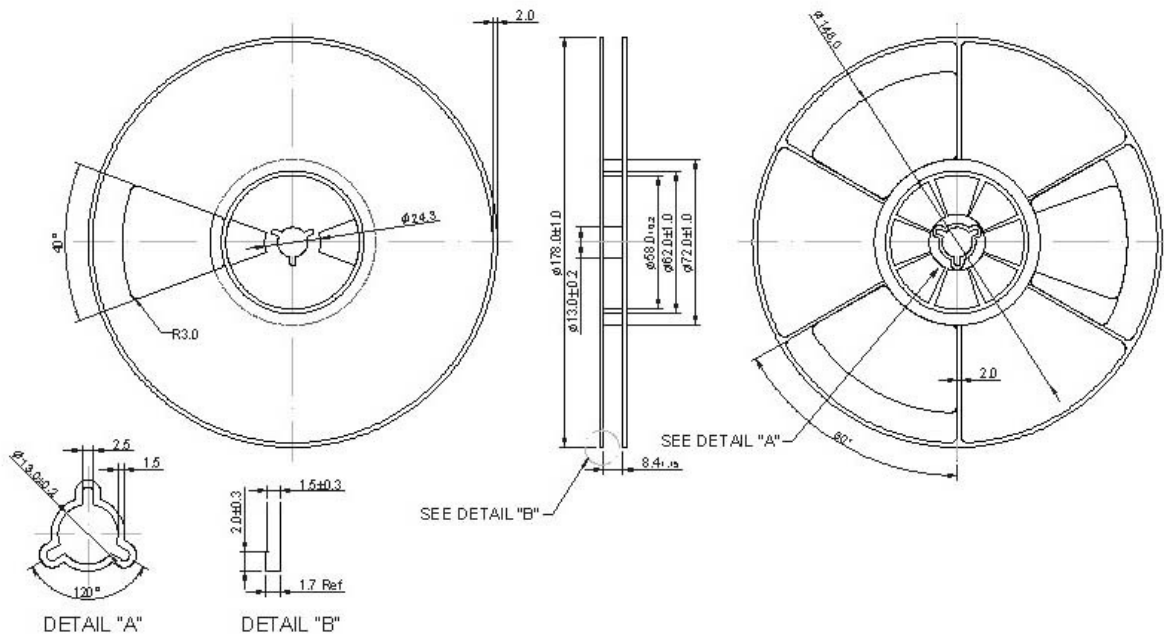

2. TAPE DIMENSION

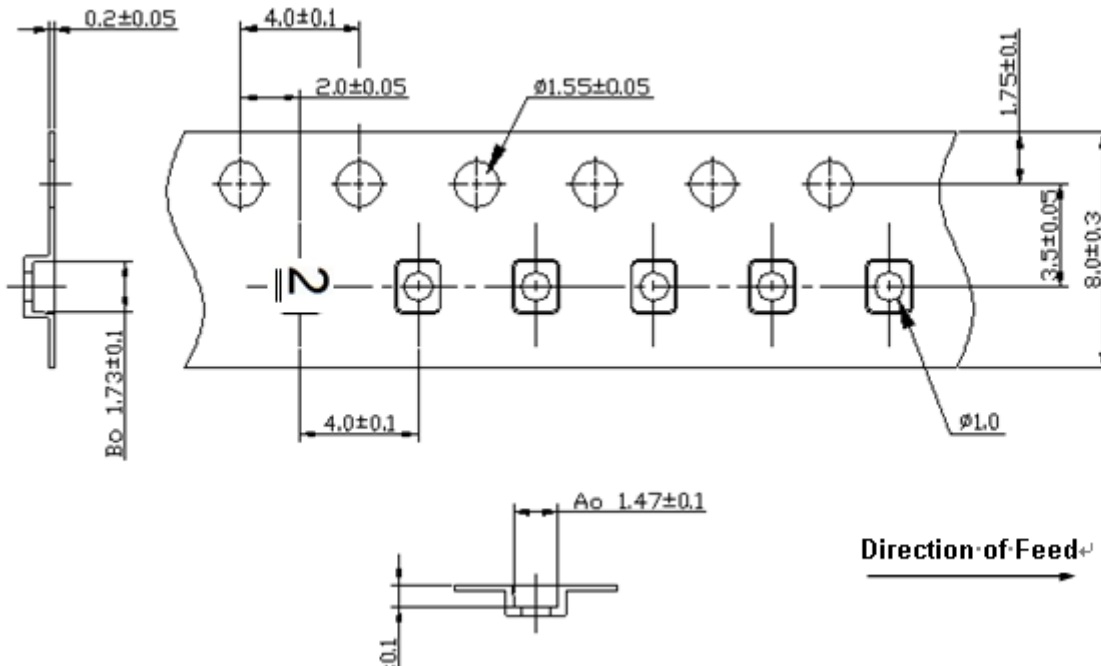

1. Preheating shall be fixed at $150 \sim 180^\circ\text{C}$ for 60~90 seconds.
2. Ascending time to preheating temperature 150°C shall be 30 seconds min.
3. Heating shall be fixed at 220°C for 50~80 seconds and at $260^\circ\text{C} \pm 0/-5^\circ\text{C}$ peak (20~40sec).
4. Time: 2 times.

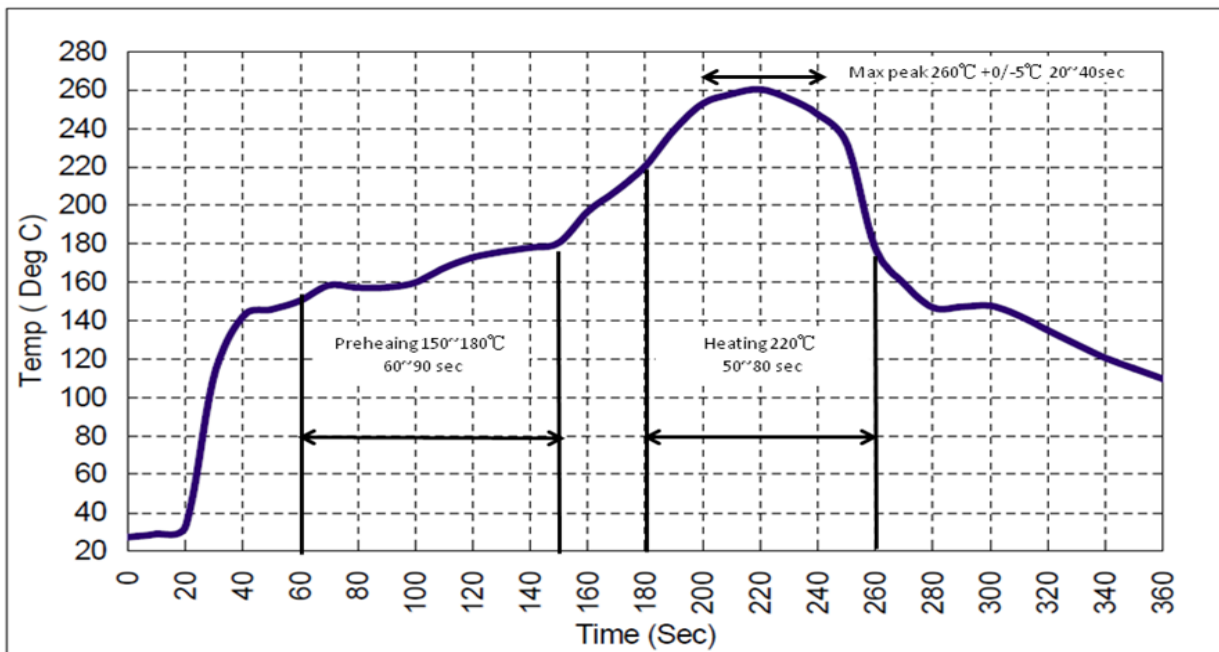

CAUTION: Electrostatic Sensitive Device. Observe precautions for handling.

NOTES:

1. The design, manufacturing process, and specifications of this device are subject to change.
2. US or International patents may apply.
3. RoHS compliant from the first date of manufacture.